

RECEIVED

STATE OF OKLAHOMA
DEPARTMENT OF HIGHWAYS
SURVEY DIVISION

Survey Division
Form No. 16
Rev. Sept. 10, 1961

SURVEY
DIVISION

FLOOD INFORMATION FORM

To be used in obtaining and transmitting flood water elevations for Survey Division office record files. This information to be obtained by all Chiefs of Party or others in their vicinity in times of unusual high water, or at any time available from a reliable source. The elevations can be recorded by level reading, by measurement from bridge floor, in relation to a house, above roadbed or any other dependable, clear manner that fits the situation, the highest order possible to be used. Separate report to be made on each crossing or place obtained.

County PAYNE Date highwater occurred 5-10-93

Highway number U.S. 177 Name of stream CIMARRON RIVER

Direction and distance from nearest town, village or store 1 MI. SOUTH OF PERKINS

Section, Township and Range SEC. 7, T17N-R3E

Description of Location BRIDGE OVER CIMARRON RIVER ON US 177

Elevation 843.7 838.2 Source of levels OND. STD. BR. MON. N^o P-60-30

Method obtained ENGR. LEVEL & ROD Date obtained 5-12-93

Did it appear to be normal medium extreme do not know

Was highwater mark obtained from actual water, drift, local resident, U. S. Engineers, etc.? DRIFT

Explanatory Remarks _____

ELEV. OBTAINED BY DIV. 4 EMPLOYEES

Location to be shown on back of this sheet as a check.

Field Note: To be sent to
Survey Engineer

Ronald O. Seim
Chief of Party

5-20-93
Date

Copy to Bridge 6-8-93

LOCATION No. 16

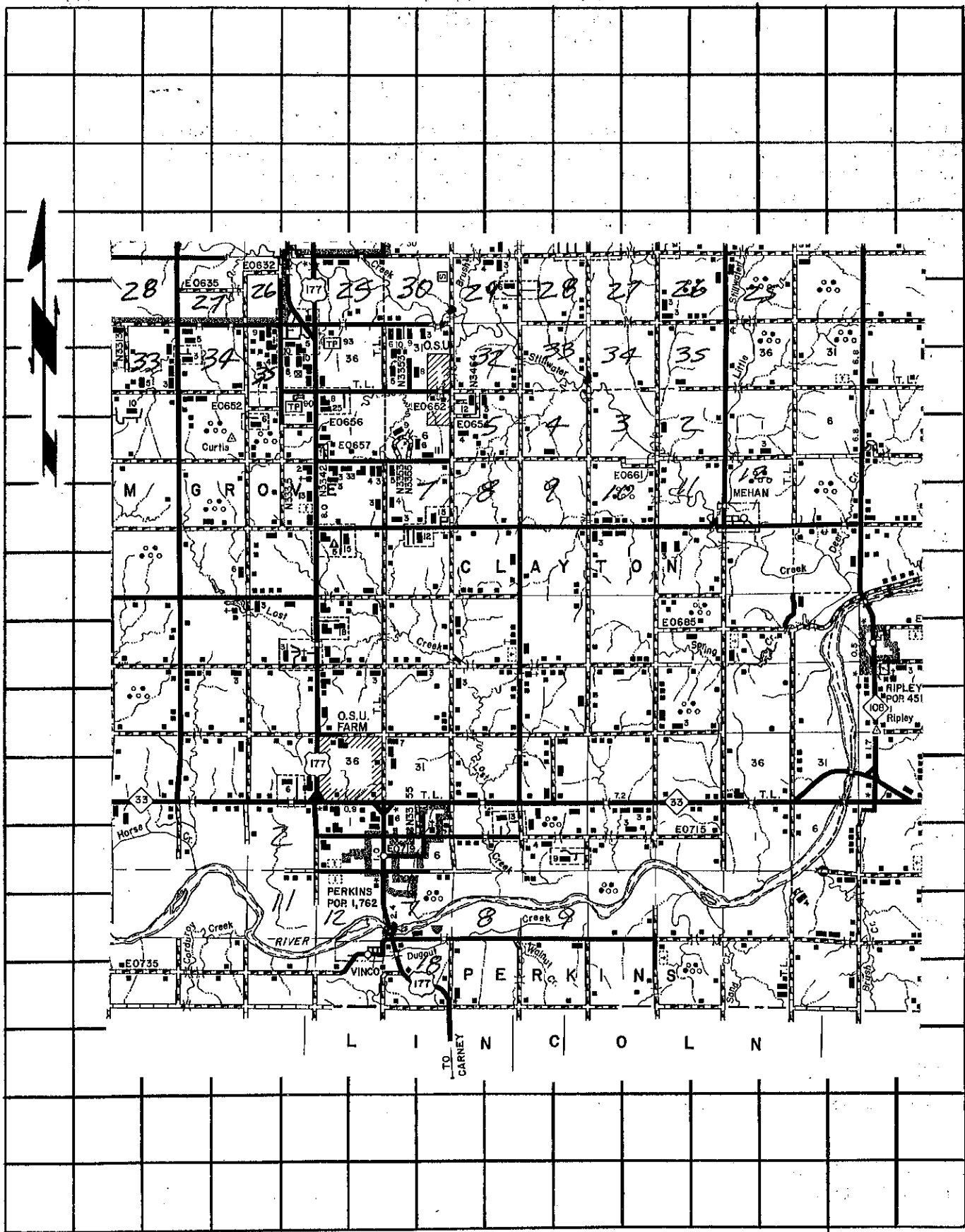

Map annotations and labels include:
Parcel numbers: 25, 26, 27, 28, 29, 30, 31, 32, 33, 34, 35, 36, 37
Farm names: O.S.U. FARM, PERKINS FARM, M.G.R.O., MEHAN
Town: RIPLEY
Roads: 177, 421
Water features: Little River, Horse Creek, Dugan Creek, Spring Creek, Lost Creek, T.L. Creek
Other labels: E0632, E0635, E0652, E0656, E0657, E0661, E0685, E0715, E0735, T.L., O.S.U., CURTIS, HORSE, PERKINS, RIPLEY, VINCO, DUGAN, WILSON, MEHAN, RIPLEY POR 451, RIPLEY, RIPLEY

L I N C O L N
TO CARNEY