

RECEIVED

JUN 7 1993

SURVEY DIVISION

STATE OF OKLAHOMA  
DEPARTMENT OF HIGHWAYS  
SURVEY DIVISION

Survey Division  
Form No. 16  
Rev. Sept. 10, 1961

FLOOD INFORMATION FORM

To be used in obtaining and transmitting flood water elevations for Survey Division office record files. This information to be obtained by all Chiefs of Party or others in their vicinity in times of unusual high water, or at any time available from a reliable source. The elevations can be recorded by level reading, by measurement from bridge floor, in relation to a house, above roadbed or any other dependable, clear manner that fits the situation, the highest order possible to be used. Separate report to be made on each crossing or place obtained.

County PAYNE Date highwater occurred 5-10-93

Highway number SH 33 / US. 177 Name of stream \_\_\_\_\_

Direction and distance from nearest town, village or store 3/4 MI. NORTH  
OF PERKINS

Section, Township and Range SEC. 31, T18N-R3E

Description of Location JCT. OF SH 33 / US. 177

Elevation 904.2 Source of levels ODOT. BR. MAN.

Method obtained ENGR. LEVEL / ROD Date obtained 5-12-93

Did it appear to be  normal  medium  extreme  do not know

Was highwater mark obtained from actual water, drift, local resident, U. S. Engineers, etc.? DRIFT

Explanatory Remarks NOT ON A CREEK. JCT. FLOODS DURING  
HEAVEY RAINS. OBTAINED BY DIV. 4 EMPLOYEES

Location to be shown on back of this sheet as a check.

Field Note: To be sent to  
Survey Engineer

Ronald R. Lewis  
Chief of Party

5-26-93  
Date

Copy to Bridge 6-8-93

LOCATION No. 40

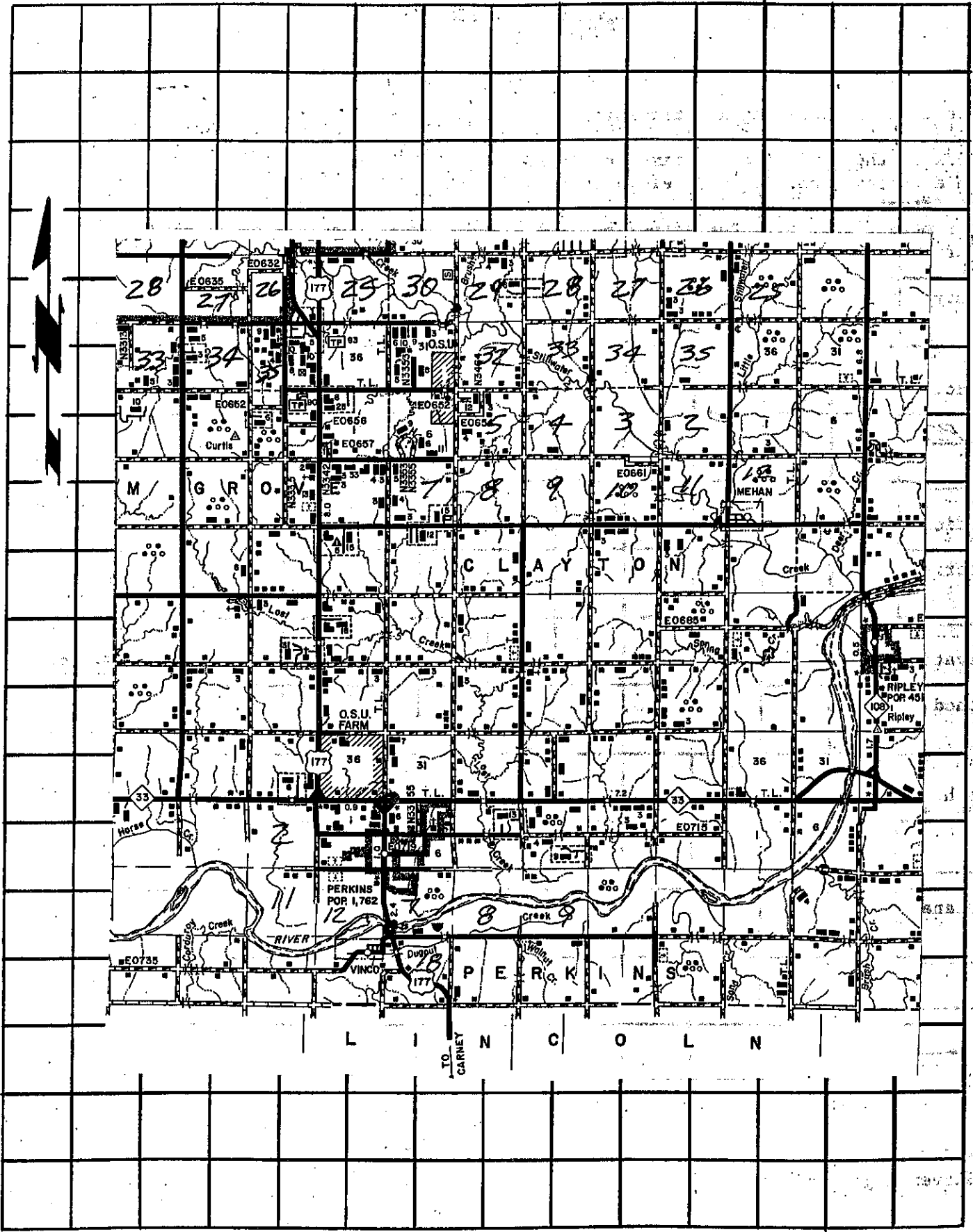

28

27

26

25

30

29

28

27

26

25

33

34

35

36

37

38

39

34

35

36

31

M

G

R

O

C

L

A

T

O

N

33

38

31

36

31

36

31

36

31

E0735

PERKINS FOR 1,762

VINCO

177

PERKIN

S

177

PERKIN

S

177

PERKIN

S

L I N C O L N

TO GARNET

