



OKLAHOMA DEPARTMENT OF TRANSPORTATION
SURVEY DIVISION

FLOOD INFORMATION FORM

Division #:	1 <input type="checkbox"/> 2 <input type="checkbox"/> 3 <input type="checkbox"/> 4 X 5 <input type="checkbox"/> 6 <input type="checkbox"/> 7 <input type="checkbox"/> 8 <input type="checkbox"/>
County:	Payne
Date Highwater occurred:	07/01/2007
Highway Number:	S.H.-33 and U.S.-177 south
Name of Stream:	Unnamed
Direction and distance from nearest town, or highway junction	From Perkins go north 1 mile
Section, Township, Range:	SEC 36 &1, T-17-N R-2-E/ SEC 31 &6, T-18-N R-2-E
Description of Location:	Intersection of S.H.33 and U.S. 177
Highwater Elevation:	905.82
Level Datum & Source:	NAVD 88 Target # 74 established during SWO4157(1)
Method used:	Digital Level
Date Elevation Obtained:	07/09/2007
Apparent Magnitude:	Normal <input type="checkbox"/> Medium <input type="checkbox"/> Extreme X Don't Know <input type="checkbox"/>
Was Highwater Mark obtained from actual water, drift, local resident, or other source?	Obtained from O.D.O.T. employee water covering intersection
Explanatory Remarks:	After many days of rain

Note: Show Vicinity Map on back of form

Name (signature) *Ronald D. Seim*
Name (Printed) Ronald D. Seim
Date: 7-24-07

Survey Division
Form No. 16
Revised: 5/09/2007

LOCATION No. 40

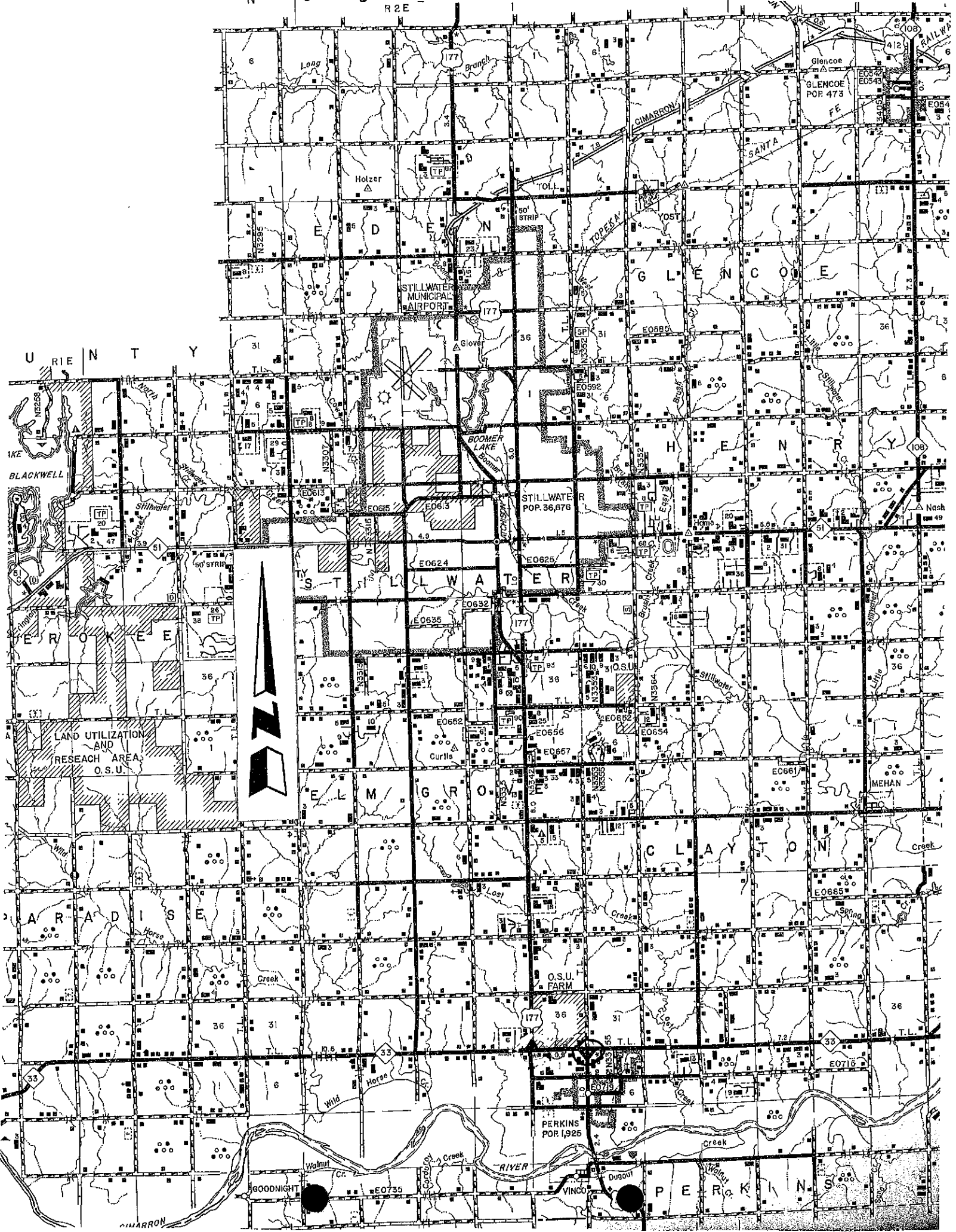

R 2E

Glencoe
POP 473

STILLWATER
MUNICIPAL
AIRPORT

STILLWATER
POP. 36,876

O.S.U.
FARM

PERKINS
POP. 1,925

U R I E N T Y

S T I L L W A T E R

E L M G R O V E

C L A Y T O N

E R O K E E

P A R A D I S E

P E R K I N S

LAND UTILIZATION
AND
RESEARCH AREA
O.S.U.



BLACKWELL
Stillwater
60' STRIP
Wild Horse
Creek
Walmart Cr.
GOODNIGHT

Boomer Lake
Curlls
Wild Horse
Creek
Cottonwood
Creek
RIVER

Glencoe
HENRY
MEHAN
Spring
Creek
Dugout
VINCO

RAILWAY
A12
E054
3

Nash
49

MEHAN

E0718

PERKINS