

STATE OF OKLAHOMA
DEPARTMENT OF HIGHWAYS
PLANS AND SURVEY DEPARTMENT

FLOOD INFORMATION FORM

To be used in obtaining and transmitting flood water elevations for Plans & Survey office record files. This information to be obtained by all Chiefs of Party in their vicinity in times of unusual high water, or at any time available from a reliable source. The elevations can be recorded by level reading, by measurement from bridge floor, in relation to a house, above roadbed or any other dependable, clear manner that fits the situation, the highest order possible to be used. Separate report to be made on each crossing or place obtained.

County Ottawa Date highwater occurred July 16, 1951

Highway number U.S. 60 Name of stream Spring River

Direction and distance from nearest town, village or store 6 Mile NE of Fairbairn

Section, Township and Range Sec 20-T2N-R24E

Description of Location At East End of Spring River Br.

Actual level of Water at 3:55 PM July 17-51 Was Elev = 957.0

Method obtained Hand Level

Elevation 957.6 ^{Max H.W. from 2:40 PM July 16, 1951} Source of levels U.S.C. & G.S.

Was highwater mark obtained from actual water, drift, local resident, U. S. Engineers, etc?

Explanatory Remarks This was obtained by A.B. Stephens & Gaisas Stout in Company with Joe Tercy and R.B. Winfrey

Location to be shown on back of this sheet as a check.

Field Note: To be sent to Engr. of Plans & Survey (1 copy).
Office Note: To be filed in Flood Information by Counties.

A.B. Stephens
Chief of Party
RES ENR.
July 17, 1951.
Date

See H.S. checked Map for Location

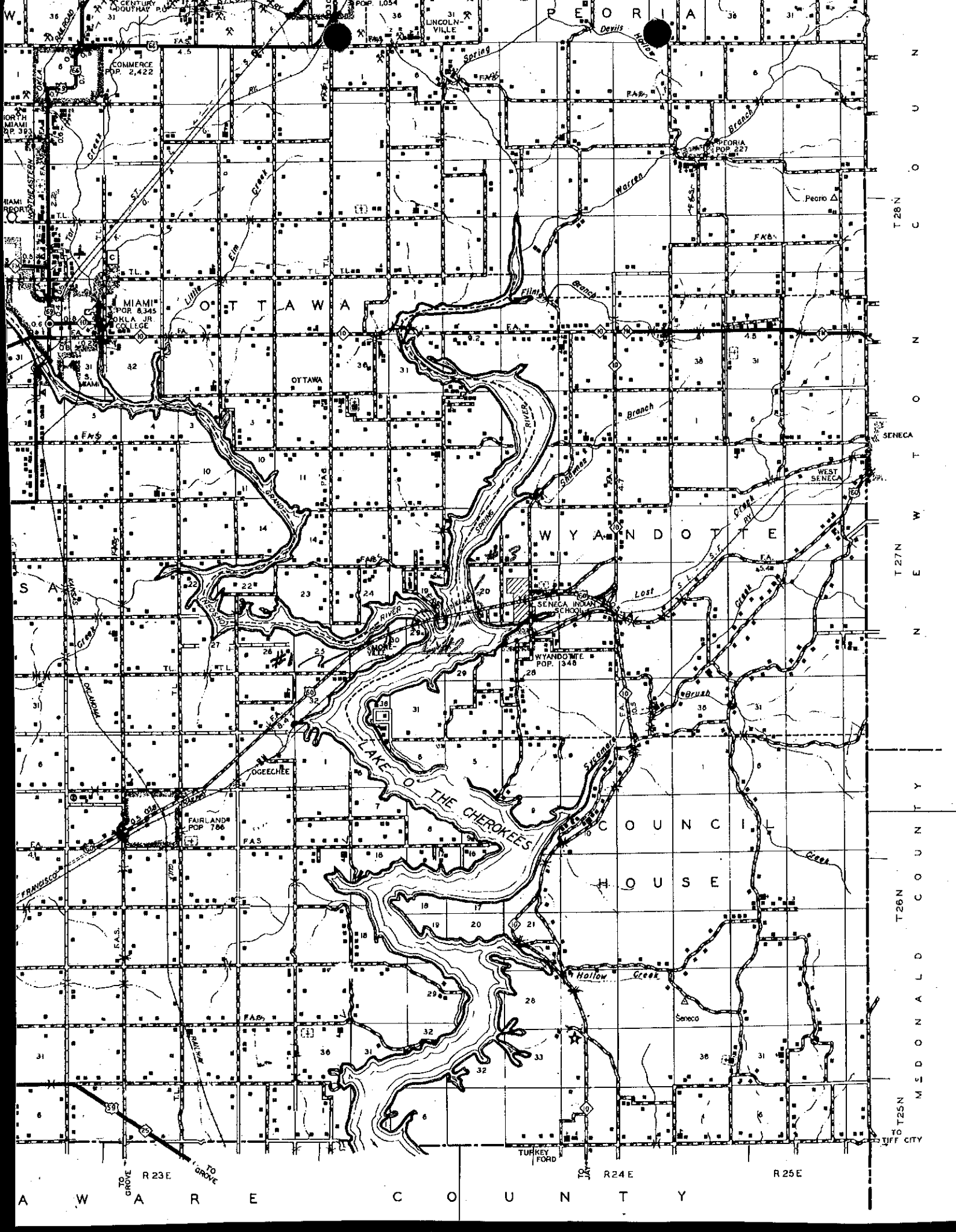

W A R E C O U N T Y

T 28 N
T 27 N
T 26 N

M E D O N A L D C O U N T Y

S E N E C A

W E S T S E N E C A

TO T25N
TO T26N
TO T27N
TO T28N

T I F F C I T Y

R 23 E R 24 E R 25 E

TO GROVE
TO GROVE

TURKEY FORD