

STATE OF OKLAHOMA  
DEPARTMENT OF HIGHWAYS  
PLANS AND SURVEY DEPARTMENT

FLOOD INFORMATION FORM

To be used in obtaining and transmitting flood water elevations for Plans & Survey office record files. This information to be obtained by all Chiefs of Party in their vicinity in times of unusual high water, or at any time available from a reliable source. The elevations can be recorded by level reading, by measurement from bridge floor, in relation to a house, above roadbed or any other dependable, clear manner that fits the situation, the highest order possible to be used. Separate report to be made on each crossing or place obtained.

County Ottawa Date highwater occurred July 16, 1951 *From 2:40 P.M.*

Highway number U.S. 60 Name of stream Nesbo River

Direction and distance from nearest town, village or store 3 1/2 Miles NE of Fairbaird on U.S. 60

Section, Township and Range Sec <sup>19</sup> 20 T2N-R2E

Description of Location North of Sta 350+00.85 FAP486 - At East End of Bridge on North Side

Method obtained Hand Level

Elevation 757.41 Source of levels U.S. & G.S.

Was highwater mark obtained from actual water, drift, local resident, U. S. Engineers, etc? Water Mark - Taken by Gaines Stout

Explanatory Remarks Actual Water Level at West End of Br. on North Side actual Water Level is 757.0. at 3:45 P.M. July 17, 1951.

Water Level in Center of Br. Water was 0.5 Lower on South Side of Br. Than North. Obtained by A.P. Stephens & Gaines Stout, in Company with Joe Terry and R.B. Winfrey  
Location to be shown on back of this sheet as a check.

Field Note: To be sent to Engr. of Plans & Survey (1 copy).  
Office Note: To be filed in Flood Information by Counties.

A.P. Stephens  
Chief of Party  
RES Eng  
July 17, 1951.  
Date

SEE NO 2 attached Map for Location

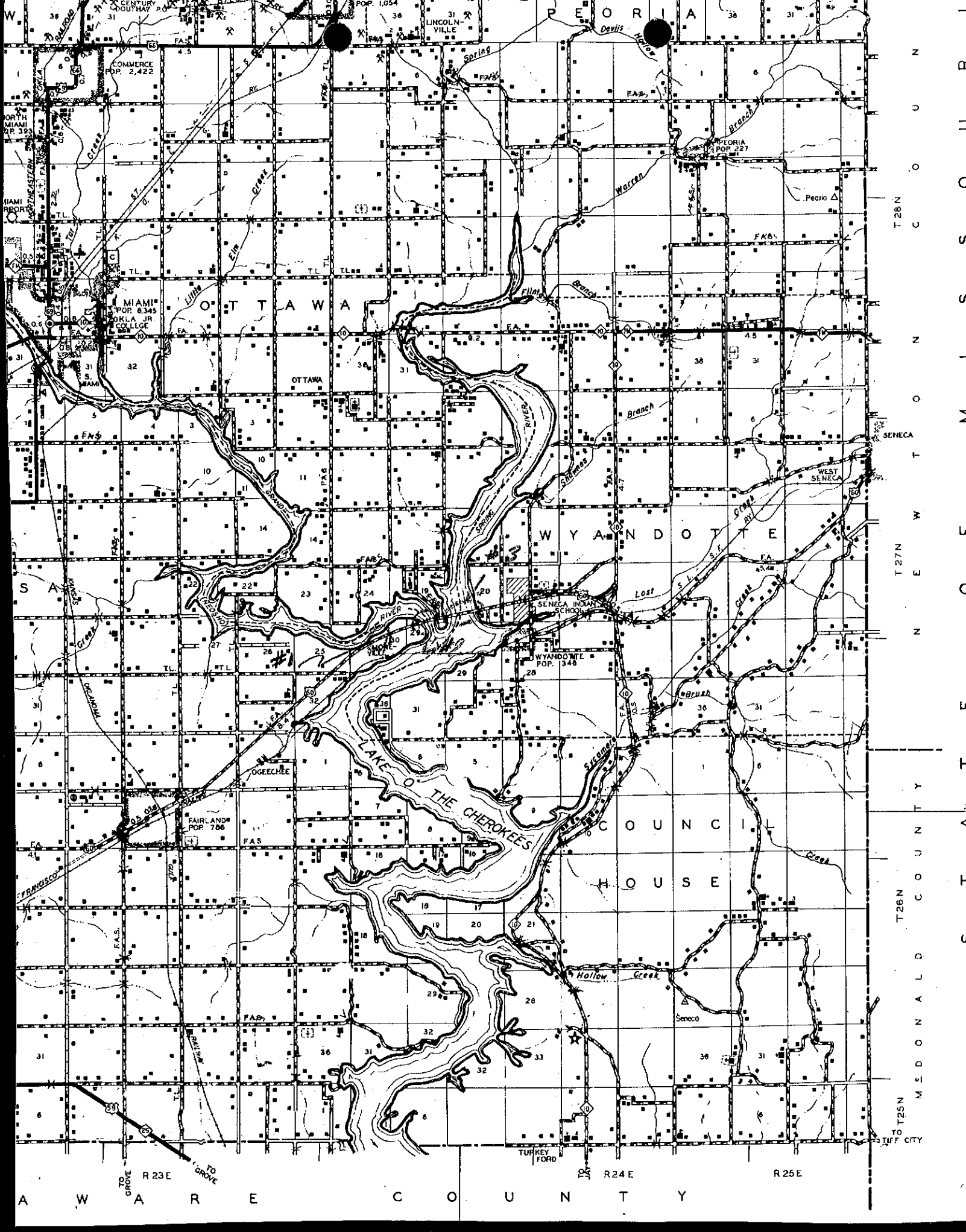

PEORIA  
MIAMI  
OTTAWA  
WYANDOTTE  
COUNCIL BLUFFS  
LAKE OF THE CHEROKEES  
SARASOTA  
FRANCISCO  
FAIRLAND  
OGEECHEE  
TURKEY FORD

COMMERCIAL POP. 2,422  
MIAMI POP. 8,345  
OTTAWA  
WYANDOTTE POP. 1,348  
COUNCIL BLUFFS

TO GROVE R 23E  
TO GROVE  
TURKEY FORD  
R 24E  
R 25E

T 26N  
T 27N  
T 28N

W  
I  
S  
A  
S  
S  
O  
U  
R  
I  
C  
O  
U  
N  
T  
Y  
M  
I  
D  
D  
L  
E  
T  
E  
N  
N  
E  
S  
S  
E  
E  
S  
T  
A  
T  
E