

STATE OF OKLAHOMA
DEPARTMENT OF HIGHWAYS
SURVEY DIVISION

Survey Division
Form No. 16
Rev. Sept. 10, 1961

FLOOD INFORMATION FORM

To be used in obtaining and transmitting flood water elevations for Survey Division office record files. This information to be obtained by all Chiefs of Party or others in their vicinity in times of unusual high water, or at any time available from a reliable source. The elevations can be recorded by level reading, by measurement from bridge floor, in relation to a house, above roadbed or any other dependable, clear manner that fits the situation, the highest order possible to be used. Separate report to be made on each crossing or place obtained.

County OSAGE Date highwater occurred OCT 13, 1973

Highway number SH 18 Name of stream SALT CREEK

Direction and distance from nearest town, village or store 2 MI. N.E. OF RALSTON

Section, Township and Range SEC. 25, T 24 N, R 5 E

Description of Location N. END OF CREEK BRIDGE
6' BELOW BRIDGE FLOOR

Elevation _____ Source of levels _____

Method obtained STEEL TAPE Date obtained OCT 16, 1973

Did it appear to be normal medium extreme do not know

Was highwater mark obtained from actual water, drift, local resident, U. S. Engineers, etc.? WATER MARK ON BRIDGE ABUTMENT

Explanatory Remarks BACKWATER FROM ARKANSAS RIVER

Location to be shown on back of this sheet as a check.

Field Note: To be sent to
Survey Engineer
M.C. BRIDGE DIV.

Jeremy E. Sigginbatham
Chief of Party
OCT 25, 1973
Date

Location No. 4

R 5 E

R 6 E.

OSAGE COUNTY

PHUNEE COUNTY

RALSTON

M.W. CHECK POINT

ADAMS'S

SH 15

SH 19

SH 18

SH 20

RIVER

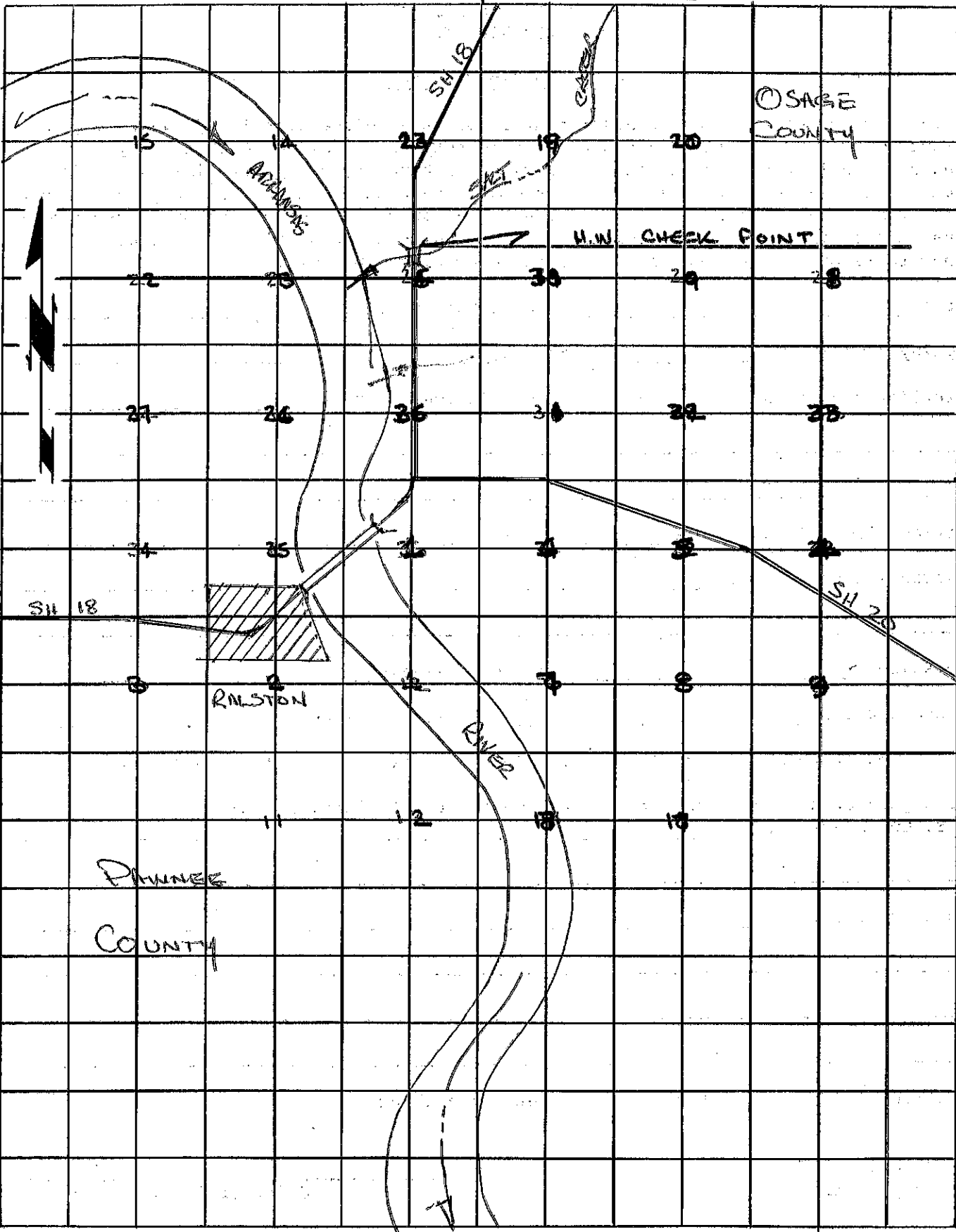

T 24 N

T 23 N

T 24

T 23