

STATE OF OKLAHOMA
DEPARTMENT OF HIGHWAYS
SURVEY DIVISION

RECEIVED
Survey Division
Form No. 16
Rev. Sept. 10, 1961
MAR 20 1974
SURVEY DIVISION

FLOOD INFORMATION FORM

To be used in obtaining and transmitting flood water elevations for Survey Division office record files. This information to be obtained by all Chiefs of Party or others in their vicinity in times of unusual high water, or at any time available from a reliable source. The elevations can be recorded by level reading, by measurement from bridge floor, in relation to a house, above roadbed or any other dependable, clear manner that fits the situation, the highest order possible to be used. Separate report to be made on each crossing or place obtained.

County Osage Date highwater occurred March 12, 1974

Highway number SH 20 Name of stream Hominy Creek

Direction and distance from nearest town, village or store Approximately six miles west of Skiatook on SH 20.

Section, Township and Range Section 27, T-21-N, R-11-E

Description of Location At present SH 20 concrete bridge over Hominy Creek.

Elevation _____ Source of levels _____
H.W. Elev. = 10.8 Ft. below C.L. Conc. RDY Bridge, West end bridge.
Method obtained Measured down Date obtained March 14, 1974

Did it appear to be normal medium extreme do not know

Was highwater mark obtained from actual water, drift, local resident, U. S. Engineers, etc.? Silt and drifts after water receded.

Explanatory Remarks The Pawhuska area received an approx. 9 inch rain, and the Skiatook area received a 4 inch rain the week end of March 9th & 10th, 74.

Location to be shown on back of this sheet as a check.

Field Note: To be sent to
Survey Engineer

Rees Day Morgan
Location Engineer
March 18, 1974
Date

Loc. No. 5

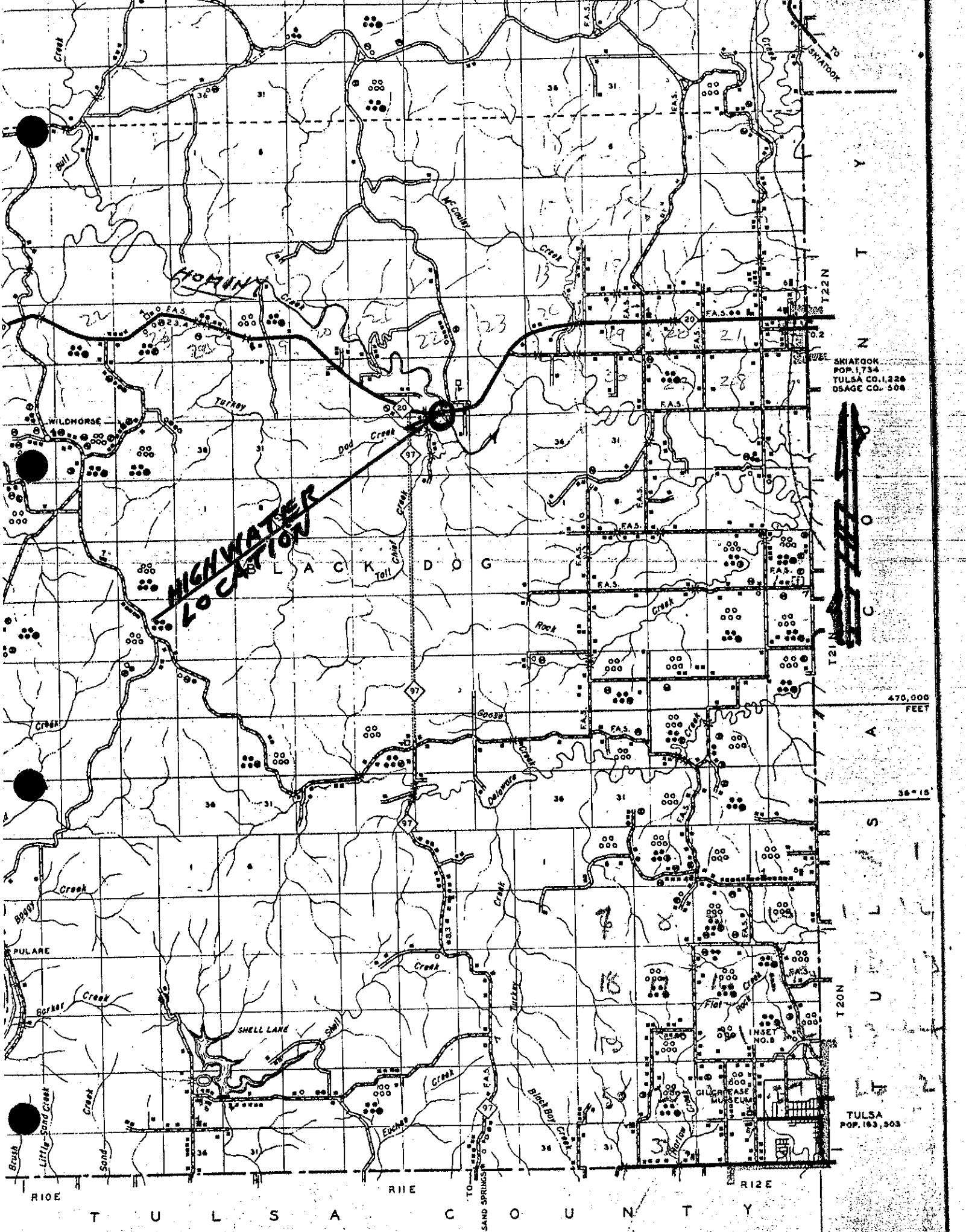

**HIGHWAY
LOCATION**

SKIATOOK
POP. 1,734
TULSA CO. 1,226
OSAGE CO. 508

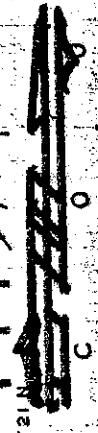

470,000
FEET

36° 15'

T20N

T21N

T22N

R10E R11E R12E

TULSA
POP. 163,503

T U L S A C O U N T Y

1:50,000