

RECEIVED
JAN 2 1980
SURVEY DIVISION

STATE OF OKLAHOMA
DEPARTMENT OF HIGHWAYS
SURVEY DIVISION

Survey Division
Form No. 16
Rev. Sept. 10, 1961

FLOOD INFORMATION FORM

To be used in obtaining and transmitting flood water elevations for Survey Division office record files. This information to be obtained by all Chiefs of Party or others in their vicinity in times of unusual high water, or at any time available from a reliable source. The elevations can be recorded by level reading, by measurement from bridge floor, in relation to a house, above roadbed or any other dependable, clear manner that fits the situation, the highest order possible to be used. Separate report to be made on each crossing or place obtained.

County OSAGE Date highwater occurred NOV. 21, 1979

Highway number S. H. 18 Name of stream SALT CREEK

Direction and distance from nearest town, village or store 2.5 MI. SOUTH OF SHIDLER, OKLA.

Section, Township and Range SEC. 10 T-26-N R-6-E

Description of Location 0.5 ft. Above Bridge Floor at South End Of Bridge.

Old S. H. 18 Bridge. about 1000 ft. upstream from ~~Old~~ Bridge.

Elevation 0.5 above Br. floor Source of levels _____

Method obtained Cloth Tape & Hand Level Date obtained Dec. 3, 1979

Did it appear to be normal medium extreme do not know

Was highwater mark obtained from actual water, drift, local resident, U. S. Engineers, etc.? Drift

Explanatory Remarks 12" Rain in Watershed

Location to be shown on back of this sheet as a check.

Field Note: To be sent to
Survey Engineer

L E Higginbotham
Chief of Party

Dec. 10, 1979
Date

Location No. 10

R 6 W

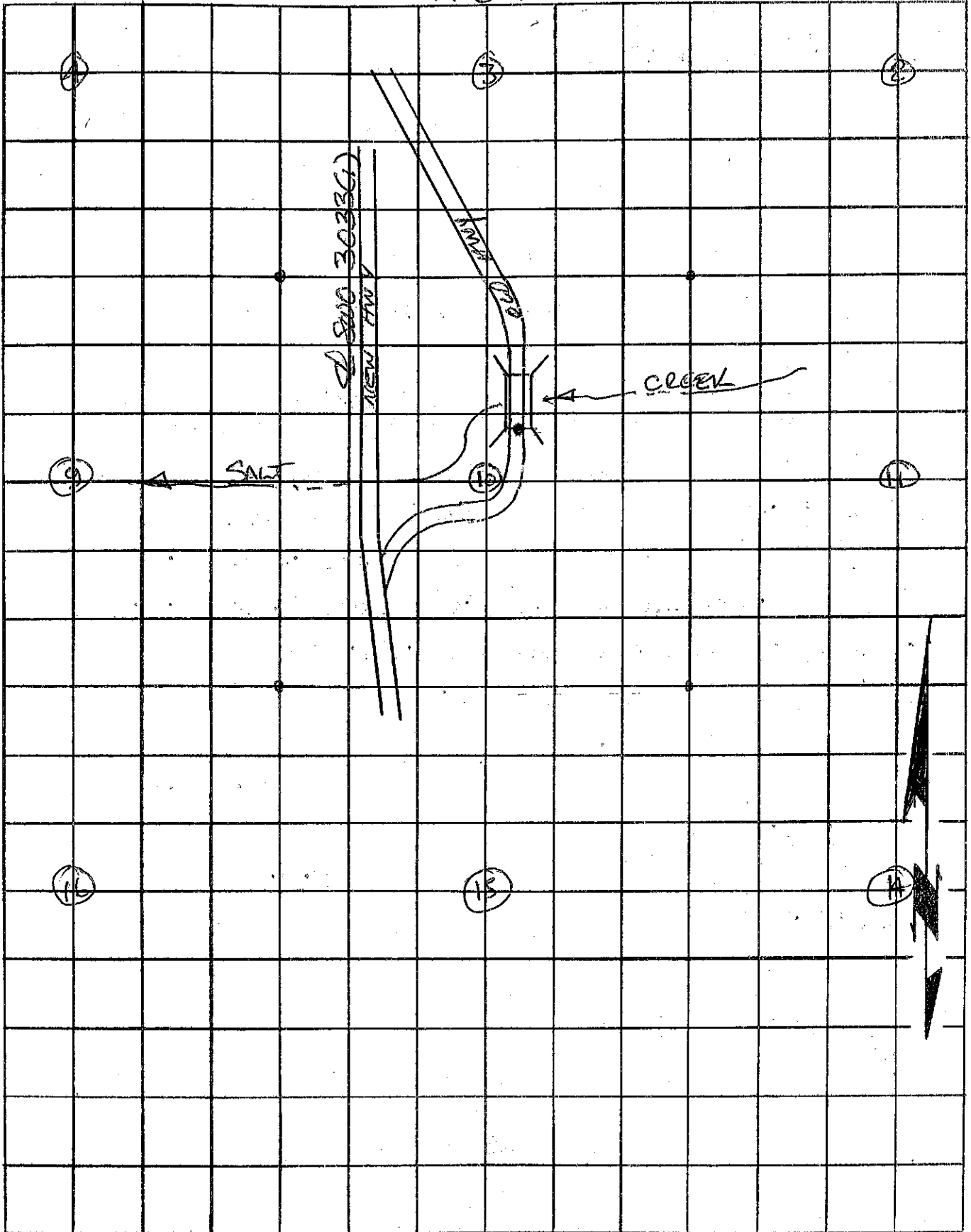

T 26 N