

RECEIVED
OCT 29 1971
SURVEY DIVISION

Survey Division
Form No. 16
Rev. Sept. 10, 1961

STATE OF OKLAHOMA
DEPARTMENT OF HIGHWAYS
SURVEY DIVISION

FLOOD INFORMATION FORM

To be used in obtaining and transmitting flood water elevations for Survey Division office record files. This information to be obtained by all Chiefs of Party or others in their vicinity in times of unusual high water, or at any time available from a reliable source. The elevations can be recorded by level reading, by measurement from bridge floor, in relation to a house, above roadbed or any other dependable, clear manner that fits the situation, the highest order possible to be used. Separate report to be made on each crossing or place obtained.

County Tulsa Date highwater occurred Sept 5, 1971

Highway number US 75 Bee Line Name of stream Coal Creek

Direction and distance from nearest town, village or store Jct SH 67 & US 75 at Northwest edge of Glenpool Okla.

Section, Township and Range Between Sec. 11-14 T-17-N R-12-E

Description of Location 150' east Jct. SH 67 & US 75 Bee Line

Elevation _____ Source of levels _____

Method obtained Survey Party Y-Level Date obtained Sept 7, 1971

Did it appear to be normal medium extreme do not know

Was highwater mark obtained from actual water, drift, local resident, U. S. Engineers, etc.? Drift up 2.2' from N.W. wingwall of Coal Creek bridge across SH 67

Explanatory Remarks Water approximately 1.0' over Bee Line

Location to be shown on back of this sheet as a check.

Field Note: To be sent to
Survey Engineer

Lucy E. Sigmon
Chief of Party

Sept 7, 1971
Date

LOCATION NO. 2

R-12-E

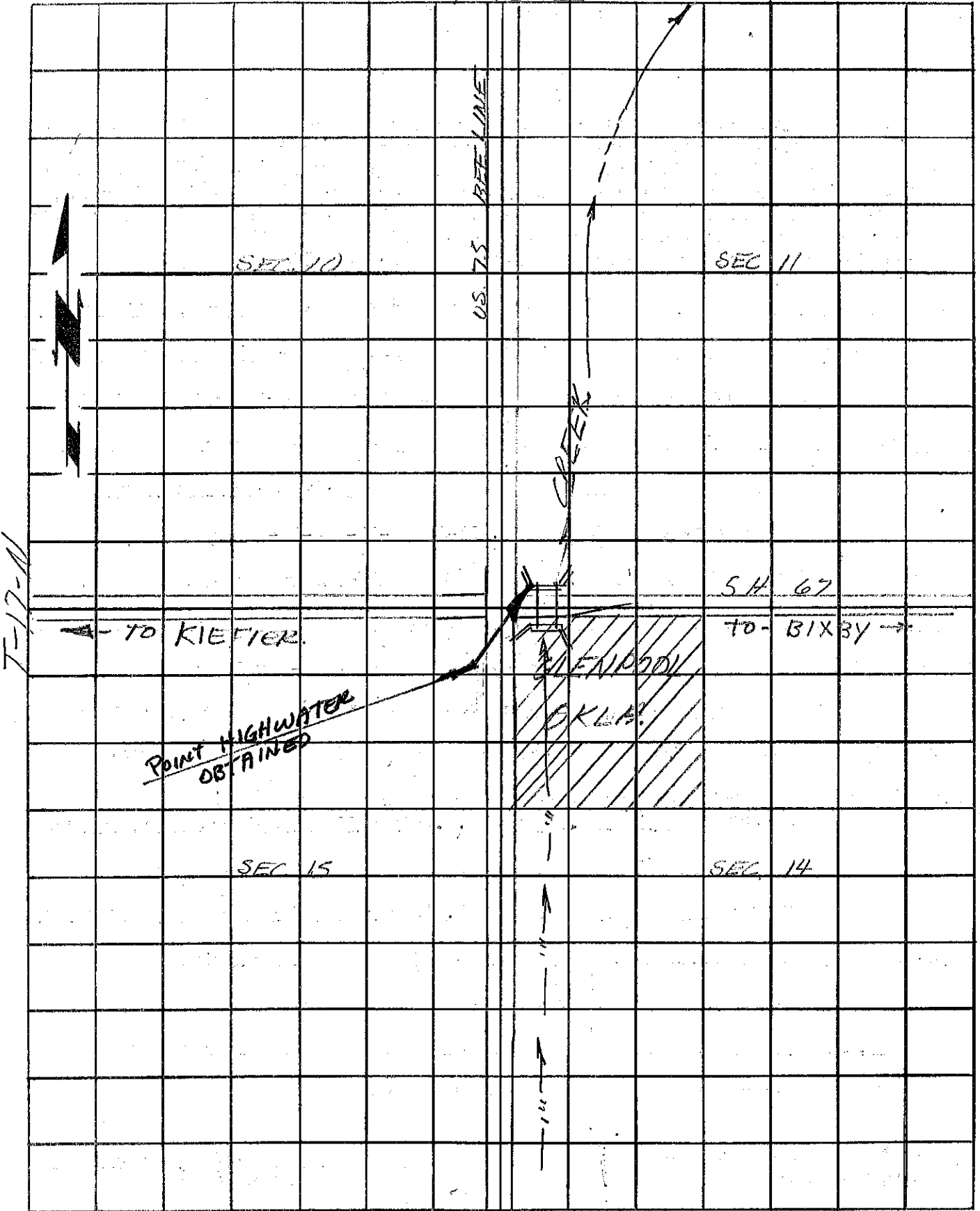

T-17-N

T-17-N

R-12-E