

RECEIVED  
OCT 29 1971  
SURVEY DIVISION

Survey Division  
Form No. 16  
Rev. Sept. 10, 1961

STATE OF OKLAHOMA  
DEPARTMENT OF HIGHWAYS  
SURVEY DIVISION

FLOOD INFORMATION FORM

To be used in obtaining and transmitting flood water elevations for Survey Division office record files. This information to be obtained by all Chiefs of Party or others in their vicinity in times of unusual high water, or at any time available from a reliable source. The elevations can be recorded by level reading, by measurement from bridge floor, in relation to a house, above roadbed or any other dependable, clear manner that fits the situation, the highest order possible to be used. Separate report to be made on each crossing or place obtained.

County Tulsa Date highwater occurred Sept. 4 & 5, 1971

Highway number US 75 Bee Line Name of stream Nickel Creek

Direction and distance from nearest town, village or store Approximately 1000' south Jct. Jenks Road & US 75 Bee Line.

Section, Township and Range Between Section 22- & 25 T18N R12E

Description of Location South lane of traffic on access to Bee Line

Elevation \_\_\_\_\_ Source of levels \_\_\_\_\_

Method obtained Survey Party Y-Level Date obtained Sept 7, 1971

Did it appear to be  normal  medium  extreme  do not know

Was highwater mark obtained from actual water, drift, local resident, U. S. Engineers, etc.? Drift Down 6.5' from N.W. Wingwall of Access Road south bound traffic.

Explanatory Remarks 4 1/8" rain Saturday, 4 3/4" Sunday Sept. 4 & 5 1971.

Location to be shown on back of this sheet as a check.

Field Note: To be sent to  
Survey Engineer

Perry E. Shigzbach  
Chief of Party

Sept. 7, 1971  
Date

Location No. 4

R-12-E

TULSA

COUNTY

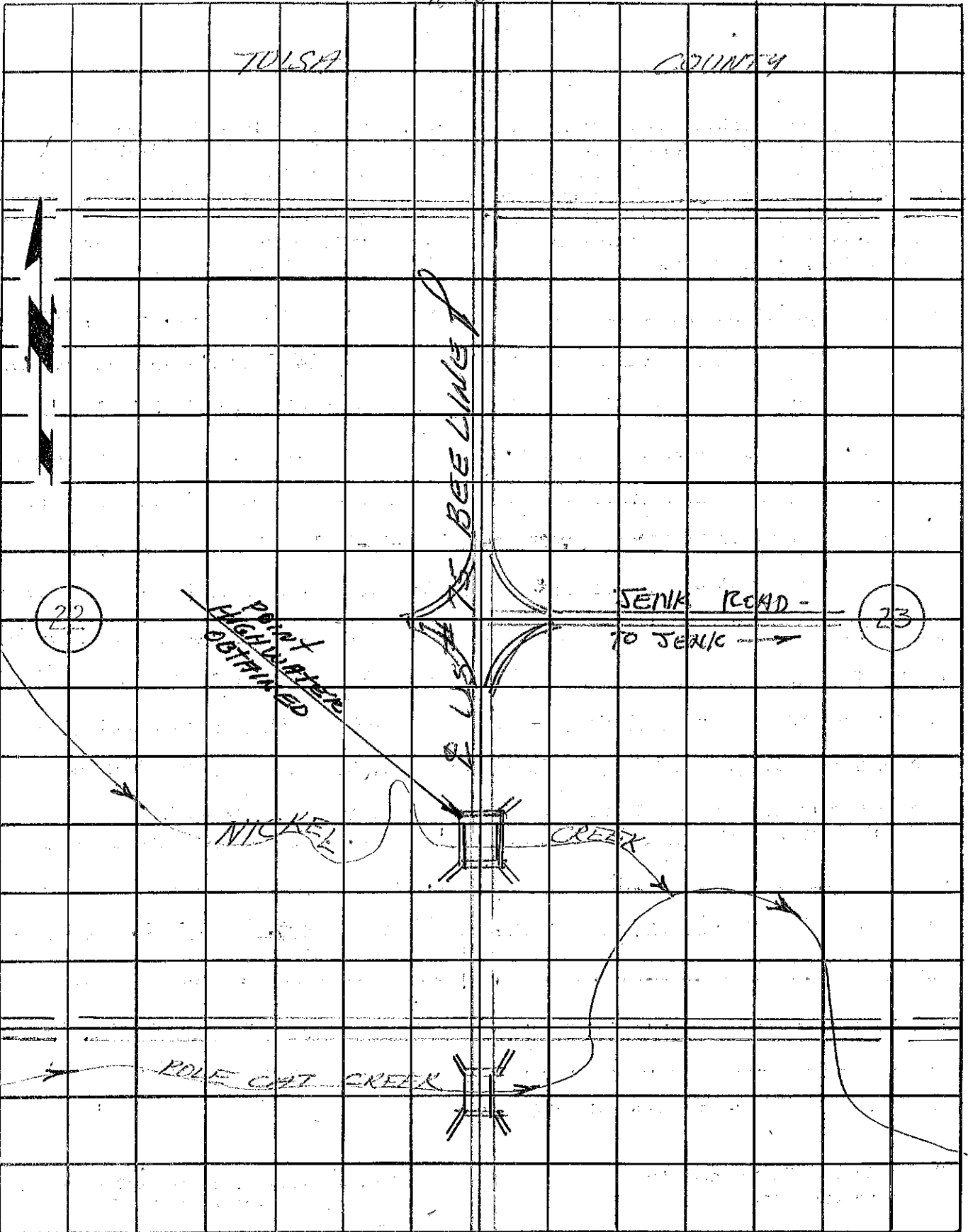

T-18-N

T-18-N

R-12-E