

STATE OF OKLAHOMA
DEPARTMENT OF HIGHWAYS
PLANS AND SURVEY DEPARTMENT

FLOOD INFORMATION FORM

Plans & Survey Dept.
Form No. 16
Rev. July 10, 1947
MAY 22 1961
SURVEY DIVISION

To be used in obtaining and transmitting flood water elevations for Plans & Survey office record files. This information to be obtained by all Chiefs of Party in their vicinity in times of unusual high water, or at any time available from a reliable source. The elevations can be recorded by level reading, by measurement from bridge floor, in relation to a house, above roadbed or any other dependable, clear manner that fits the situation, the highest order possible to be used. Separate report to be made on each crossing or place obtained.

County Tulsa Date highwater occurred May 9, 1961 (Location)
US 75 (New Location)
Highway number (Now under construction) of stream Bird Creek
Direction and distance from nearest town, village or store Approximately 1/2 Mile East and One and 3/4 mile south of Owasso on New location of US 75 made under SWO 2109 (1). (Now under construction)

Section, Township and Range Section 5, T-20-N, R-14-E
Description of Location On US 75 New location approx. 1/2 mile east and 1 3/4 mile South of Owasso.

Method obtained Measured down from floor of bridge with metallic tape.
Elevation 14.5 Ft. below EM. EN 584.6 USCEG EM = Centerline Bird Creek Conc.
Source of levels Bridge Floor, South End (Described on back of this sheet)

Was highwater mark obtained from actual water, drift, local resident, U. S. Engineers, etc? Actual Water Level by this party.
Personnel: R. D. Moran, Jr., Chief of Party & C. J. Riley, Rodman.

Explanatory Remarks On May 9, 1961 the water elevation rose to 16.5 Ft. below bridge floor. On May 11, 1961 the water rose to 14.5 below bridge floor after the coffer dam at the Oologah Dam Site gave way on May 10, 1961. - The road bed on this new location of US 75 was not under water.

Location to be shown on back of this sheet as a check.

Field Note: To be sent to Engr. of Plans & Survey (1 copy).
Office Note: To be filed in Flood Information by Counties.

R. D. Moran, Jr.
Chief of Party
May 19, 1961
Date

LOCATION NO. 7

R-14-E

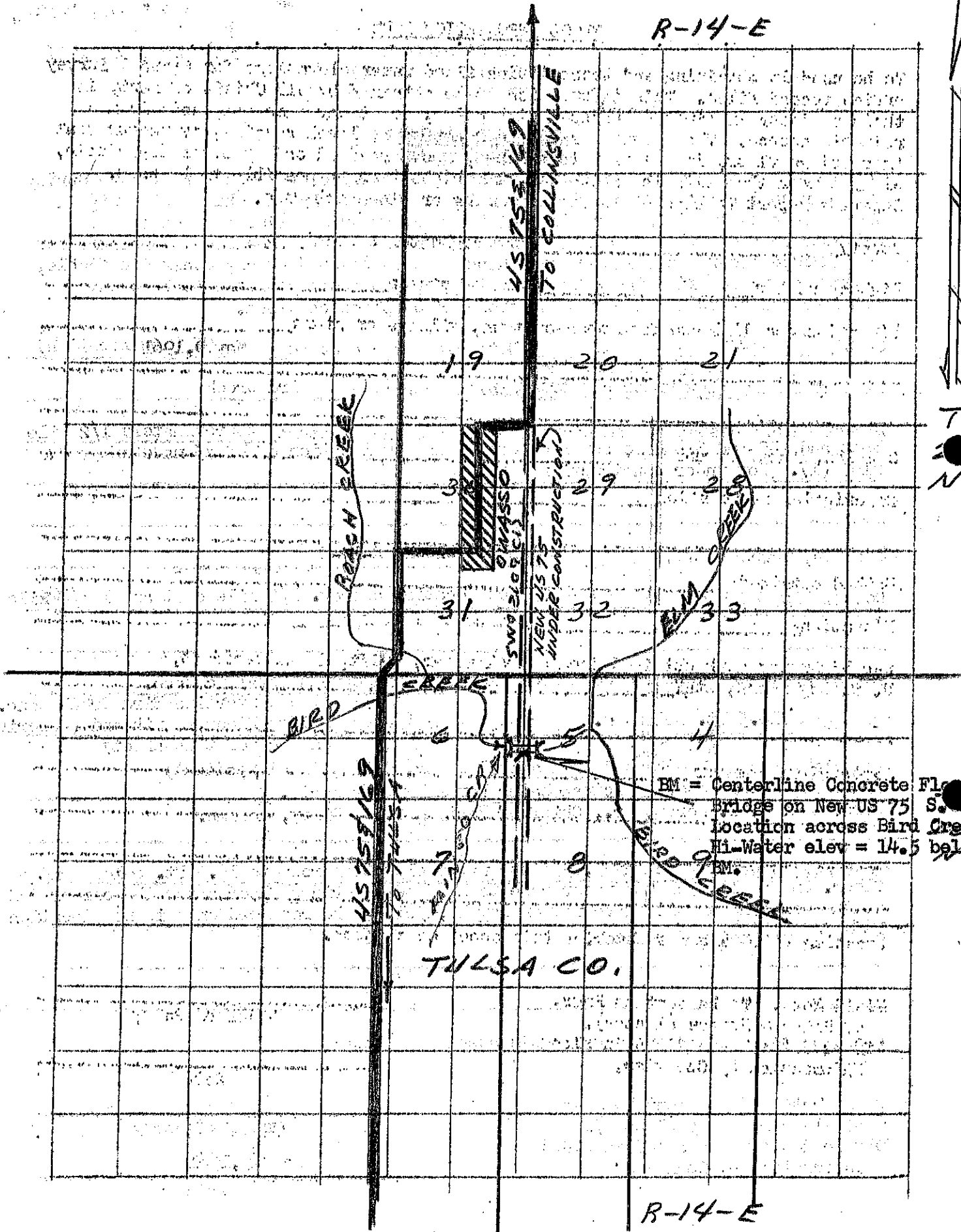

TULSA CO.

BM = Centerline Concrete Flag
Bridges on New US 75 S. and
Location across Bird Creek
Hi-Water elev = 14.5 below
BM.

R-14-E