

STATE OF OKLAHOMA  
DEPARTMENT OF HIGHWAYS  
SURVEY DIVISION

FLOOD INFORMATION FORM

To be used in obtaining and transmitting flood water elevations for Survey Division office record files. This information to be obtained by all Chiefs of Party or others in their vicinity in times of unusual high water, or at any time available from a reliable source. The elevations can be recorded by level reading, by measurement from bridge floor, in relation to a house, above roadbed or any other dependable, clear manner that fits the situation, the highest order possible to be used. Separate report to be made on each crossing or place obtained.

County Tulsa Date highwater occurred March 19, 1968

Highway number SH. 11 Name of stream Bird Creek

Direction and distance from nearest town, village or store Located on South East side of Skiatook, Oklahoma

Section, Township and Range Section's 25 & 26, T-22-N, R-12-E.

Description of Location Approx. 500 ft. south of Jct. E. 5 th. Street and SH. 11 in South East edge of Skiatook Approx. 200 ft. North of Mobile Home Park

Elevation 631.1 Source of levels USO&GS

Method obtained Engineer's level & level Rod Date obtained March 20, 1968

Did it appear to be  normal  medium  extreme  do not know

Was highwater mark obtained from actual water, drift, local resident, U. S. Engineers, etc.? From actual water and drift by this party.

Explanatory Remarks Water was 0.85 ft. deep on paving. Sh. 11 was closed for approx. 12 hours. Highwater caused from locally heavy rain.

Location to be shown on back of this sheet as a check.

Field Note: To be sent to  
Survey Engineer

Russ Jay Morank  
Location Engineer  
October 14, 1968  
Date

Location No. 17A

R-12-E

R-13-E

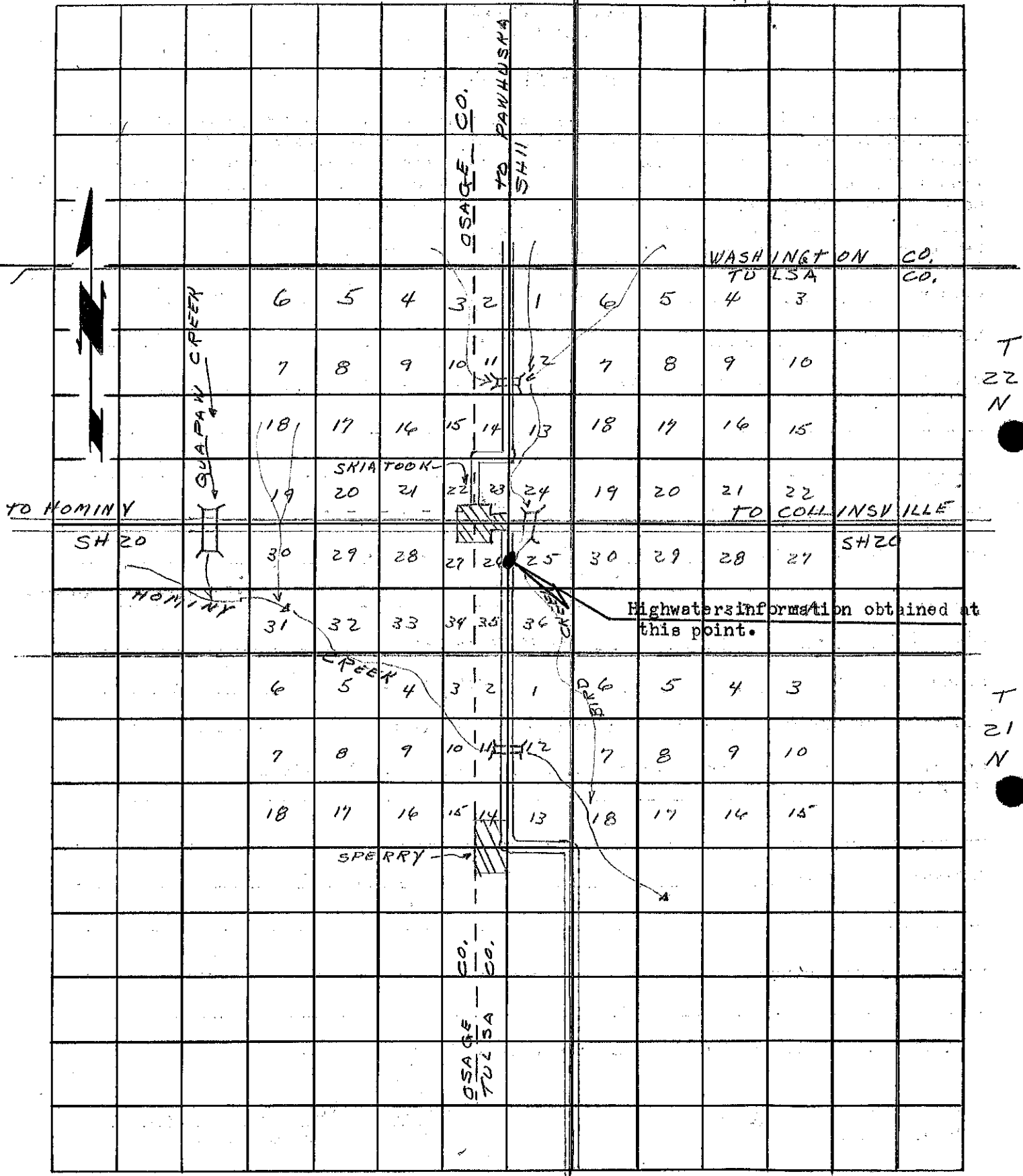

T  
22  
N

T  
21  
N