

RECEIVED

JUL 13 1984

SURVEY DIVISION

STATE OF OKLAHOMA
DEPARTMENT OF HIGHWAYS
SURVEY DIVISION

Survey Division
Form No. 16
Rev. Sept. 10, 1961

FLOOD INFORMATION FORM

To be used in obtaining and transmitting flood water elevations for Survey Division office record files. This information to be obtained by all Chiefs of Party or others in their vicinity in times of unusual high water, or at any time available from a reliable source. The elevations can be recorded by level reading, by measurement from bridge floor, in relation to a house, above roadbed or any other dependable, clear manner that fits the situation, the highest order possible to be used. Separate report to be made on each crossing or place obtained.

County Tulsa Date highwater occurred 5-27-84

Highway number 266 Name of stream Mingo Creek

Direction and distance from nearest town, village or store 3 mi. S. of Owasso, Ok.

Section, Township and Range 18, T-20-N R-14-E

Description of Location Approx. .4 mi. West of Mingo Valley Expwy. on E. 46th. St. N.
(266) in N.E. Tulsa.

Elevation 1.5' above S.E. bridge seat Source of levels south Bridge.

Method obtained Hand level & level rod Date obtained 5-29-84

Did it appear to be normal medium extreme do not know

Was highwater mark obtained from actual water, drift, local resident, U. S. Engineers, etc.? Debris in grass

Explanatory Remarks Location No. 16 on back of this sheet.

Location to be shown on back of this sheet as a check.

Field Note: To be sent to
Survey Engineer

Sam E. Higginbotham
Location Engineer

May 31, 1984
Date

LOCATION No. 48

**COMM.
DIST.
NO. 1**

86th ST N

76th ST N

66th ST N

56th ST N

46th ST N

36th ST N

APACHE
(26th ST N)

PIVE
(15th ST N)

R
O
G
E
R
S

STATE MAP NO. 20
TO BE USED IN
CONNECTION WITH
THIS MAP

CHEMICAL
WHEEL TIME

11th ST

21st ST

T
19 31st ST
N

41st ST

51st ST

61st ST

71st ST

81st ST

T
18 91st ST
N

101st ST

111st ST

121st ST

131st ST

N
E
R

141st ST

C
O
U
N
T
Y

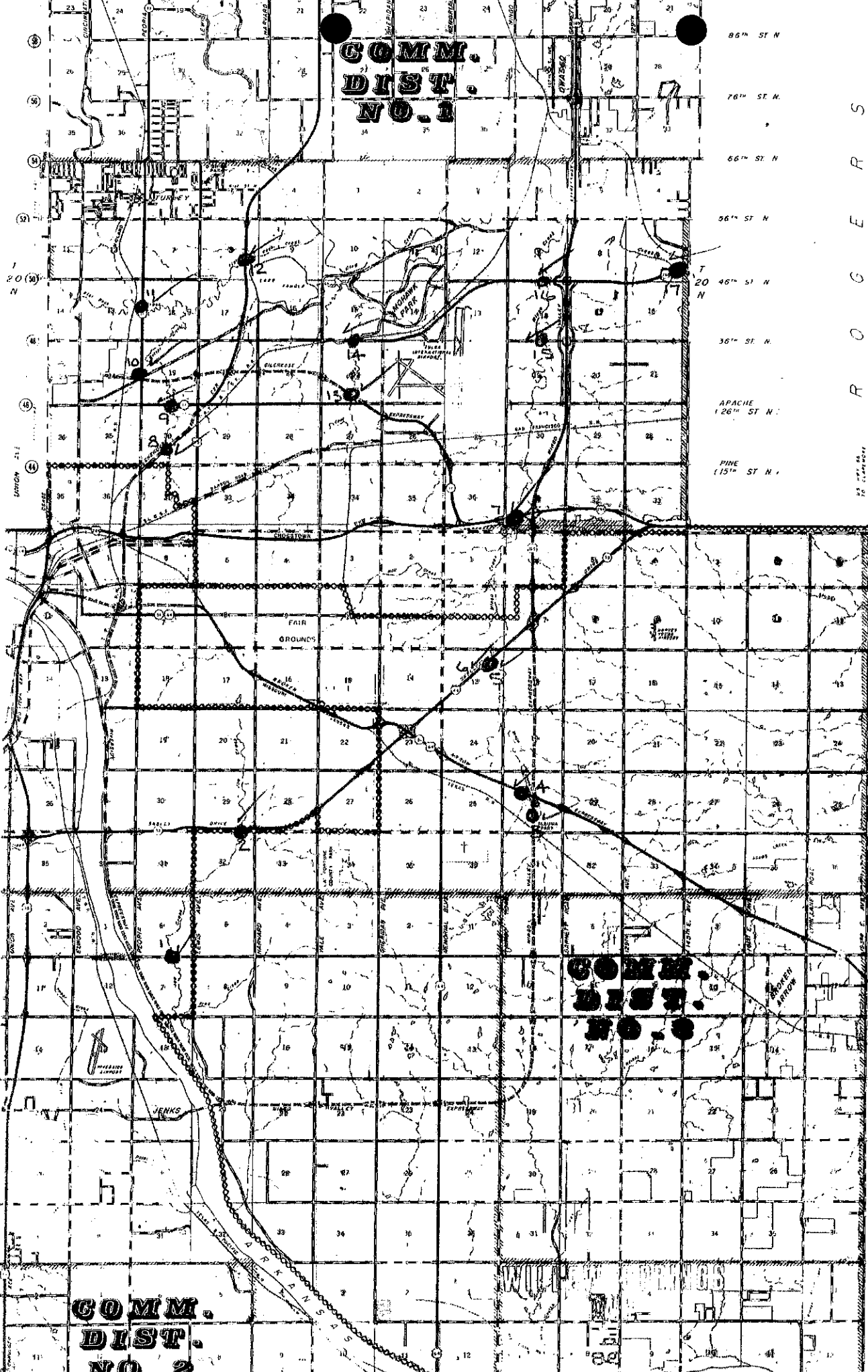

**COMM.
DIST.
NO. 2**

**COMM.
DIST.
NO. 1**