

STATE OF OKLAHOMA
DEPARTMENT OF HIGHWAYS
SURVEY DIVISION

FLOOD INFORMATION FORM

To be used in obtaining and transmitting flood water elevations for Survey Division office record files. This information to be obtained by all Chiefs of Party or others in their vicinity in times of unusual high water, or at any time available from a reliable source. The elevations can be recorded by level reading, by measurement from bridge floor, in relation to a house, above roadbed or any other dependable, clear manner that fits the situation, the highest order possible to be used: Separate report to be made on each crossing or place obtained.

County Tulsa Date highwater occurred May 27, 1984

Highway number US 169 Name of stream Overflow from Mingo Creek

Direction and distance from nearest town, village or store In east Tulsa

Section, Township and Range Section 30 & 31, T20N, R14E

Description of Location Drifts at the intersection of Us 169 and Pine Street.

Elevation 483.7 Source of levels Assumed

Method obtained Fennel Level Date obtained May 29, 1984

Did it appear to be normal medium extreme do not know

Was highwater mark obtained from actual water, drift, local resident, U. S. Engineers, etc.? Fresh water marks of the actual highwater.

Explanatory Remarks Bench mark is the southeast cor. of the hubguard at the southeast corner of the structure over Pine Street on north bound US 169. Assumed elev. - 500.00

Location to be shown on back of this sheet as a check.

Field Note: To be sent to
Survey Engineer

James Wayne Dejean
Location Engineer

6/5/84
Date

LOCATION NO. 58

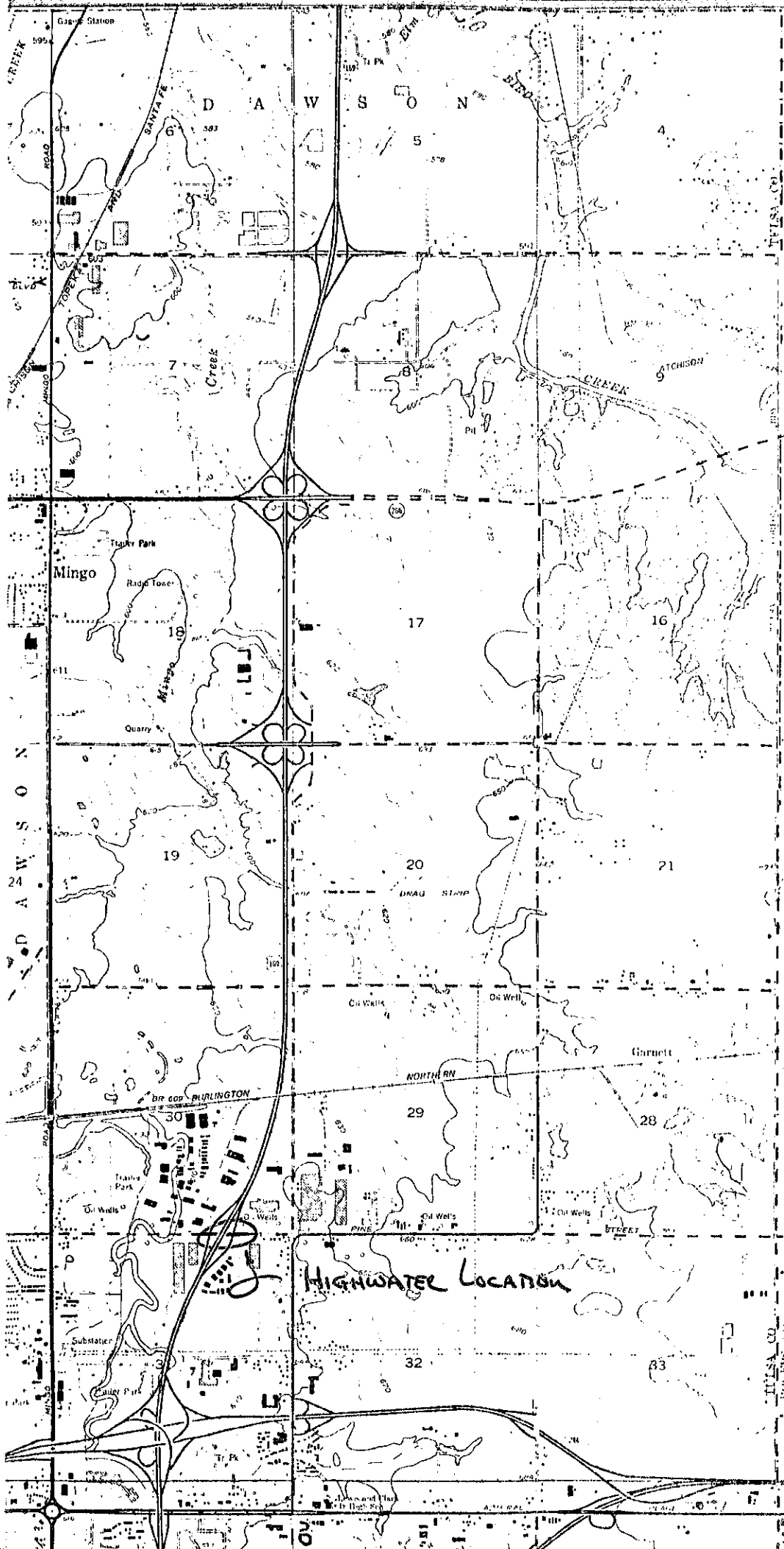

NEVADA CO. BANNER CO.

NEVADA CO. BANNER CO.

HIGHWATER LOCATION

DAWSON

MINGO

5

7

8

16

17

19

20

21

28

29

30

32

33

34

35

36

37

38

39

40

41

42

43

44

45

46

47

48

49

50

51

52

53

54

55

56

57

58

59

60

61

62

63

64

65

66

67

68

69

70

71

72

73

74

75

76

77

78

79

80

81

82

83

84

85

86

87

88

89

90

91

92

93

94

95

96

97

98

99

100

101

102

103

104

105

106

107

108

109

110