

STATE OF OKLAHOMA
DEPARTMENT OF HIGHWAYS
SURVEY DIVISION

Survey Division
Form No. 16
Rev. Sept. 10, 1961

FLOOD INFORMATION FORM

To be used in obtaining and transmitting flood water elevations for Survey Division office record files. This information to be obtained by all Chiefs of Party or others in their vicinity in times of unusual high water, or at any time available from a reliable source. The elevations can be recorded by level reading, by measurement from bridge floor, in relation to a house, above roadbed or any other dependable, clear manner that fits the situation, the highest order possible to be used. Separate report to be made on each crossing or place obtained.

County Tulsa Date highwater occurred 5-27-84

Highway number _____ Name of stream Joe Creek

Direction and distance from nearest town, village or store Southwest side of Tulsa

Section, Township and Range 6, T-18-N R-13-E

Description of Location .6 mi. east of 71st. ST. South & Peoria in Tulsa.

Elevation 5.4' below N.E. bridge seat Source of levels _____

Method obtained Hand level & level rod Date obtained 5-29-84

Did it appear to be normal medium extreme do not know

Was highwater mark obtained from actual water, drift, local resident, U. S. Engineers, etc.? Drift along creek banks.

Explanatory Remarks 12" Rain reported 2 mi. North of this area.

Location No. 1 on back of this sheet.

Location to be shown on back of this sheet as a check.

Field Note: To be sent to
Survey Engineer

Lucy E. Higginbotham
Location Engineer

May 31, 1984
Date

LOCATION No. 63

**COMM.
DIST.
NO. 1**

86th ST N
76th ST N
66th ST N
56th ST N
46th ST N
36th ST N
APACHE (26th ST N)
PINE (15th ST N)

R O G G E R S

11th ST
21st ST
31st ST
41st ST
51st ST
61st ST
71st ST
81st ST
91st ST
101st ST
111st ST
121st ST
131st ST
141st ST

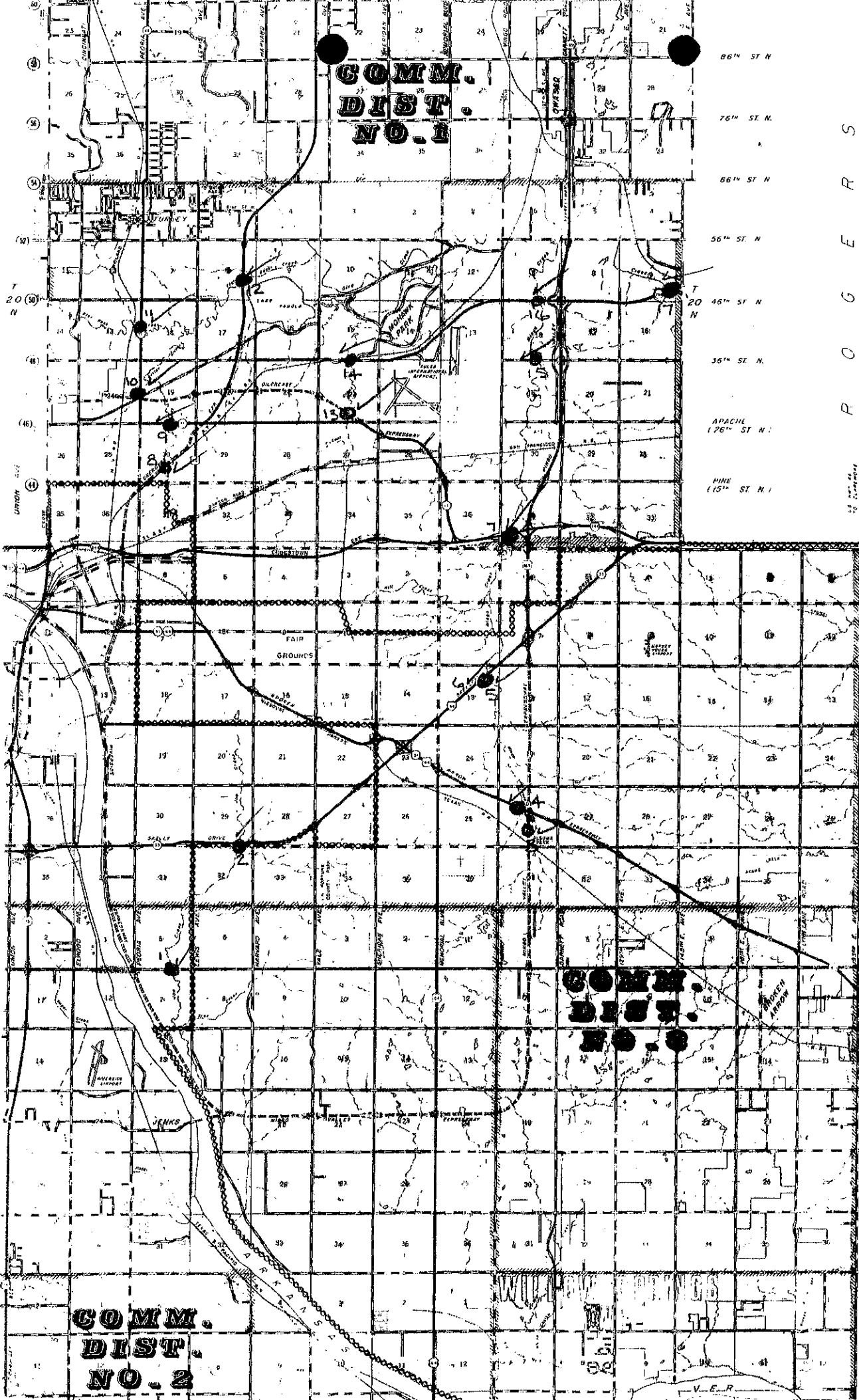

**COMM.
DIST.
NO. 2**

**COMER
DIST.
NO. 2**