

Loc No 19

LOC. NO. 1  
DEEP RED CREEK

Loc No 18

LOC. NO. 2  
LITTLE CR.

LOC. NO. 3

LOC. NO. 4  
E. JUNE CR.

LOC. NO. 5

LOC. NO. 6

LOC. NO. 7

LITTLE DEEP RED CREEK

LOCATION No. 12

BOTTLE CREEK

LOCATION No. 13

TR. 18. TO BOTTLE CREEK

LOCATION No. 14

LOCATION No. 17

LOCATION No. 16

LOC. NO. 9 DEEP RED CREEK

LOC. NO. 8 LITTLE DEEP RED CREEK

LOCATION No. 15

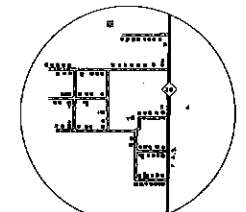
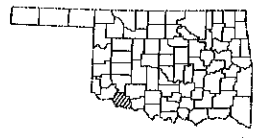

INSET NO. 1  
SC. 1:48,714 W. SCALE

POPULATION FIGURES BASED ON 1970 U. S. CENSUS  
 DEMOGRAPHIC FEATURES OBTAINED FROM AERIAL PHOTOGRAPHS  
 DATE OF SURVEY  
 1965  
 RECORDING  
 DATE BY  
 11-11-68 J.P. COLLINS  
 11-18-68 J.P. COLLINS  
 ALL DATA EXCEPT CULTURE  
 11-18-68 M. S. HARRIS  
 ALL DATA EXCEPT CULTURE  
 11-18-68 C. L. HARRIS  
 ALL DATA EXCEPT CULTURE  
 11-18-68 M. S. HARRIS  
 ALL DATA EXCEPT CULTURE  
 11-18-68 M. S. HARRIS  
 ALL DATA EXCEPT CULTURE  
 11-18-68 M. S. HARRIS



GENERAL HIGHWAY MAP  
**TILLMAN COUNTY**  
 OKLAHOMA

PREPARED BY THE  
 OKLAHOMA DEPARTMENT OF HIGHWAYS  
 PLANNING DIVISION  
 IN COOPERATION WITH THE  
 U.S. DEPARTMENT OF TRANSPORTATION  
 FEDERAL HIGHWAY ADMINISTRATION

SCALE 1" = 1 MILE

LAMBERT CONFORMAL CONIC PROJECTION U. S. ORIGIN & GEODETIC SURVEY DATA, NAD 83  
 FOOT AND METER IN PLANE COORDINATE SYSTEM STATE PROJECTION ZONE  
 ALL RIGHTS RESERVED

SHEET 2 OF 2 SHEETS

