



OKLAHOMA DEPARTMENT OF TRANSPORTATION
SURVEY DIVISION

FLOOD INFORMATION FORM

Division #:	1 <input type="checkbox"/> 2 <input type="checkbox"/> 3 <input type="checkbox"/> 4 <input type="checkbox"/> 5 <input checked="" type="checkbox"/> 6 <input type="checkbox"/> 7 <input type="checkbox"/> 8 <input type="checkbox"/>
County:	Tillman
Date Highwater occurred:	4/16/2016
Highway Number:	US 183
Name of Stream:	Suttle Creek
Direction and distance from nearest town, or highway junction	Approx. 5.2 miles north of Jct. US 183 & US 70
Section, Township, Range:	Section 12 T 3 S , R 18 W
Description of Location:	Cultivation, pasture and light timber. Water crossed over US 183 approx. 150' north of Suttle Creek Bridge.
Latitude	34°18'58" N
Longitude	99°02'34" W
Highwater Elevation:	1186' or Approximately same elevation as the North end of bridge floor
Level Datum & Source:	NAVD88 (Computed using GEOID12B)
Method used:	OPUS-RS Solution
Date Elevation Obtained:	4/21/2016
Apparent Magnitude:	Normal <input type="checkbox"/> Medium <input type="checkbox"/> Extreme <input checked="" type="checkbox"/> Unknown <input type="checkbox"/>
Was Highwater Mark obtained from actual water, drift, local resident, or other source?	Highwater was obtained from actual drift line.
Explanatory Remarks:	8" of rain occurred overnight in the upstream area of this location.

Name (Signature) _____

Name (Printed) Steve Perring

Date 4/21/2016

Note: Show Vicinity Map on back of form

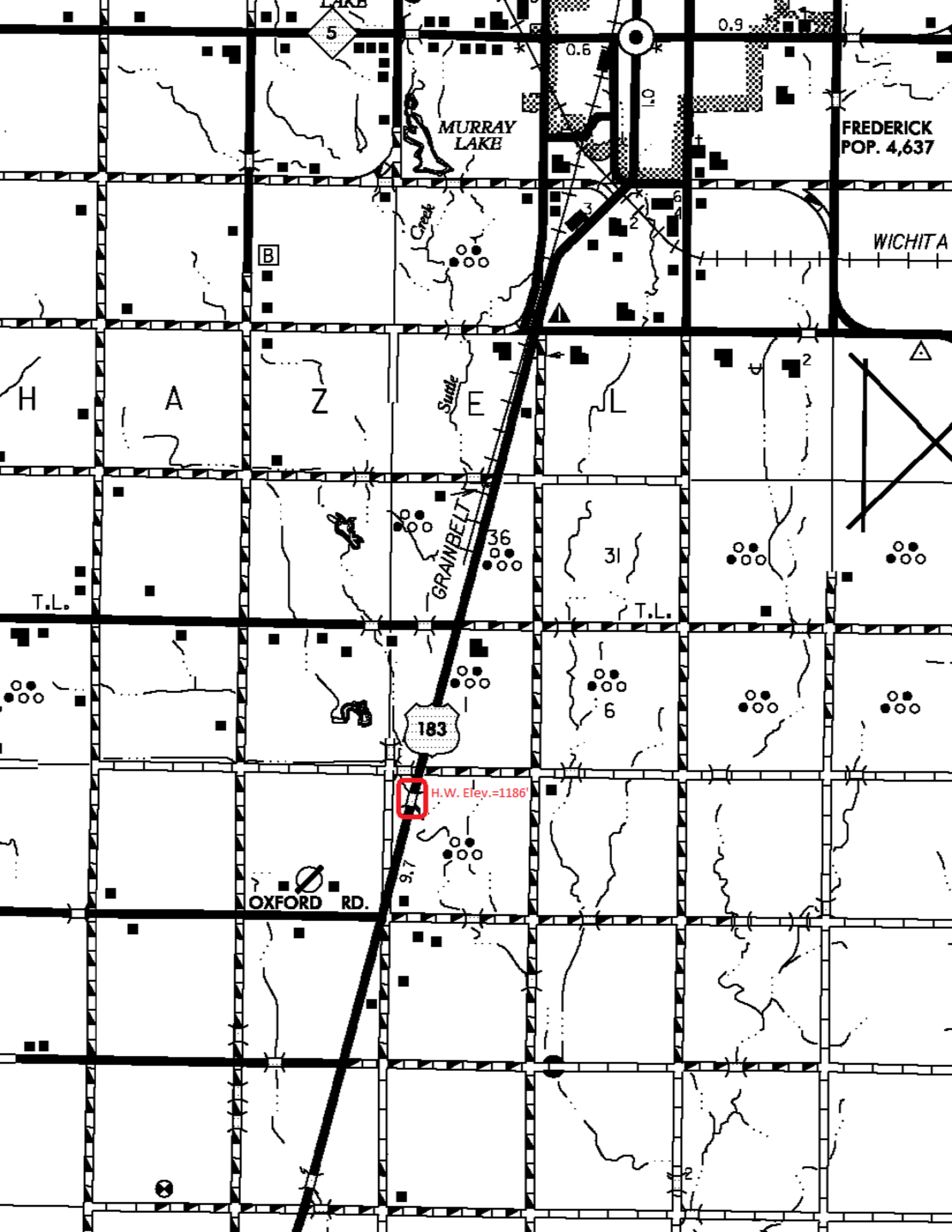

MURRAY
LAKE

FREDERICK
POP. 4,637

WICHITA

GRAINBELT

183

H.W. Eley.=1186'

OXFORD RD.

5

0.6

0.9

1.0

B

Creek

Suttle

E

L

H

A

Z

T.L.

31

6

T.L.

9.7

2