

OKLAHOMA DEPARTMENT OF TRANSPORTATION
SURVEY DIVISION

FLOOD INFORMATION FORM

Division #:	1 <input type="checkbox"/> 2 <input type="checkbox"/> 3 <input type="checkbox"/> 4 <input type="checkbox"/> 5 <input checked="" type="checkbox"/> 6 <input type="checkbox"/> 7 <input type="checkbox"/> 8 <input type="checkbox"/>
County:	Tillman
Date Highwater occurred:	06/29/07
Highway Number:	U.S. 183
Name of Stream:	N/A
Direction and distance from nearest town, or highway junction	Location is 3.75 miles north of Jct. S.H. 5 in Frederick or 0.25 miles south of EW177 Section Line.
Section, Township, Range:	Section 29, T-1-S, R-17-W, I.M.
Description of Location:	RCB cross-drain
Highwater Elevation:	1293.9 (Asphalt = 1294.0)
Level Datum & Source:	CIP 138-B(014)
Method used:	Differential Leveling
Date Elevation Obtained:	07/05/07
Apparent Magnitude:	Normal <input type="checkbox"/> Medium <input type="checkbox"/> Extreme <input checked="" type="checkbox"/> Don't Know <input type="checkbox"/>
Was Highwater Mark obtained from actual water, drift, local resident, or other source?	High-water was obtained from drift at this location.
Explanatory Remarks:	High-Water over west (south bound) lane only.

Note: Show Vicinity Map on back of form

Name (signature)

Name (Printed)

Danny R. Dees, PLS

Date:07/09/07

Survey Division
Form No. 16
Revised: 5/09/2007

LOCATION No. 20

GENERAL HIGHWAY MAP TILLMAN COUNTY OKLAHOMA

PREPARED BY THE
OKLAHOMA DEPARTMENT OF TRANSPORTATION
PLANNING DIVISION

IN COOPERATION WITH THE
U.S. DEPARTMENT OF TRANSPORTATION
FEDERAL HIGHWAY ADMINISTRATION

SCALE



LARGEST COMMERCIAL CONIC PROJECTION (L.C.) & GEODETIC SURVEY DATA
WGS 84 FOOT CONIC (NAD 83) (L.C.) (NAD 83) (L.C.) (NAD 83) (L.C.)
POPULATION VALUES BASED ON 1990 U.S. CENSUS
CG. POP. 1990



SHEET 1

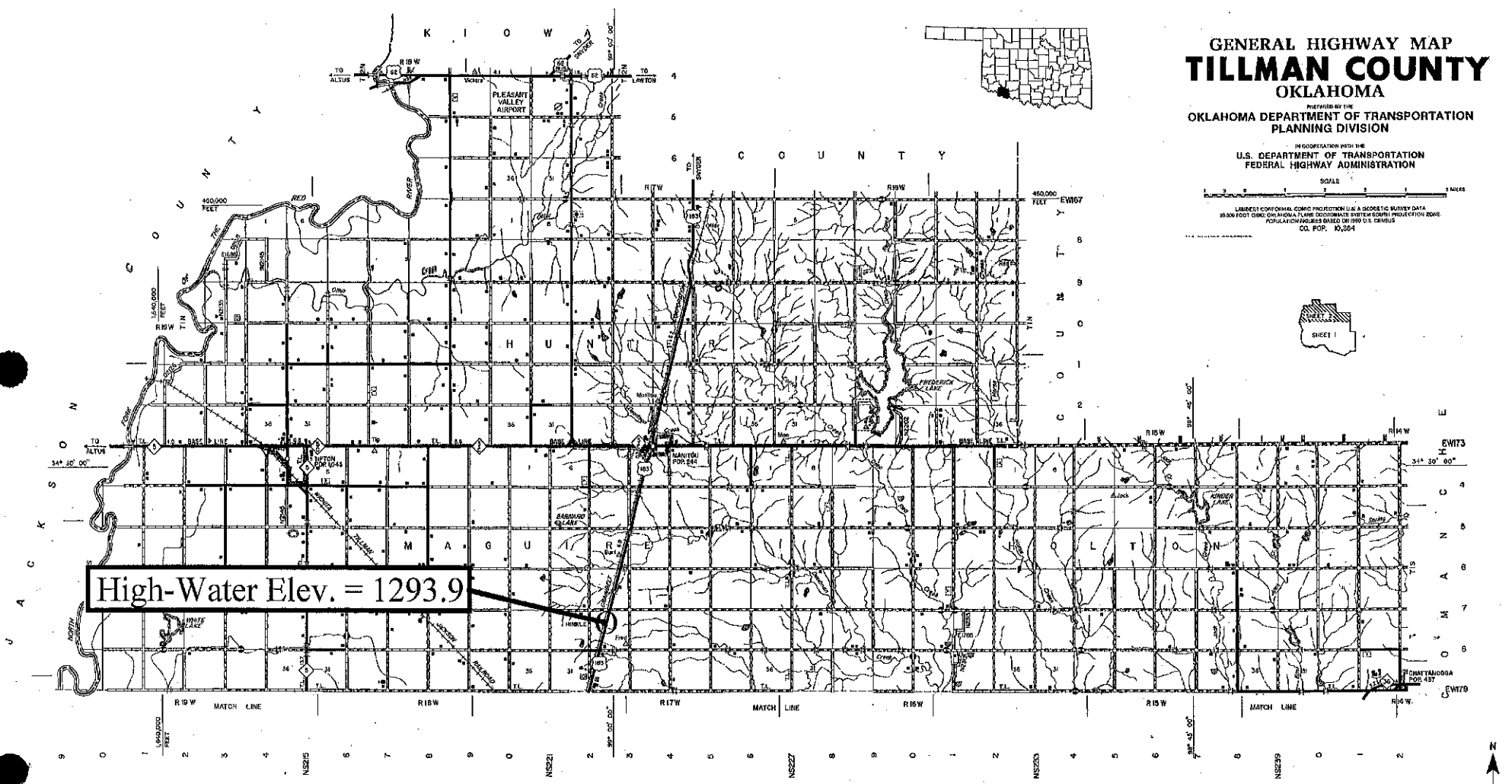

High-Water Elev. = 1293.9

