



OKLAHOMA DEPARTMENT OF TRANSPORTATION
SURVEY DIVISION

FLOOD INFORMATION FORM

Division #:	1 <input checked="" type="checkbox"/> 2 <input type="checkbox"/> 3 <input type="checkbox"/> 4 <input type="checkbox"/> 5 <input type="checkbox"/> 6 <input type="checkbox"/> 7 <input type="checkbox"/> 8 <input type="checkbox"/>
County:	Okmulgee
Date Highwater occurred:	12/26/2015
Highway Number:	US 75A
Name of Stream:	Railroad Underpass
Direction and distance from nearest town, or highway junction	0.9 Miles North of th Jct. of SH 16 & Us 75A in Beggs.
Section, Township, Range:	Section 30 T 15 N , R 12 E
Description of Location:	
Latitude	35 45 09.45
Longitude	95 04 12.65
Highwater Elevation:	729.13'
Level Datum & Source:	NAVD88-SWO 4457(1)
Method used:	GPS/RTK
Date Elevation Obtained:	12/28/2015
Apparent Magnitude:	Normal <input type="checkbox"/> Medium <input type="checkbox"/> Extreme <input checked="" type="checkbox"/> Unknown <input type="checkbox"/>
Was Highwater Mark obtained from actual water, drift, local resident, or other source?	High Water was given from Okmulgee County Maintenance Supervisor.
Explanatory Remarks:	

Name (Signature) 

Name (Printed) Shannon Harris

Date 1/4/2016

Note: Show Vicinity Map on back of form

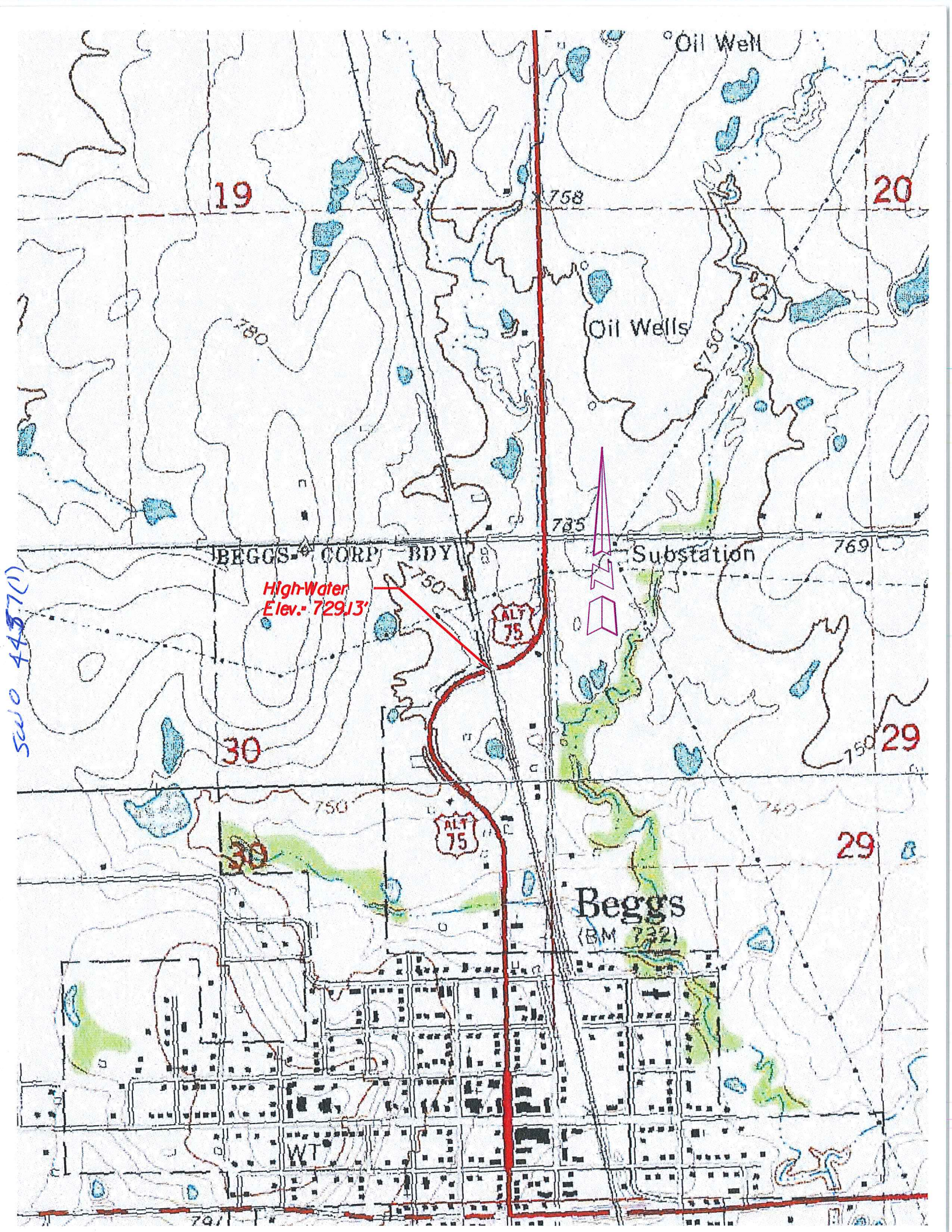

19

20

Oil Well

758

Oil Wells

BEGGS CORP. BDY

785

Substation

769

High-Water
Elev. 729.13'

ALT 75

30

750 29

750

ALT 75

740

29

Beggs
(BM 732)

WT

791