



**OKLAHOMA DEPARTMENT OF TRANSPORTATION
SURVEY DIVISION**

FLOOD INFORMATION FORM

Division #:	1 2 <input type="checkbox"/> 3 <input type="checkbox"/> 4 <input type="checkbox"/> 5 <input type="checkbox"/> 6 <input type="checkbox"/> 7 <input type="checkbox"/> 8 X
County:	Okmulgee
Date Highwater occurred:	10/30/13
Highway Number:	US 75A
Name of Stream:	Railroad Underpass
Direction and distance from nearest town, or highway junction	0.9 miles North of the Jct. of SH 16 & US75A in Beggs.
Section, Township, Range:	Section 25 T-15-N, R-11-E
Description of Location:	Shot taken on road surface "visible debris"
Highwater Elevation:	730.49'
Level Datum & Source:	NAVD88 – SWO4457(1)
Method used:	GPS (RTK)
Date Elevation Obtained:	11/04/2013
Apparent Magnitude:	Normal <input type="checkbox"/> Medium X Extreme Don't Know <input type="checkbox"/>
Was Highwater Mark obtained from actual water, drift, local resident, or other source?	Highwater was obtained by drift marks.
Explanatory Remarks:	

Note: Show Vicinity Map on back of form

Name (signature) _____

Name (Printed) Darin K. Stratton, PLS

Date:

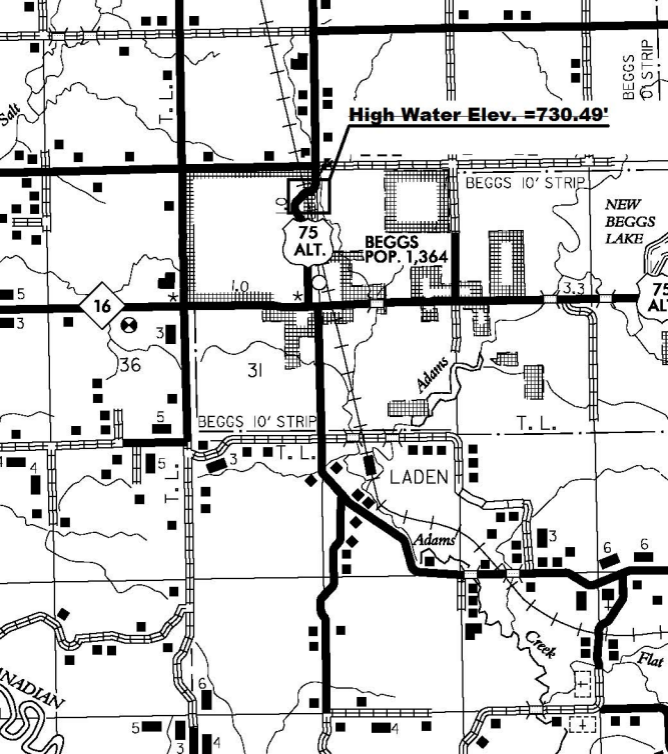

High Water Elev. = 730.49'

75
ALT.

BEGGS
POP. 1,364

16

BEGGS 10' STRIP

NEW
BEGGS
LAKE

75
ALT.

36

31

Adams

BEGGS 10' STRIP

T. L.

LADEN

Adams

Creek

Flat

INDIAN