

STATE OF OKLAHOMA  
DEPARTMENT OF HIGHWAYS  
SURVEY DIVISION

Survey Division  
Form No. 16  
Rev. Sept. 10, 1961

FLOOD INFORMATION FORM

To be used in obtaining and transmitting flood water elevations for Survey Division office record files. This information to be obtained by all Chiefs of Party or others in their vicinity in times of unusual high water, or at any time available from a reliable source. The elevations can be recorded by level reading, by measurement from bridge floor, in relation to a house, above roadbed or any other dependable, clear manner that fits the situation, the highest order possible to be used. Separate report to be made on each crossing or place obtained.

County Okmulgee Date highwater occurred October 28, 1983

Highway number County Road Name of stream Deep Fork of the Canadian River

Direction and distance from nearest town, village or store Approx. 0.75 mile north-west of Coalton.

Section, Township and Range Section 22, T12N, R13E

Description of Location Approx 0.2 mile southwest of where Deep Fork crosses the east-west road in Sec. 22 at a skwed. RCB overflow structure. This structure is approx. 500' south of where the N-S road turns east off the section line between section 21 & 22, T12N, R13E

Elevation 500.26 Source of levels Assumed

Method obtained Fennel Level Date obtained October 31, 1983

Did it appear to be  normal  medium  extreme  do not know

Was highwater mark obtained from actual water, drift, local resident, U. S. Engineers, etc.? Fresh water marks of the actual highwater.

Explanatory Remarks Bench mark is a 'a' on the center of the east conc. hdwl. of the above mentioned skwd. RCB. Assumed elevation = 500.00

Location to be shown on back of this sheet as a check.

Field Note: To be sent to  
Survey Engineer

Jerry Wayne Hoyle  
Location Engineer

November 1, 1983  
Date

*Copy to Bridge - 12-13-83 AZ*

**LOCATION NO. 13**

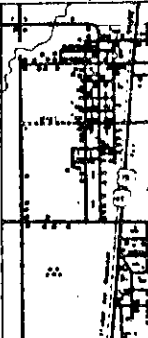
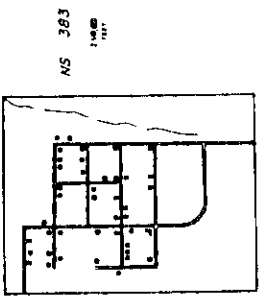
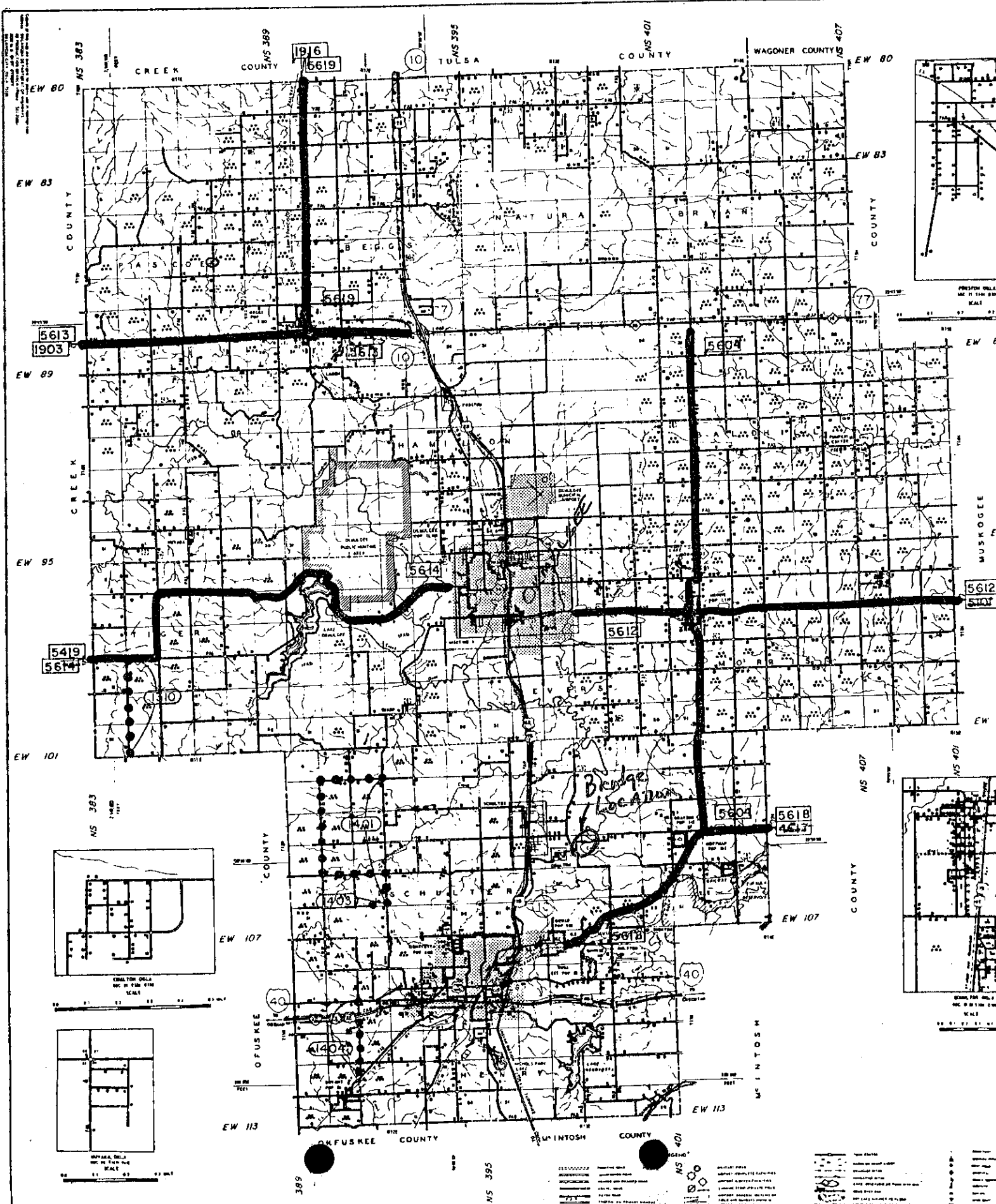

**LEGEND**

(Symbol)	Section
(Symbol)	Quarter Section
(Symbol)	Tract
(Symbol)	Water
(Symbol)	Swamp
(Symbol)	Unimproved Land
(Symbol)	Improved Land
(Symbol)	Public Land
(Symbol)	Private Land
(Symbol)	Other