

OKLAHOMA DEPARTMENT OF TRANSPORTATION
SURVEY DIVISION

FLOOD INFORMATION FORM

Division #:	1 X 2 <input type="checkbox"/> 3 <input type="checkbox"/> 4 <input type="checkbox"/> 5 <input type="checkbox"/> 6 <input type="checkbox"/> 7 <input type="checkbox"/> 8 X
County:	Okmulgee
Date Highwater occurred:	7/8/07
Highway Number:	SH16
Name of Stream:	Checkerboard Creek
Direction and distance from nearest town, or highway junction	1.1 miles east along SH 16 from the Jct. of Dentonville Road and SH16.
Section, Township, Range:	Section 26 T-17-N, R-11E
Description of Location:	Located in the SW4 of Section 26
Highwater Elevation:	677'
Level Datum & Source:	NAVD88 - SWO4288(1)
Method used:	GPS (RTK)
Date Elevation Obtained:	9/4/07
Apparent Magnitude:	Normal <input type="checkbox"/> Medium Extreme X Don't Know <input type="checkbox"/>
Was Highwater Mark obtained from actual water, drift, local resident, or other source?	We shot drift in the fence line west of the bridge that would have highwater within 0.8' of the bridge low steel.
Explanatory Remarks:	

Note: Show Vicinity Map on back of form

Name (signature) _____
Name (Printed) Darin K. Stratton, PLS
Date:

Copies of this map are available for public use at nominal cost.
ADDRESS: DEPARTMENT OF TRANSPORTATION
REPRODUCTION BRANCH PHONE (202) 365-2586

THIS CAD AND/OR GPS INFO IS INTEND TO THE DEPARTMENT TO BE GIVEN TO

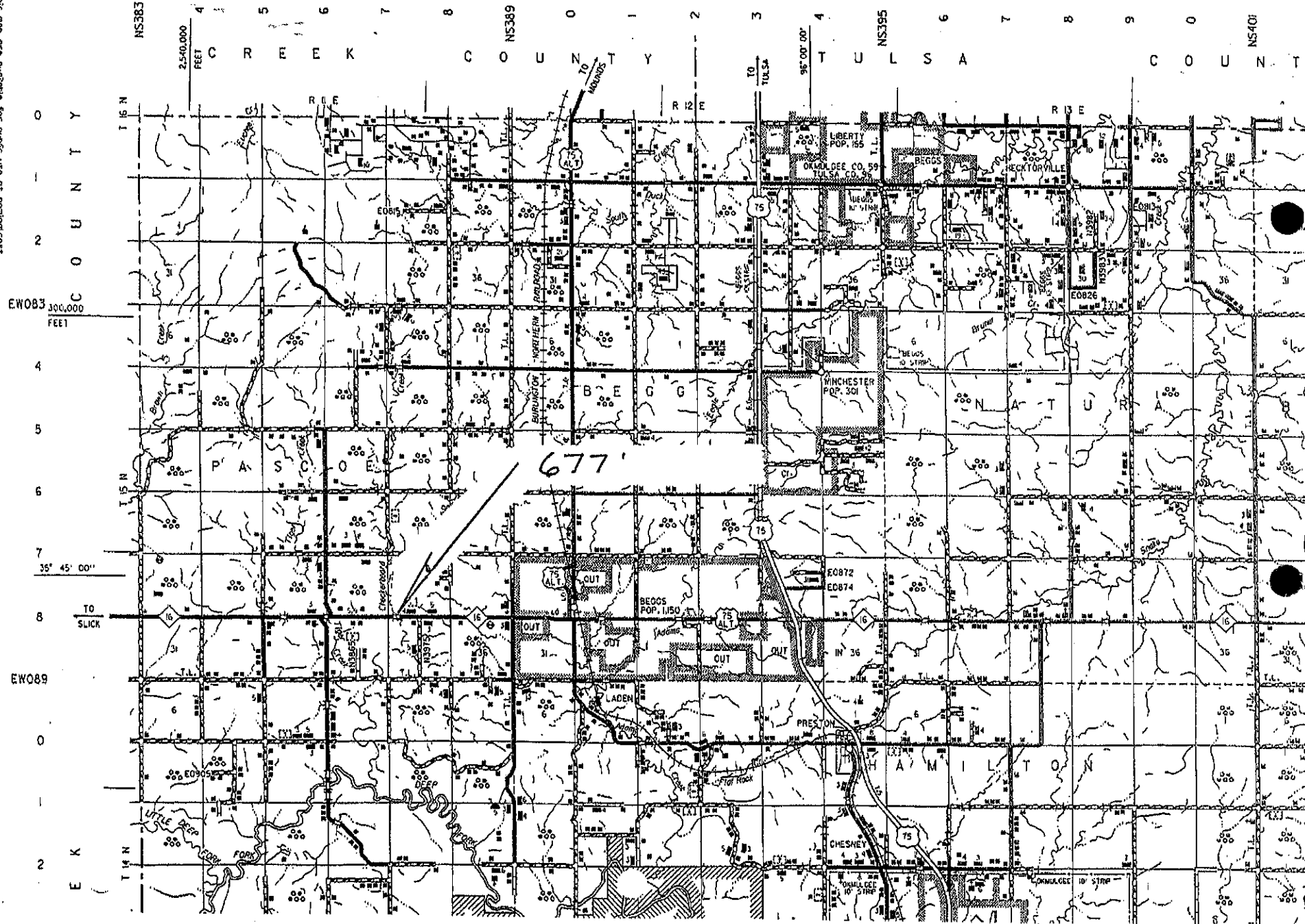

EW083
300,000
FEET

35° 45' 00"

EW089