

STATE OF OKLAHOMA
DEPARTMENT OF HIGHWAYS
PLANS AND SURVEY DEPARTMENT

FLOOD INFORMATION FORM

To be used in obtaining and transmitting flood water elevations for Plans & Survey office record files. This information to be obtained by all Chiefs of Party in their vicinity in times of unusual high water, or at any time available from a reliable source. The elevations can be recorded by level reading, by measurement from bridge floor, in relation to a house, above roadbed or any other dependable, clear manner that fits the situation, the highest order possible to be used. Separate report to be made on each crossing or place obtained.

County Oklahoma Date highwater occurred June 25, 1958

Highway number SH 74 Name of stream Deer Creek

Direction and distance from nearest town, village or store 2.5 miles

South of the Okla. Logan Co. Line on SH 74

Section, Township and Range Between sec. 13-14 - T14N R 4W

Description of Location _____

Method obtained Cloth Tape (Measured from Br. Floor)

Elevation _____ Source of levels 6" Below Br. Floor

Was highwater mark obtained from actual water, drift, local resident, U. S. Engineers, etc? Drift & silt

Explanatory Remarks 6" Below Bridge Floor on clearly defined silt & drift marks, whole valley flooded & road obtained by G.H. Stout & W.M. McLaughlin

Location to be shown on back of this sheet as a check.

Field Note: To be sent to Engr. of Plans & Survey (1 copy).

Office Note: To be filed in Flood Information by Counties.

W.M. McLaughlin
Chief of Party

6/26/58
Date

Location No. 6

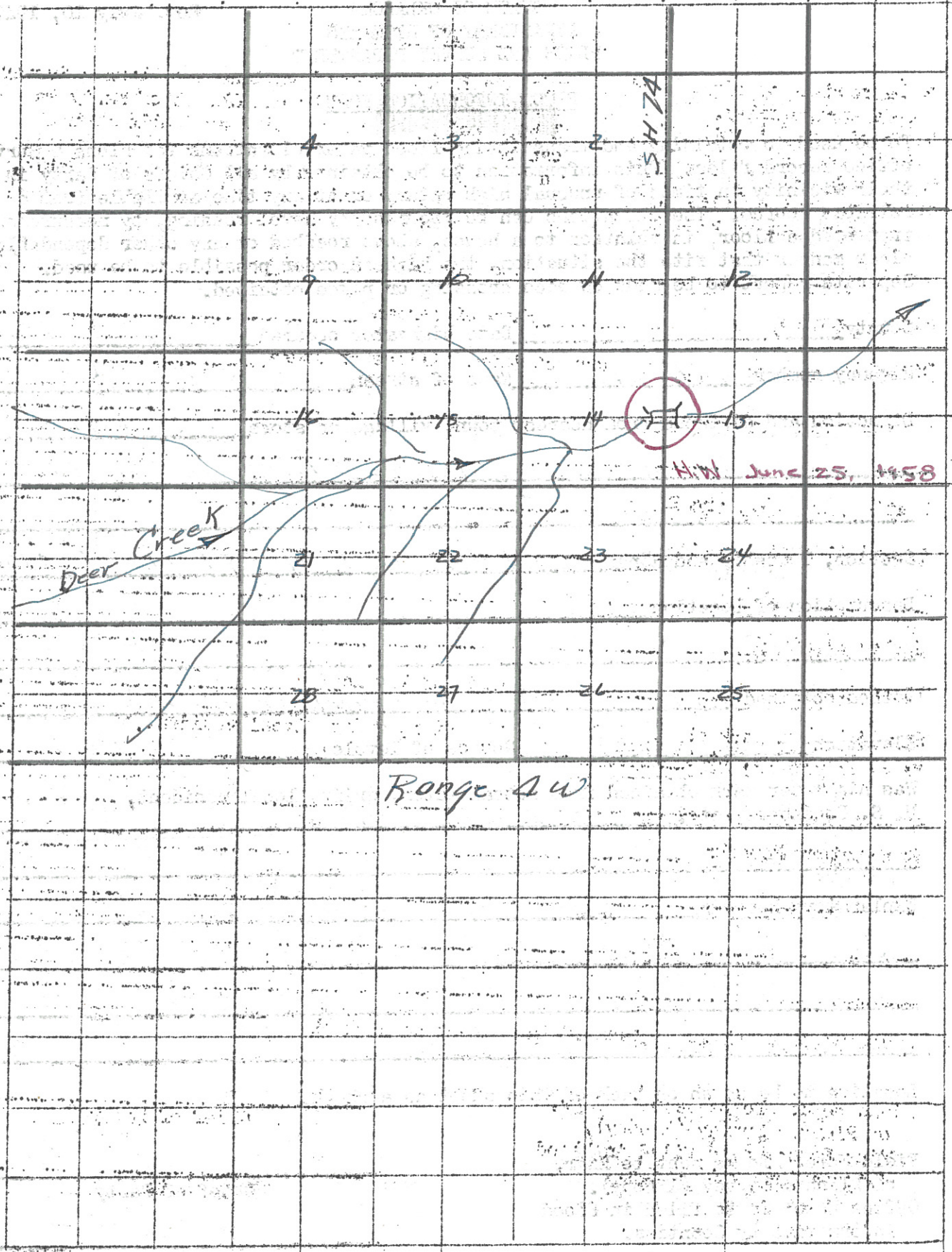

T
14
A1