

STATE OF OKLAHOMA  
DEPARTMENT OF HIGHWAYS  
SURVEY DIVISION

Survey Division  
Form No. 16  
Rev. Sept. 10, 1961

FLOOD INFORMATION FORM

To be used in obtaining and transmitting flood water elevations for Survey Division office record files. This information to be obtained by all Chiefs of Party or others in their vicinity in times of unusual high water, or at any time available from a reliable source. The elevations can be recorded by level reading, by measurement from bridge floor, in relation to a house, above roadbed or any other dependable, clear manner that fits the situation, the highest order possible to be used. Separate report to be made on each crossing or place obtained.

County OKLAHOMA Date highwater occurred Nov. 3, 1974

Highway number S.H. 152 Name of stream \_\_\_\_\_

Direction and distance from nearest town, village or store APPROX. 1.0 MI.

NORTHEASTERLY ALONG S.H. 152 FROM U.S. POST OFFICE

IN WHEATLAND, OR APPROX. 0.2 MI. W AND 0.1 MI. N OF THE S.E. COR. SEC. 20, T11N, R4W

Section, Township and Range SECTION 20, T11N, R4W

Description of Location 8' BELOW TOP OF S. HDWL. OF R.C.B.

Elevation \_\_\_\_\_ Source of levels \_\_\_\_\_

Method obtained HAND LEVEL Date obtained Nov. 6, 1974

Did it appear to be  normal  medium  extreme  do not know

Was highwater mark obtained from actual water, drift, local resident, U. S. Engineers, etc.? DRIFTS ALONG SIDES OF BANK ON S.

SIDE OF HIGHWAY

Explanatory Remarks \_\_\_\_\_

Location to be shown on back of this sheet as a check.

Field Note: To be sent to  
Survey Engineer

*Rewayne Walden*  
Chief of Party Loc. ENGR.

11-26-74

Date

Location No. 42

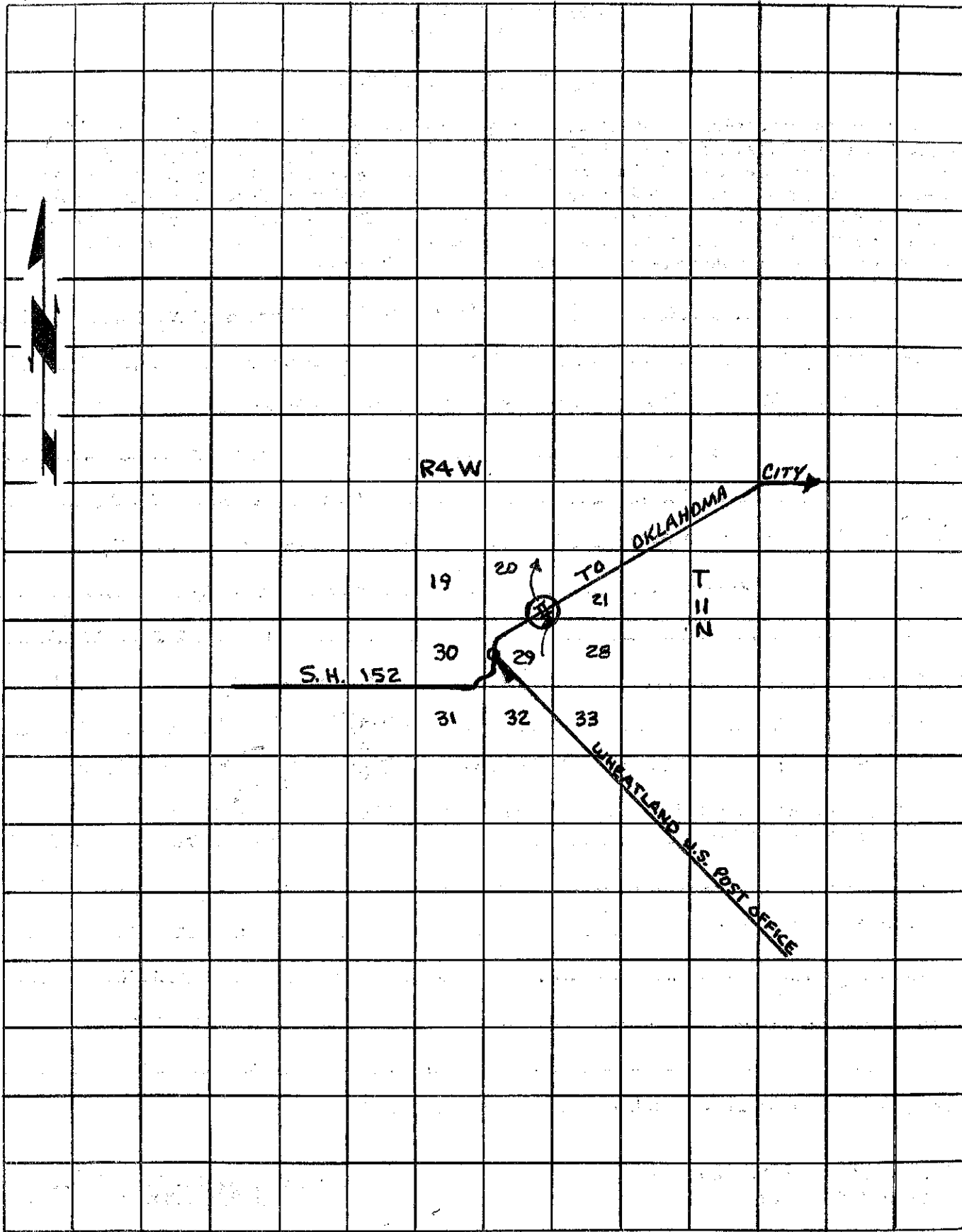

R4W

OKLAHOMA CITY

OKLAHOMA

19

20

TO

21

T  
11  
N

30

29

28

S.H. 152

31

32

33

WHEATLAND U.S. POST OFFICE