

STATE OF OKLAHOMA
DEPARTMENT OF HIGHWAYS
SURVEY DIVISION

FLOOD INFORMATION FORM

To be used in obtaining and transmitting flood water elevations for Survey Division office record files. This information to be obtained by all Chiefs of Party or others in their vicinity in times of unusual high water, or at any time available from a reliable source. The elevations can be recorded by level reading, by measurement from bridge floor, in relation to a house, above roadbed or any other dependable, clear manner that fits the situation, the highest order possible to be used. Separate report to be made on each crossing or place obtained.

County OKLAHOMA Date highwater occurred 11-3-74

Highway number S.H. 4 Name of stream _____

Direction and distance from nearest town, village or store APPROX. 0.35 MILE

S.E. OF INT. COUNTY LINE (OKLA. - CANADIAN CO.) & S.H. 3 (N.W. HIGHWAY)

OR APPROX. 0.45 MI. N. & 0.3 MILE OF S.W. COR. SEC. 30-T13N-R4W, IN N.W. PART OF OKLA. CITY

Section, Township and Range SEC. 30-T13N-R4W

Description of Location 4.0' ABOVE TOP OPENING OF 2-10' X 3' R.C.B. ON S.H. 3

(SOUTH END OF R.C.B.)

Elevation _____ Source of levels _____

Method obtained HAND LEVEL Date obtained 11-7-74

Did it appear to be normal medium extreme do not know

Was highwater mark obtained from actual water, drift, local resident, U. S. Engineers, etc.? WATER MARKS ON TREES & DRIFTS UPSTREAM

ON DRAIN.

Explanatory Remarks _____

Location to be shown on back of this sheet as a check.

Field Note: To be sent to
Survey Engineer

Lawrence Walden
Chief of Party Loc. Engr.

11-26-74
Date

Location No. 49

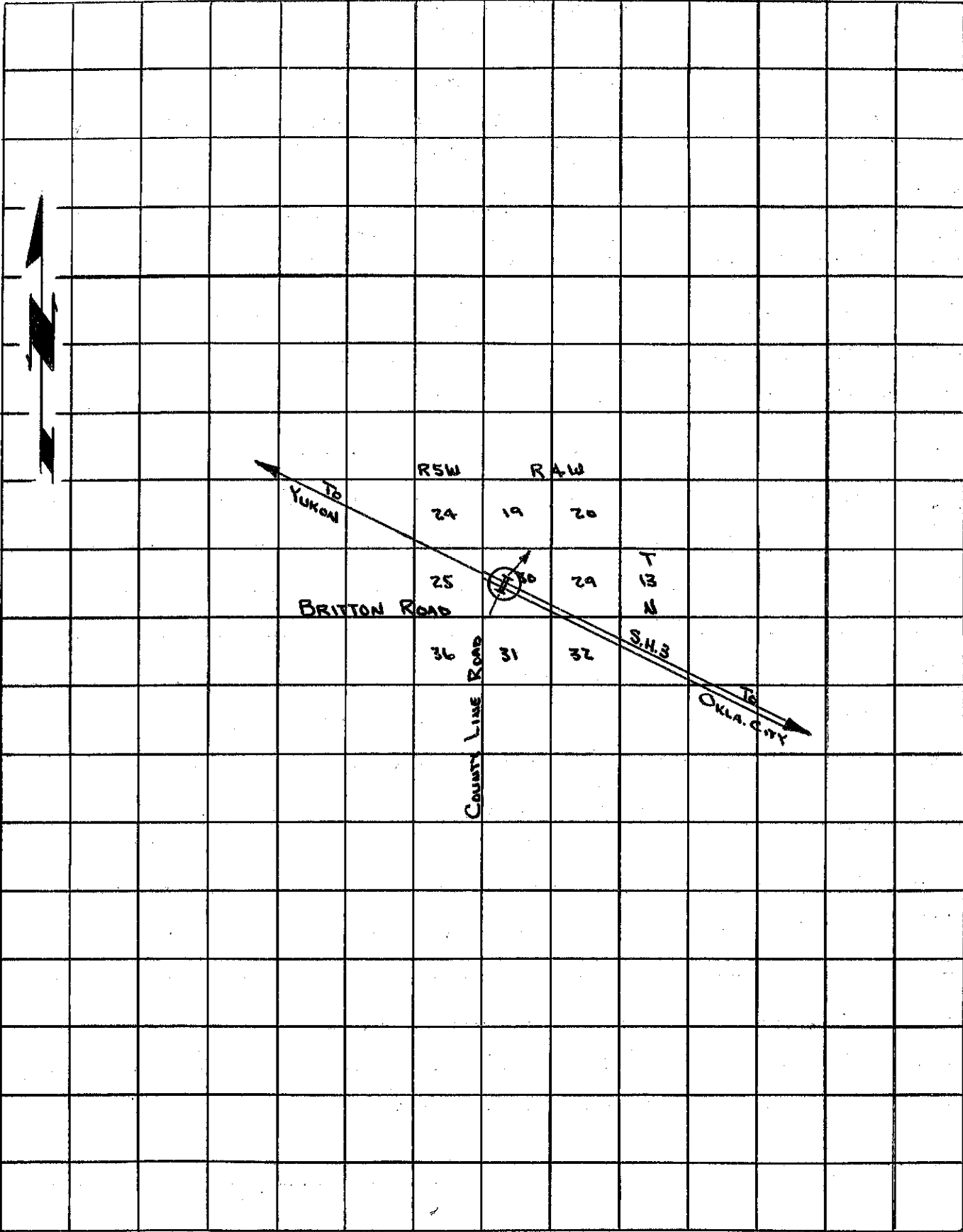

TO
YUKON

RSW RAW

24 19 20

25 29 T
 13
 N

BRITTON ROAD

36 31 32 S.H.S.

COUNTY LINE ROAD

TO
OKLA. CITY

30