

STATE OF OKLAHOMA
DEPARTMENT OF HIGHWAYS
SURVEY DIVISION

Survey Division
Form No. 16
Rev. Sept. 10, 1961

RECEIVED
SURVEY DIVISION

FLOOD INFORMATION FORM

To be used in obtaining and transmitting flood water elevations for Survey Division office record files. This information to be obtained by all Chiefs of Party or others in their vicinity in times of unusual high water, or at any time available from a reliable source. The elevations can be recorded by level reading, by measurement from bridge floor, in relation to a house, above roadbed or any other dependable, clear manner that fits the situation, the highest order possible to be used. Separate report to be made on each crossing or place obtained.

County Nowata Date highwater occurred July 3, 1976

Highway number SH 28 Name of stream Verdigris River

Direction and distance from nearest town, village or store Approximately 2.5 miles southeast of Delaware, or 1 mile east of Jct. US 169 & SH 28 south of Delaware.

Section, Township and Range Sec. 5, T-26-N, R-16-E.

Description of Location At present bridge in place.

Elevation 666.3 Ft. Source of levels Mean Sea Level "USED"

Method obtained Wye Level Date obtained July 8, 1976

Did it appear to be normal medium extreme do not know

Was highwater mark obtained from actual water, drift, local resident, U. S. Engineers, etc.? Silt marks on surrounding topography.

Explanatory Remarks Elev. west end bridge, concrete RDY floor = 676.31 Ft. (Plans)
No water on present SH 28 highway.

Location to be shown on back of this sheet as a check.

Field Note: To be sent to
Survey Engineer

Ray D. Johnson
Location Engineer

July 9, 1976

Date

Location No. 2

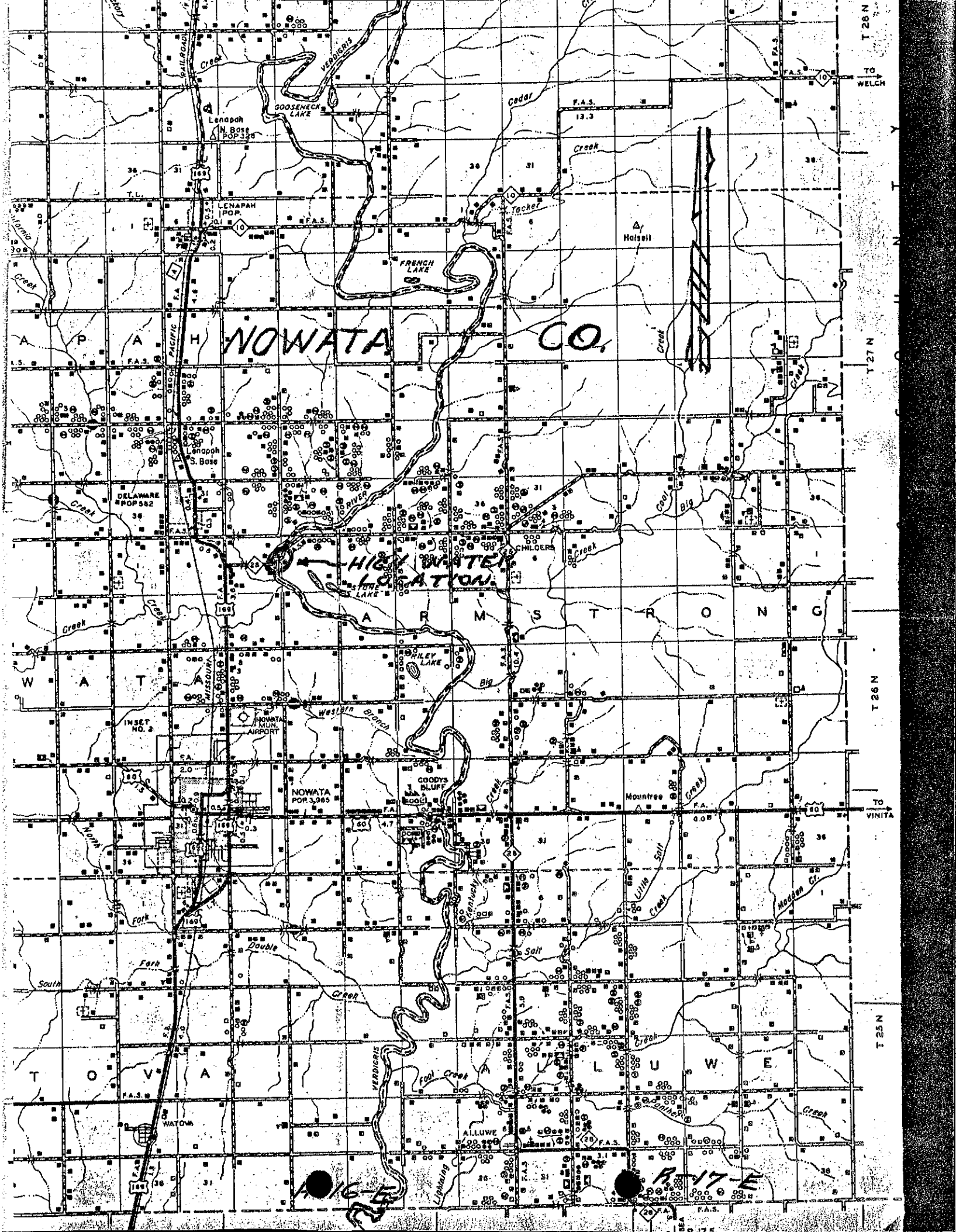

NOWATA CO.

HIGH WATER LOCATION

R-17-E

T. 28 N.

T. 27 N.

T. 26 N.

T. 25 N.

TO WELCH

TO VINITA

SAILROAD

PACIFIC

MISSOURI

WATOWA

Lenapah
N. Bosc
POP. 325

Lenapah
POP.

DELAWARE
POP. 582

INSET
NO. 2

NOWATA
POP. 3,983

GOODY'S BLUFF

ALLUWE

Malsell

Mountree

F.A.S.

F.A.S.
13.3

FRENCH LAKE

ORLEY LAKE

GOODY'S BLUFF

ALLUWE

GOOSENECK LAKE

VERDIGRIS

LIGHTNING

Cedar

Tacker

Big

Creek

F.A.S.

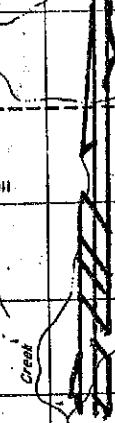

Coal

Big

Creek

F.A.S.

F.A.S.

F.A.S.

F.A.S.