

STATE OF OKLAHOMA
DEPARTMENT OF HIGHWAYS
SURVEY DIVISION

Survey Division
Form No. 16
Rev. Sept. 10, 1961

FLOOD INFORMATION FORM

To be used in obtaining and transmitting flood water elevations for Survey Division office record files. This information to be obtained by all Chiefs of Party or others in their vicinity in times of unusual high water, or at any time available from a reliable source. The elevations can be recorded by level reading, by measurement from bridge floor, in relation to a house, above roadbed or any other dependable, clear manner that fits the situation, the highest order possible to be used. Separate report to be made on each crossing or place obtained.

County Nowata Date highwater occurred July 3, 1976

Highway number US 169 Name of stream California Creek

Direction and distance from nearest town, village or store Approximately 3.5 miles north of Nowata.

Section, Township and Range East side of Sec. 7, T-26-N, R-16-E.

Description of Location At present bridge over California Creek.

Elevation 665.7 Ft. Source of levels Mean Sea Level "USED"

Method obtained Wye Level Date obtained July 8, 1976

Did it appear to be normal medium extreme do not know

Was highwater mark obtained from actual water, drift, local resident, U. S. Engineers, etc.? Silt marks on surrounding topography.

Explanatory Remarks Elev. north end, concrete RDY floor, south bound lane, west bridge = 671.66 Ft. (Plans). - No water on present US 169.

Location to be shown on back of this sheet as a check.

Field Note: To be sent to
Survey Engineer

Res. D. M. ...
Location Engineer

July 9, 1976
Date

Location No. 4

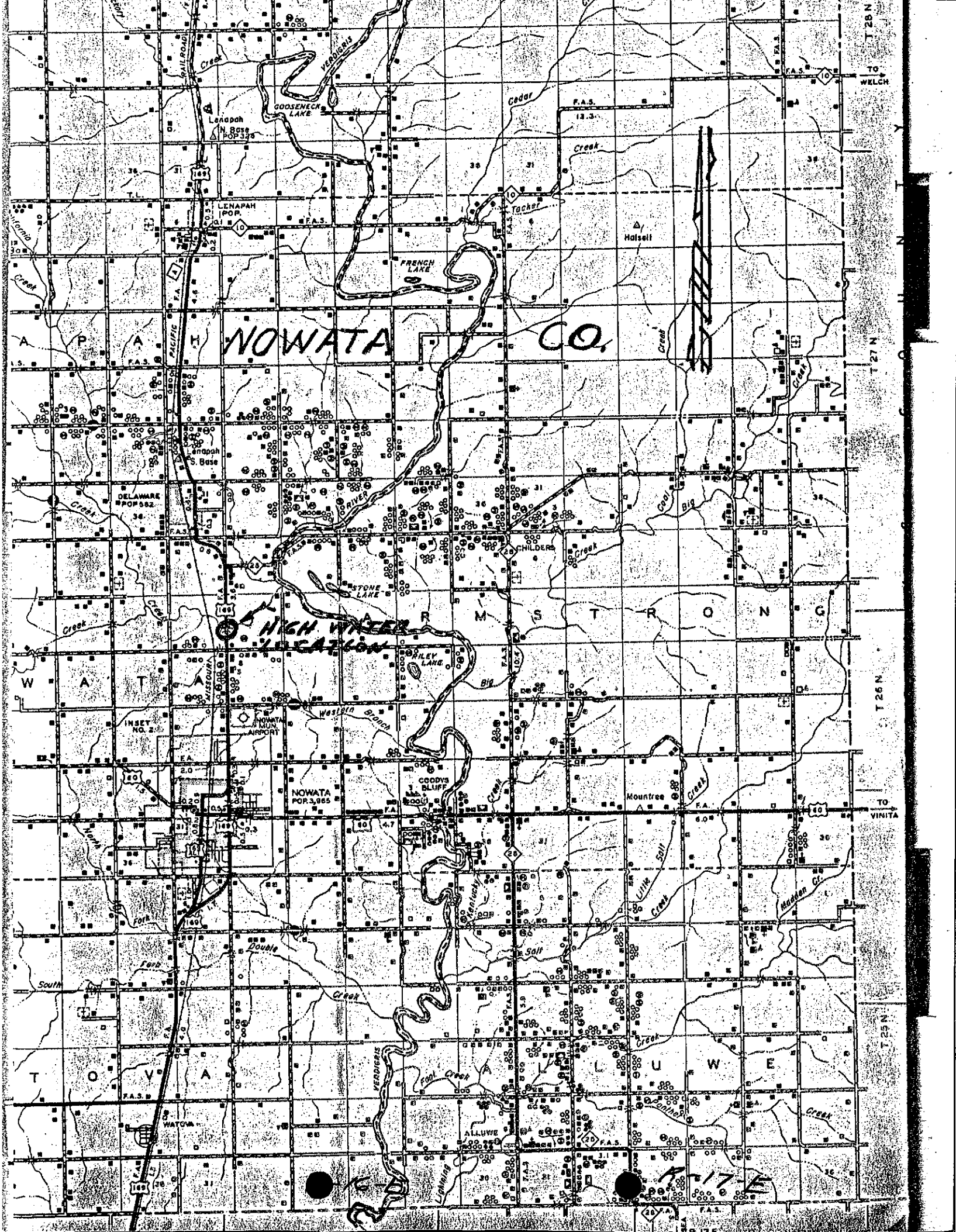

NOWATA CO.

HIGH WHEEL LOCATION

ARIZE