

STATE OF OKLAHOMA
DEPARTMENT OF HIGHWAYS
SURVEY DIVISION

FLOOD INFORMATION FORM

To be used in obtaining and transmitting flood water elevations for Survey Division office record files. This information to be obtained by all Chiefs of Party or others in their vicinity in times of unusual high water, or at any time available from a reliable source. The elevations can be recorded by level reading, by measurement from bridge floor, in relation to a house, above roadbed or any other dependable, clear manner that fits the situation, the highest order possible to be used. Separate report to be made on each crossing or place obtained.

County Nowata Date highwater occurred July 3, 1976

Highway number SH 10 Name of stream Cedar Creek

Direction and distance from nearest town, village or store Approximately 4.5
miles east of Lenapah.

Section, Township and Range Sec. 1, T-27-N, R-16-E

Description of Location At present new concrete bridge over Cedar Creek.

Elevation 677.6 Ft. Source of levels Mean Sea Level "USC&GS"

Method obtained Wye Level Date obtained July 8, 1976

Did it appear to be normal medium extreme do not know

Was highwater mark obtained from actual water, drift, local resident,
U. S. Engineers, etc.? Silt marks on surrounding topography.

Explanatory Remarks High water covered the bridge and road.
Elev. bridge RDY floor = 672.00 Ft. - Sta. 2444+68.55 SAP-53 (20) SH 10 as built
bridge plans. - Traffic closed from July 3, 76 to July 8, 76 AM. - The Oologah Dam gates
were also closed during part of this time which also held water back.

Location to be shown on back of this sheet as a check.

Field Note: To be sent to
Survey Engineer

Russ D. Maren
Location Engineer

July 9, 1976

Date

Location No. 9

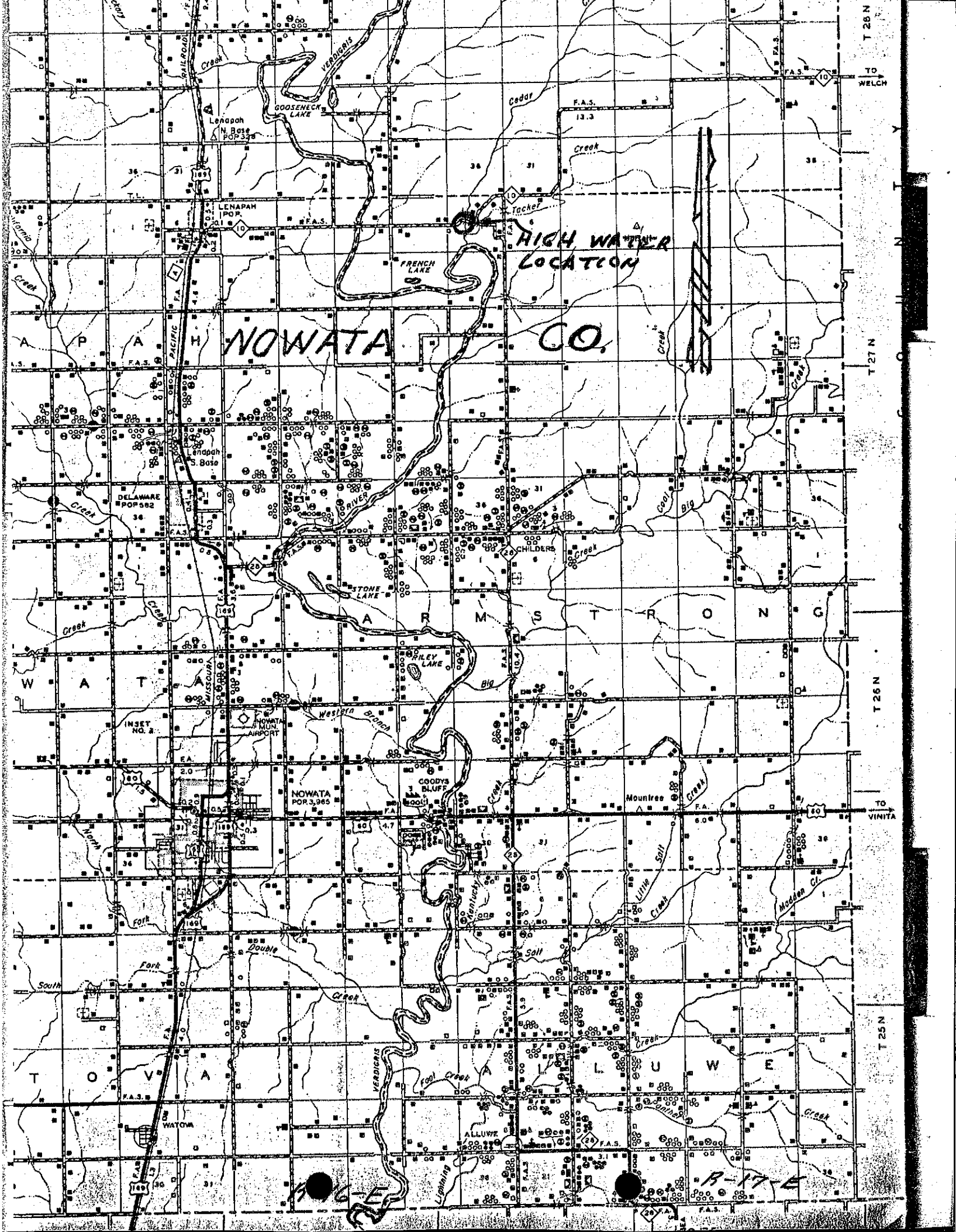

NOWATA CO.

HIGH WATER LOCATION

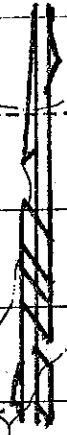

T 28N
TO WELCH
T 27N
T 26N
TO VINITA
T 25N

R-17E