

STATE OF OKLAHOMA  
DEPARTMENT OF HIGHWAYS  
SURVEY DIVISION

FLOOD INFORMATION FORM

To be used in obtaining and transmitting flood water elevations for Survey Division office record files. This information to be obtained by all Chiefs of Party or others in their vicinity in times of unusual high water, or at any time available from a reliable source. The elevations can be recorded by level reading, by measurement from bridge floor, in relation to a house, above roadbed or any other dependable, clear manner that fits the situation, the highest order possible to be used. Separate report to be made on each crossing or place obtained.

County Noble Date highwater occurred Sept 5, 1963

Highway number I-35 Name of stream \_\_\_\_\_

Direction and distance from nearest town, village or store 11.6 miles North of Jct. US 64 & I-35 West of Perry.

Section, Township and Range Sec. 20 - T23 N R 1 W

Description of Location Sta. 17+16 of I-35-456(4) (32) Plans at 13-17-17-13-15 RCB

Elevation 922.8 Source of levels USCEGS

Method obtained Hand Level Date obtained 9-5-63

Did it appear to be  normal  medium  extreme  do not know

Was highwater mark obtained from actual water, drift, local resident, U. S. Engineers, etc.? Silt Line

Explanatory Remarks \_\_\_\_\_

Location to be shown on back of this sheet as a check.

Field Note: To be sent to  
Survey Engineer

W. D. McLaughlin  
Chief of Party  
9-5-63  
Date

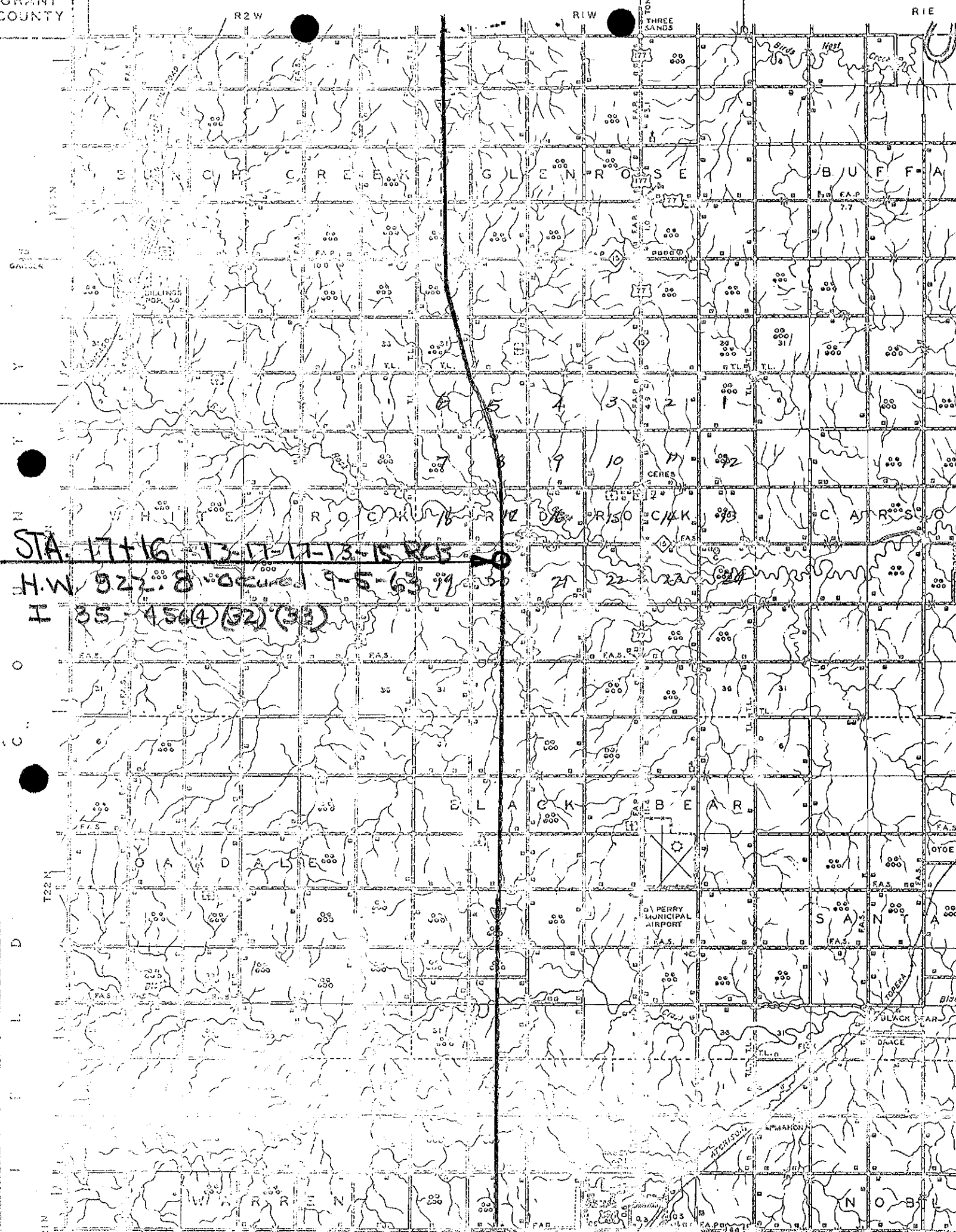

STA. 17+16-13-11-11-13-15 RCD  
 H.W. 922.8  
 I 35-150(4)(32)(33)

Y  
T  
N  
O  
C  
D  
L  
I

T22N

R2W

PERRY MUNICIPAL AIRPORT

WARRREN

NOR