

STATE OF OKLAHOMA
DEPARTMENT OF HIGHWAYS
SURVEY DIVISION

FLOOD INFORMATION FORM

To be used in obtaining and transmitting flood water elevations for Survey Division office record files. This information to be obtained by all Chiefs of Party or others in their vicinity in times of unusual high water, or at any time available from a reliable source. The elevations can be recorded by level reading, by measurement from bridge floor, in relation to a house, above roadbed or any other dependable, clear manner that fits the situation, the highest order possible to be used. Separate report to be made on each crossing or place obtained.

County Noble Date highwater occurred Sept. 5, 1963

Highway number I-35 Name of stream _____

Direction and distance from nearest town, village or store 12 miles North
of Uct. US 64 & I 35 West of Perry

Section, Township and Range 17-T 23 N R 1 W

Description of Location 2-10-4-RCB - Just North of
the E & W Sec. Line between sec. 17 & 20

Elevation 926.40 Source of levels USCE&GS

Method obtained Hand Level Date obtained 9-5-63

Did it appear to be normal medium extreme do not know

Was highwater mark obtained from actual water, drift, local resident, U. S. Engineers, etc.? Actual water

Explanatory Remarks This H-W. obtained by Construction
Dept. water was 2" on shoulder at
Station 28+70 on west side of Road

Location to be shown on back of this sheet as a check.

Field Note: To be sent to
Survey Engineer

McLaughlin
Chief of Party
9-5-63
Date

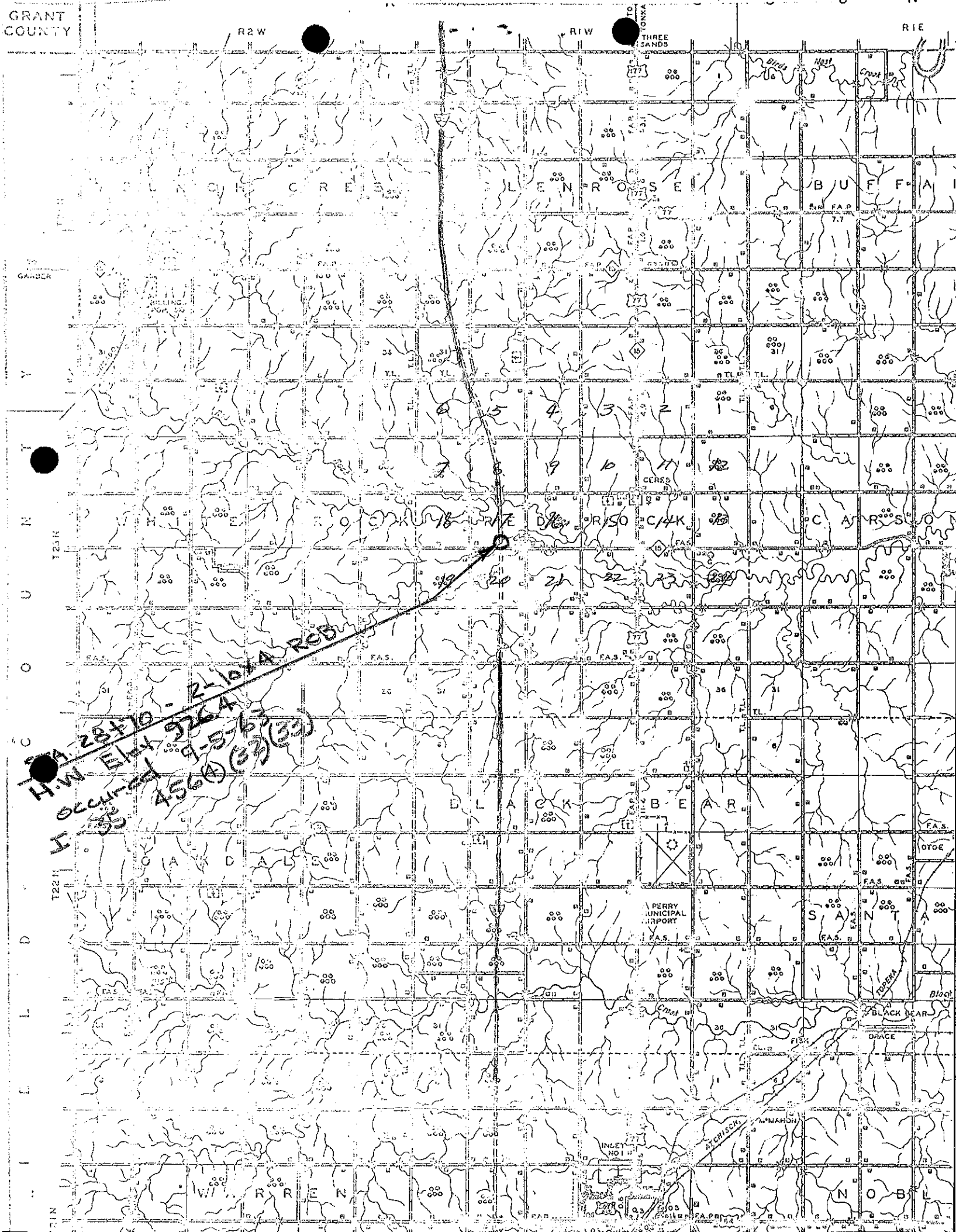

GRANT COUNTY

R2W

R1W

TO TONKA
THREE SANDS

RIE

TO GARDNER

Y

T

N

U

O

C

D

L

E

I

V

CIN

T23N

T22N

A-28-10 - 2-10-10A ROB
H.W. Box 926A
I occurred 9-5-67
33 4560 (33) (33)

PERRY MUNICIPAL AIRPORT

INLET NO. 1

BLACK BEAR

NOBLESVILLE