

STATE OF OKLAHOMA  
DEPARTMENT OF HIGHWAYS  
SURVEY DIVISION

FLOOD INFORMATION FORM

To be used in obtaining and transmitting flood water elevations for Survey Division office record files. This information to be obtained by all Chiefs of Party or others in their vicinity in times of unusual high water, or at any time available from a reliable source. The elevations can be recorded by level reading, by measurement from bridge floor, in relation to a house, above roadbed or any other dependable, clear manner that fits the situation, the highest order possible to be used. Separate report to be made on each crossing or place obtained.

County Noble Date highwater occurred Sept. 5, 1963

Highway number I-35 Name of stream Red Rock Creek overflow

Direction and distance from nearest town, village or store Approx. 12.5  
miles north of Jct. US 64 & I 35 West  
of Perry.

Section, Township and Range Sec. 17 T 23 N - R 1 W

Description of Location overflow structure at station  
51+28 of I-35. 456 (4) (32) Plans

Elevation 925.4 Source of levels USCEGS

Method obtained Hand Level Date obtained Sept. 5, 1963

Did it appear to be  normal  medium  extreme  do not know

Was highwater mark obtained from actual water, drift, local resident, U. S. Engineers, etc.? Well defined silt line

Explanatory Remarks \_\_\_\_\_  
\_\_\_\_\_  
\_\_\_\_\_

Location to be shown on back of this sheet as a check.

Field Note: To be sent to  
Survey Engineer

W. J. McLaughlin  
Chief of Party  
9-5-63  
Date

LOCATION NO. 7

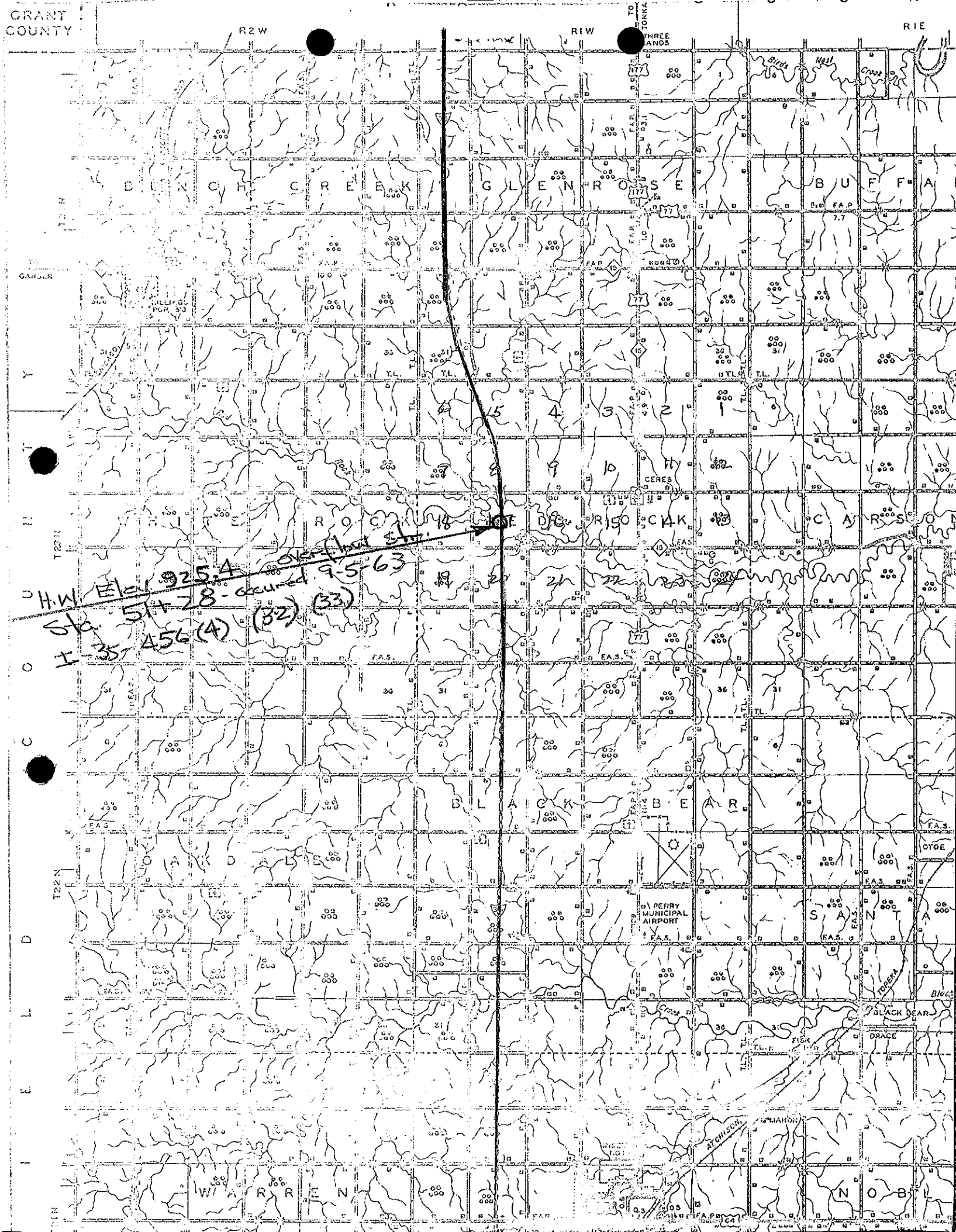

GRANT COUNTY

R2W

R1W

THREE LANDS

R1E

BUNCH CREEK GLEN ROSE BUFFALO

ROCKY MOUNTAIN RISE CLARK CARSON

BLACK BEAR

PERRY MUNICIPAL AIRPORT

SANTANA

WARREN

NOB

H.W. Elev 925.4  
Sta. 51+28 - occurred 9-5-63  
I-35 456(A) (32) (33)

OTGE

BLACK BEAR

ORACE

WICHISON

MAHON

BLACK BEAR

ORACE

ORACE

ORACE

ORACE

ORACE

ORACE

ORACE

ORACE

ORACE

ORACE

ORACE

ORACE