



OKLAHOMA DEPARTMENT OF TRANSPORTATION  
SURVEY DIVISION

FLOOD INFORMATION FORM

Division #:	1 X 2 <input type="checkbox"/> 3 <input type="checkbox"/> 4 <input type="checkbox"/> 5 <input type="checkbox"/> 6 <input type="checkbox"/> 7 <input type="checkbox"/> 8 <input type="checkbox"/>
County:	Muskogee
Date Highwater occurred:	5/29/2019
Highway Number:	US 62
Name of Stream:	Arkansas River
Direction and distance from nearest town, or highway junction	0.71 Miles West of the Jct. of US 62 And SH 10/Georgetown Road.
Section, Township, Range:	Sec. 22, T 15N, R 19E
Description of Location:	0.23 miles East of the RR overpass in front of OG&E Power Plant.
Highwater Elevation:	517.00'
Level Datum & Source:	NAVD 88 SWO 5220(1)
Method used:	RTK
Date Elevation Obtained:	6/3/2019
Apparent Magnitude:	Normal <input type="checkbox"/> Medium <input type="checkbox"/> Extreme X Don't Know <input type="checkbox"/>
Was Highwater Mark obtained from actual water, drift, local resident, or other source?	Actual Water
Explanatory Remarks:	State Plane Cord: N= 291 385.3615 E=2 774 737.9787

Note: Show Vicinity Map on back of form

Name (signature)   
Name (Printed)  
Date: 6/5/2019

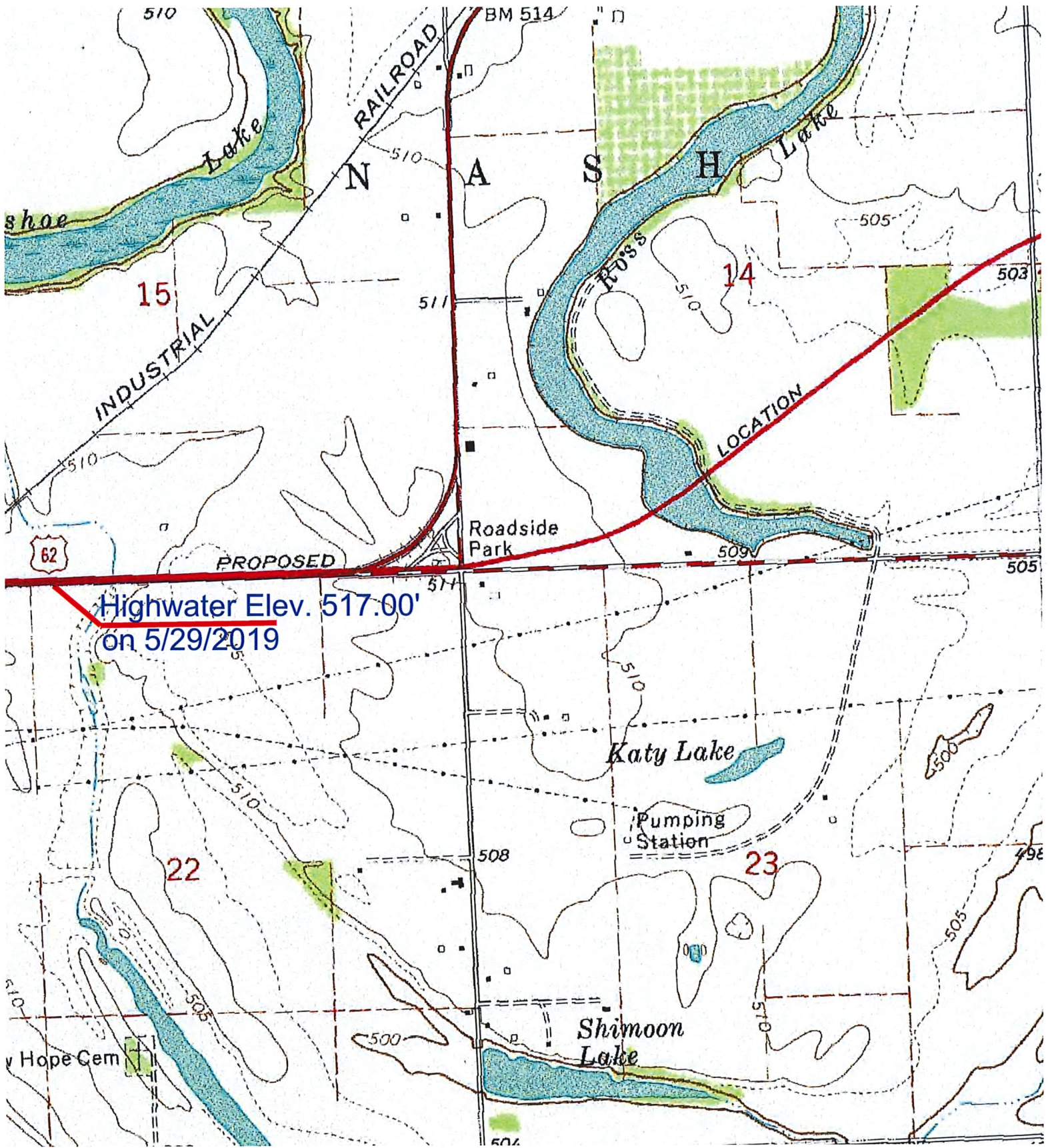

15

14

22

23

Highwater Elev. 517.00'  
on 5/29/2019

RAILROAD

INDUSTRIAL

Roadside Park

Katy Lake

Pumping Station

Shimoon Lake

y Hope Cem

62

BM 514

510

N

A

S

H

L

505

503

505

510

508

508

510

505

500

504

500

505

498