



OKLAHOMA DEPARTMENT OF TRANSPORTATION  
SURVEY DIVISION

FLOOD INFORMATION FORM

Division #:	1 <input checked="" type="checkbox"/> 2 <input type="checkbox"/> 3 <input type="checkbox"/> 4 <input type="checkbox"/> 5 <input type="checkbox"/> 6 <input type="checkbox"/> 7 <input type="checkbox"/> 8 <input type="checkbox"/>
County:	Muskogee
Date Highwater occurred:	5/28/2019
Highway Number:	US 69
Name of Stream:	Arkansas River Backwater
Direction and distance from nearest town, or highway junction	From the Jct. of US69 and the Muskogee Turnpike 3.6 miles South Near the Arkansas River Bridge.
Section, Township, Range:	Section 9, T-15N, R-18E
Description of Location:	US 69
Highwater Elevation:	526.93'
Level Datum & Source:	NAVD 88, Geoid 12B
Method used:	GPS/OPUS_RS
Date Elevation Obtained:	5/28/2019
Apparent Magnitude:	Normal <input type="checkbox"/> Medium <input type="checkbox"/> Extreme <input checked="" type="checkbox"/> Don't Know <input type="checkbox"/>
Was Highwater Mark obtained from actual water, drift, local resident, or other source?	Actual Water
Explanatory Remarks:	State Plane Coordinates N: 298749.5107, E: 2738761.4119

Note: Show Vicinity Map on back of form

Name (signature) \_\_\_\_\_

Name (Printed)

Date: 6/05/2019

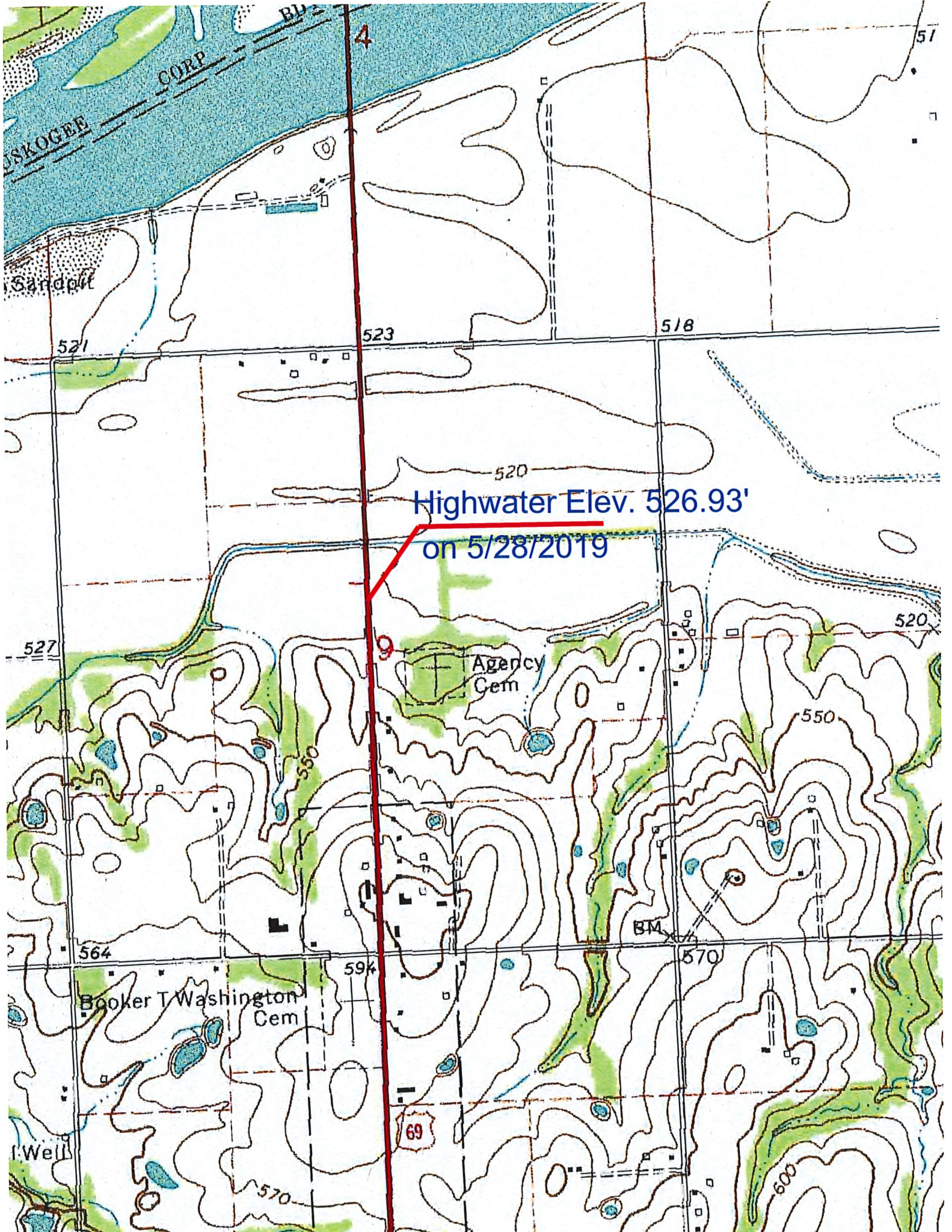

OSKOGEE CORP

Sand pit

Highwater Elev. 526.93'  
on 5/28/2019

Agency Cem

Booker T Washington Cem

I. Well

69

521

523

518

520

51

527

520

550

564

594

570

570

600