



OKLAHOMA DEPARTMENT OF TRANSPORTATION  
SURVEY DIVISION

FLOOD INFORMATION FORM

Division #:	1 <input checked="" type="checkbox"/> 2 <input type="checkbox"/> 3 <input type="checkbox"/> 4 <input type="checkbox"/> 5 <input type="checkbox"/> 6 <input type="checkbox"/> 7 <input type="checkbox"/> 8 <input type="checkbox"/>
County:	Muskogee
Date Highwater occurred:	5/28/2019
Highway Number:	SH 165
Name of Stream:	Arkansas River Backwater
Direction and distance from nearest town, or highway junction	Located at the Jct. of SH 165 and Country Club Rd in Muskogee.
Section, Township, Range:	Section 6, T-14N, R-19E
Description of Location:	SH 165
Highwater Elevation:	517.65'
Level Datum & Source:	NAVD 88 SWO 5220(1)
Method used:	RTK
Date Elevation Obtained:	5/28/2019
Apparent Magnitude:	Normal <input type="checkbox"/> Medium <input type="checkbox"/> Extreme <input checked="" type="checkbox"/> Don't Know <input type="checkbox"/>
Was Highwater Mark obtained from actual water, drift, local resident, or other source?	Actual Water
Explanatory Remarks:	State Plane Coordinates N: 273021.5576 , E: 2763122.8607

Note: Show Vicinity Map on back of form

Name (signature) \_\_\_\_\_

Name (Printed)

Date: 6/05/2019

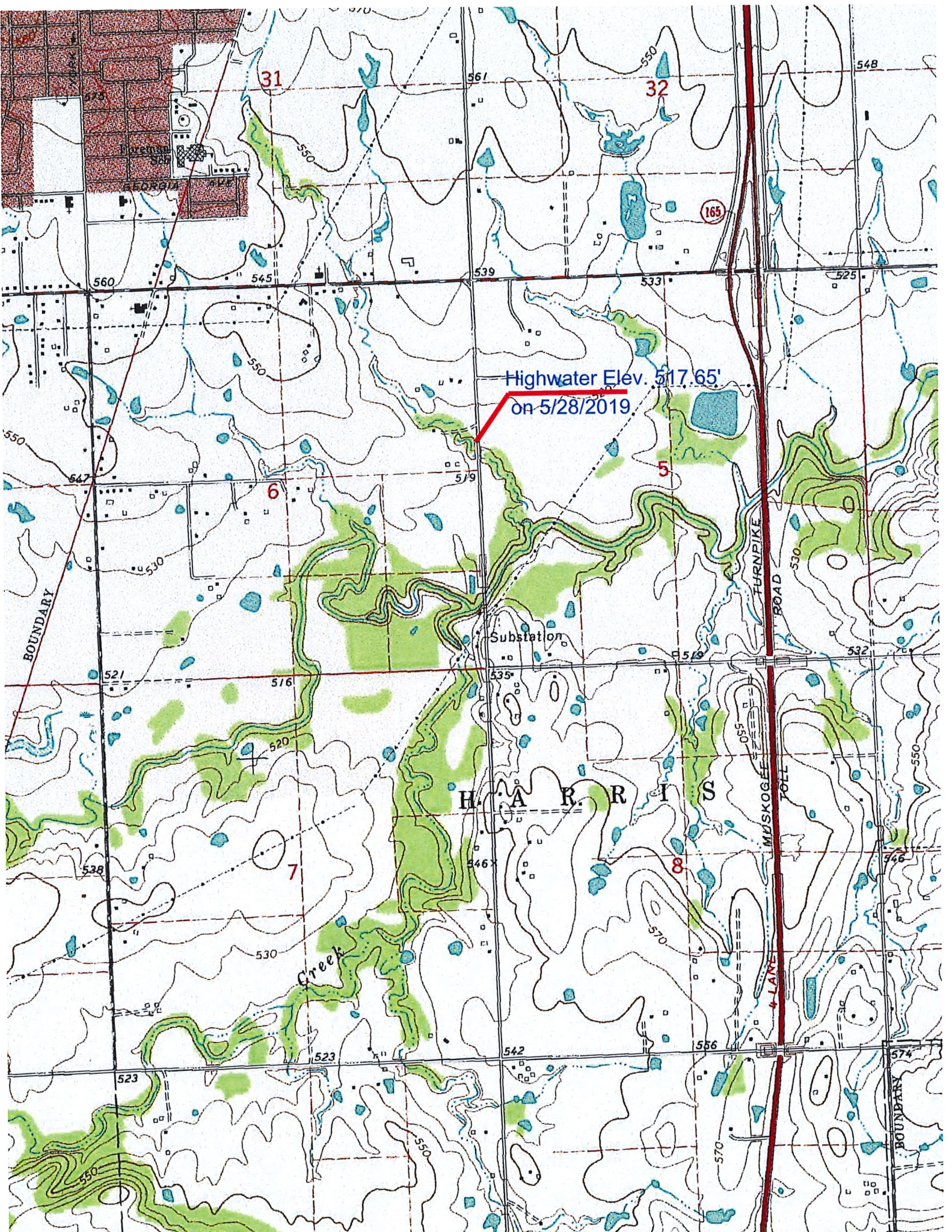

Highwater Elev. 517.65'  
on 5/28/2019

BOUNDARY

HARRIS

Creek

Substation

MUSKOGEE TOLL ROAD  
TURNPIKE ROAD

31

32

165

6

5

7

8

BOUNDARY