



**OKLAHOMA DEPARTMENT OF TRANSPORTATION
SURVEY DIVISION**

FLOOD INFORMATION FORM

Division #:	1 <input checked="" type="checkbox"/> 2 <input type="checkbox"/> 3 <input type="checkbox"/> 4 <input type="checkbox"/> 5 <input type="checkbox"/> 6 <input type="checkbox"/> 7 <input type="checkbox"/> 8 <input type="checkbox"/>
County:	Muskogee
Date Highwater occurred:	5/28/2019
Highway Number:	Elm Grove Road
Name of Stream:	Arkansas River Backwater, Spaniard Creek
Direction and distance from nearest town, or highway junction	From the Jct. of US64 and Elm Grove Rd. 4.0 miles East Near Elm Grove Church at intersection.
Section, Township, Range:	Section 9, T-13N, R-19E
Description of Location:	Elm Grove Road
Highwater Elevation:	503.97'
Level Datum & Source:	NAVD 88, Geoid 12B
Method used:	GPS/OPUS_RS
Date Elevation Obtained:	5/28/2019
Apparent Magnitude:	Normal <input type="checkbox"/> Medium <input type="checkbox"/> Extreme <input checked="" type="checkbox"/> Don't Know <input type="checkbox"/>
Was Highwater Mark obtained from actual water, drift, local resident, or other source?	Drift line and local testimony
Explanatory Remarks:	State Plane Coordinates N: 233257.7913, E: 2774887.4420

Note: Show Vicinity Map on back of form

Name (signature) _____

Name (Printed)

Date: 6/05/2019

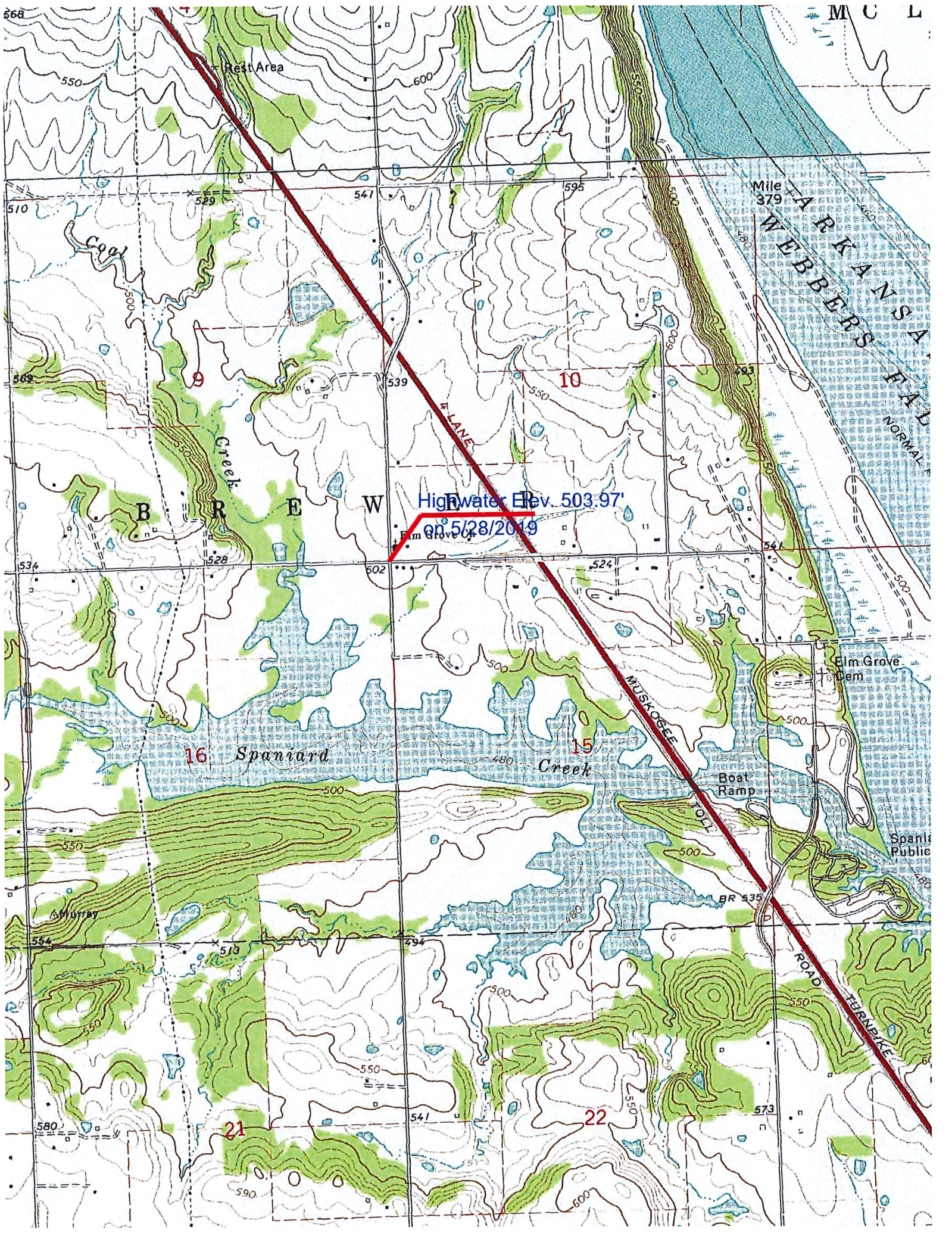

Rest Area

Mile 379
WEBBERS
TARKANS
SAL
NORMAL

High Water Elev. 503.97'
on 5/28/2019

9

10

16 Spaniard

15 Creek

21

22

Elm Grove Dam

Boat Ramp

Spaniard Public

ROAD

TERNEKE

668

M C L

510

562

534

554

580

541

539

602

494

541

595

550

524

494

573

540

493

541

500

BR 535

550

573

FLANE

MUSKOGEE

550

600

550

500

500

500

550

550

590

541

539

602

494

541

590

595

550

524

480

550

600

540

493

541

500

BR 535

550

573

510

562

534

554

580

541

539

602

494

541

595

550

524

494

573

540

493

541

500

BR 535

550

573

510

562

534

554

580

541

539

602

494

541

595

550

524

494

573

540

493

541

500

BR 535

550

573

510

562

534

554

580

541

539

602

494

541

595

550

524

494

573

540

493

541

500

BR 535

550

573

510

562

534

554

580

541

539

602

494

541

595

550

524

494

573

540

493

541

500

BR 535

550

573

510

562

534

554

580

541

539

602

494

541

595

550

524

494

573

540

493

541

500

BR 535

550

573

510

562

534

554

580

541

539

602

494

541

595

550

524

494

573

540

493

541

500

BR 535

550

573

510

562

534

554

580

541

539

602

494

541

595

550

524

494

573

540

493

541

500

BR 535

550

573

510

562

534

554

580

541

539

602

494

541

595

550

524

494

573

540

493

541

500

BR 535

550

573

510

562

534

554

580

541

539

602

494

541

595

550

524

494

573

540

493

541

500

BR 535

550

573

510

562

534

554

580

541

539

602

494

541

595

550

524

494

573

540

493

541

500

BR 535

550

573

510

562

534

554

580

541

539

602

494

541

595

550

524

494

573

540

493

541

500

BR 535

550

573

510

562

534

554

580

541

539

602

494

541

595

550

524

494

573

540

493

541

500

BR 535

550

573

51