

STATE OF OKLAHOMA  
DEPARTMENT OF HIGHWAYS  
SURVEY DIVISION

FLOOD INFORMATION FORM

To be used in obtaining and transmitting flood water elevations for Survey Division office record files. This information to be obtained by all Chiefs of Party or others in their vicinity in times of unusual high water, or at any time available from a reliable source. The elevations can be recorded by level reading, by measurement from bridge floor, in relation to a house, above roadbed or any other dependable, clear manner that fits the situation, the highest order possible to be used. Separate report to be made on each crossing or place obtained.

County Muskogee Date highwater occurred 5/2/1990

Highway number U.S. 69 Name of stream Anderson Creek

Direction and distance from nearest town, village or store Approx. 0.6 miles south of Oktaha.

Section, Township and Range Sec. 27, T13N, R17E

Description of Location First creek south of Oktaha on U.S. 69 By-pass.

Elevation \_\_\_\_\_ Source of levels \_\_\_\_\_

Method obtained Fennel Level Date obtained 5/3/1990

Did it appear to be  normal  medium  extreme  do not know

Was highwater mark obtained from actual water, drift, local resident, U. S. Engineers, etc.? Actual water.

Explanatory Remarks Top of water was down 16.7 from centerline of west parapet wall of west bridge.

Location to be shown on back of this sheet as a check.

Field Note: To be sent to  
Survey Engineer

Jan R. [Signature]  
Professional Land Surveyor

Copy to Bridge Div. 6-19-90 6/13/90  
Date

Copy with map to Bridge 8-9-90 LOCATION No. 4

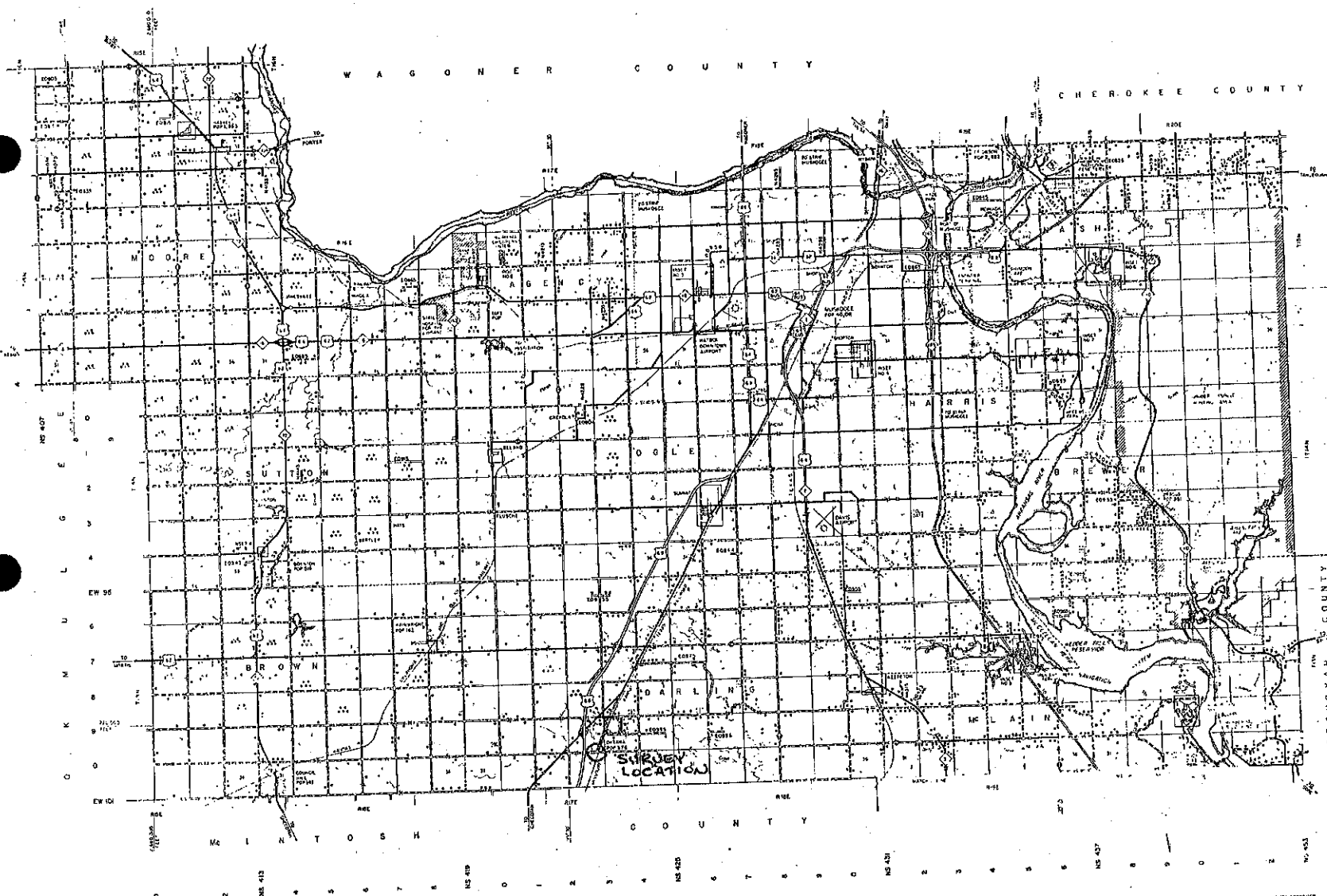

THIS MAP IS ISSUED BY THE STATE OF OKLAHOMA  
 OKLAHOMA DEPARTMENT OF TRANSPORTATION  
 BEFORE STATE BOARD OF PUBLIC UTILITIES  
 UNDER THE SUPERVISION OF THE  
 OKLAHOMA CITY, OKLAHOMA

**NOT FOR RESALE** GENERAL HIGHWAY MAP MUSKOGEE COUNTY OKLAHOMA



51