

STATE OF OKLAHOMA
DEPARTMENT OF HIGHWAYS
SURVEY DIVISION

FLOOD INFORMATION FORM

To be used in obtaining and transmitting flood water elevations for Survey Division office record files. This information to be obtained by all Chiefs of Party or others in their vicinity in times of unusual high water, or at any time available from a reliable source. The elevations can be recorded by level reading, by measurement from bridge floor, in relation to a house, above roadbed or any other dependable, clear manner that fits the situation, the highest order possible to be used. Separate report to be made on each crossing or place obtained.

County Muskogee Date highwater occurred 5/2/1990

Highway number U.S. 64 Name of stream Dirty Creek

Direction and distance from nearest town, village or store Approx. 4 miles north of Warner.

Section, Township and Range Sec 32 T13N R19E

Description of Location Approx. 4 miles north of Warner on U.S. 64 at Dirty Creek.

Elevation _____ Source of levels _____

Method obtained Fennel Level Date obtained 5/3/1990

Did it appear to be normal medium extreme do not know

Was highwater mark obtained from actual water, drift, local resident, U. S. Engineers, etc.? actual water

Explanatory Remarks Top water was down from top parapet wall at SE cor. bridge 12.0.

Location to be shown on back of this sheet as a check.

Field Note: To be sent to
Survey Engineer

Jan R. [Signature]
Professional Land Surveyor

6/13/90
Date

Copy to Bridge Division
Copy with map to Bridge 8-9-90
LOCATION No. 11

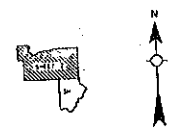
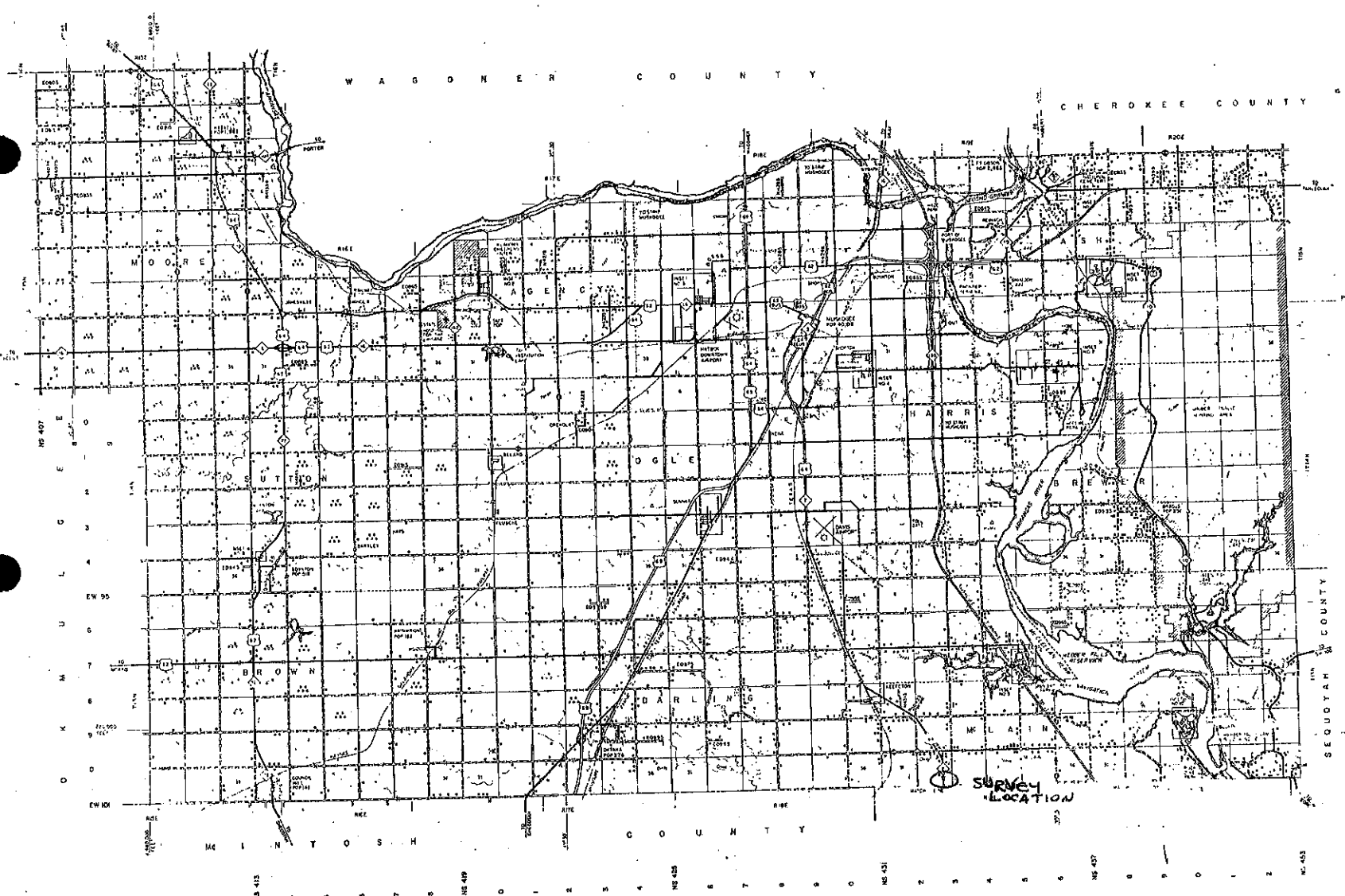

NOT FOR RESALE GENERAL HIGHWAY MAP MUSKOGEE COUNTY OKLAHOMA

ALL RIGHTS RESERVED
 SHEET OF 8 SHEETS
 THE STATE OF OKLAHOMA
 DEPARTMENT OF TRANSPORTATION
 DIVISION OF HIGHWAYS
 TULSA, OKLAHOMA