

STATE OF OKLAHOMA
DEPARTMENT OF HIGHWAYS
SURVEY DIVISION

FLOOD INFORMATION FORM

To be used in obtaining and transmitting flood water elevations for Survey Division office record files. This information to be obtained by all Chiefs of Party or others in their vicinity in times of unusual high water, or at any time available from a reliable source. The elevations can be recorded by level reading, by measurement from bridge floor, in relation to a house, above roadbed or any other dependable, clear manner that fits the situation, the highest order possible to be used. Separate report to be made on each crossing or place obtained.

County Muskogee Date highwater occurred October 5, 1986

Highway number US 62 Name of stream Arkansas River

Direction and distance from nearest town, village or store Approx. 1 mile east of Muskogee, Oklahoma.

Section, Township and Range Section 15, T15N, R19E

Description of Location Approximately 1000' east of the Railroad bridge into the OG&E Plane on US 62.

Elevation 512.3 Source of levels SWO 2820(2)

Method obtained Fennel Level Date obtained October 6, 1986

Did it appear to be normal medium extreme do not know

Was highwater mark obtained from actual water, drift, local resident, U. S. Engineers, etc.? From actual highwater marks and residue.

Explanatory Remarks Water covered the entire west bound lane of U.S. 62 at the low spot and only covered it with 1 inch of water. Traffic was not stopped.

Location to be shown on back of this sheet as a check.

Field Note: To be sent to
Survey Engineer

James Wayne Dugan
Location Engineer

October 9, 1986
Date

LOCATION No. 17

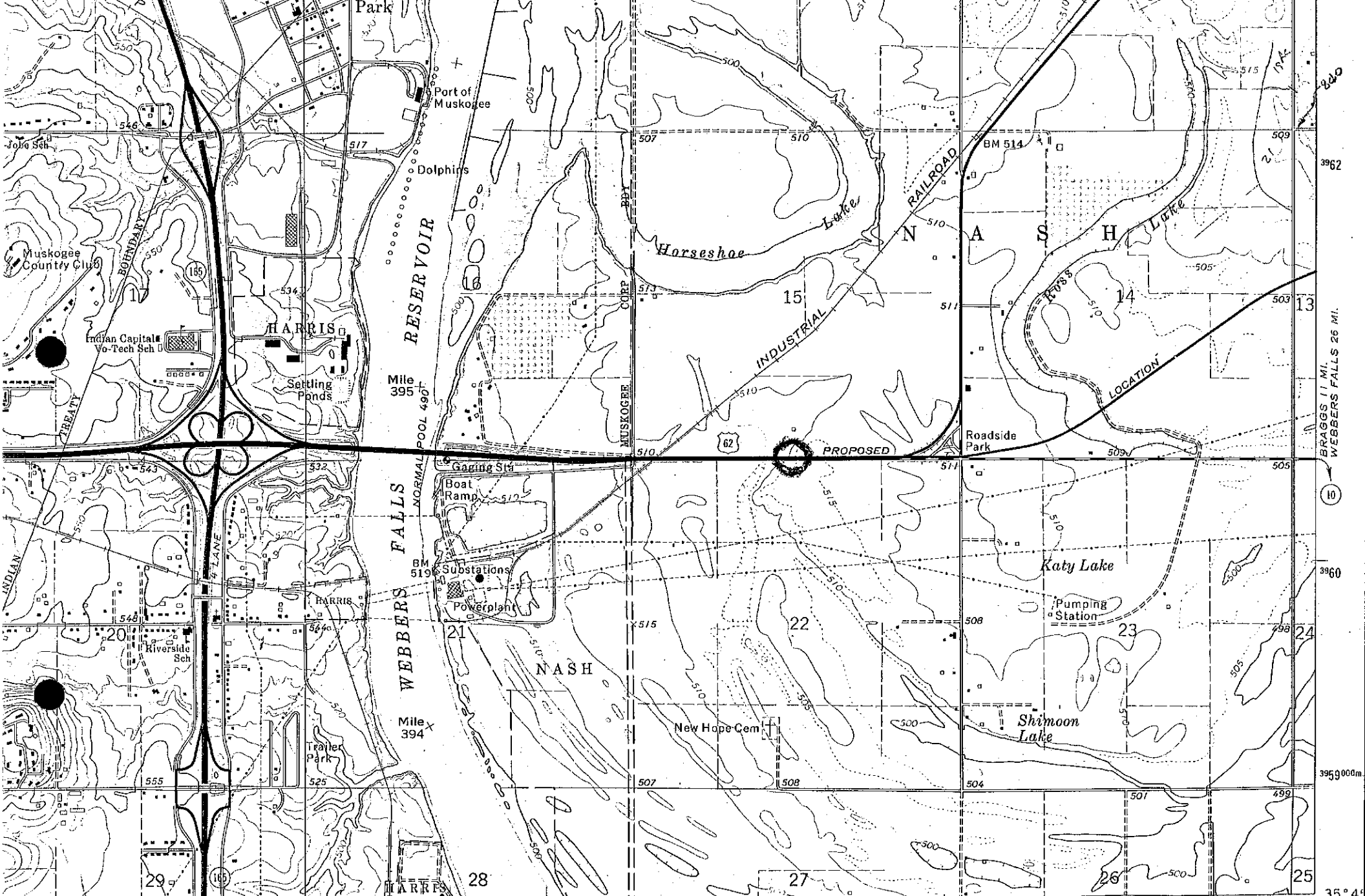

(SOUTHEAST MUSKOGEE) 21 MI. TO INTERSTATE 40 292 17'30" 293 294 295 000m.E. 35° 4' 95° 15'

SCALE 1:24 000

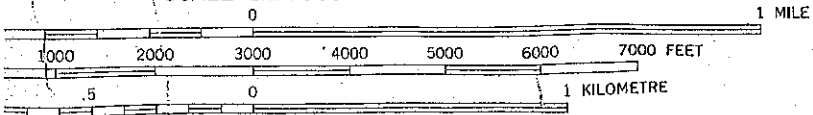

CONTOUR INTERVAL 10 FEET
DOTTED LINES REPRESENT 5-FOOT CONTOURS

ROAD CLASSIFICATION

- Primary highway, hard surface
- Secondary highway, hard surface
- Light-duty road, hard or improved surface
- Unimproved road

- Interstate Route
- U.S. Route
- State Route