

RECEIVED

DEC 4 1986

SURVEY DIVISION

STATE OF OKLAHOMA
DEPARTMENT OF HIGHWAYS
SURVEY DIVISION

Survey Division
Form No. 16
Rev. Dec. 2, 1974

FLOOD INFORMATION FORM

To be used in obtaining and transmitting flood water elevations for Survey Division office record files. This information to be obtained by all Chiefs of Party or others in their vicinity in times of unusual high water, or at any time available from a reliable source. The elevations can be recorded by level reading, by measurement from bridge floor, in relation to a house, above roadbed or any other dependable, clear manner that fits the situation, the highest order possible to be used. Separate report to be made on each crossing or place obtained.

County Muskogee Date highwater occurred October 1, 1986

Highway number SH 10 Name of stream Sulpher Branch

Direction and distance from nearest town, village or store Approx. 3 miles north of Gore, Okla.

Section, Township and Range NE4 NW 4 Section 24, T13N, R20E

Description of Location Located at the crossing on SH 10 approx. 1000' south of the Jct. of SH 10 & SH 10A north of Gore, Oklahoma

Elevation _____ Source of levels _____

Method obtained Fennel Level Date obtained October 6, 1986

Did it appear to be normal medium extreme do not know

Was highwater mark obtained from actual water, drift, local resident, U. S. Engineers, etc.? Water marks and residue from flood.

Explanatory Remarks Water was 2.2 feet deep over top of the concrete slab at this location.

Location to be shown on back of this sheet as a check.

Field Note: To be sent to
Survey Engineer

James Wayne Dyer
Location Engineer

October 9, 1986
Date

LOCATION NO. 22

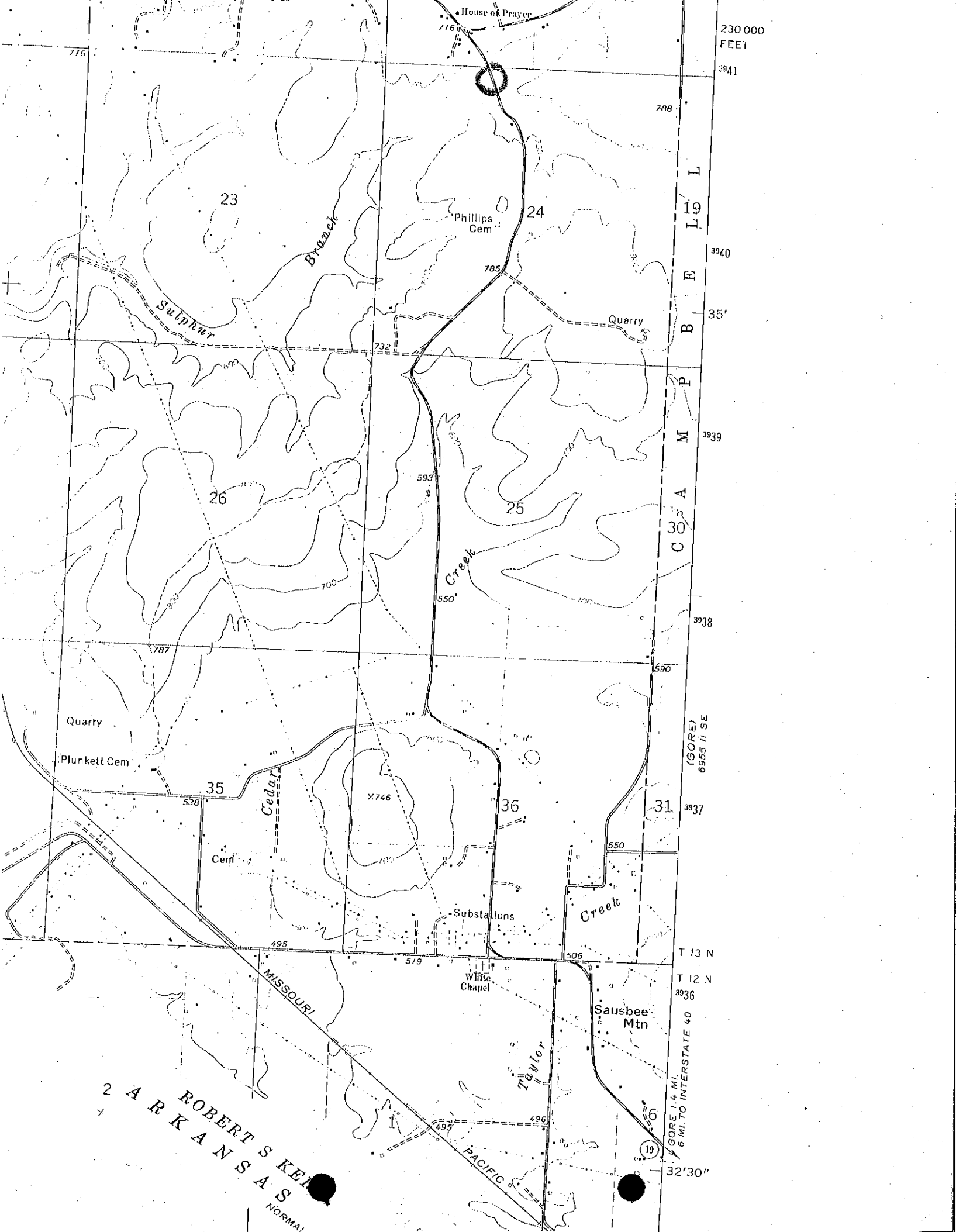

230 000
FEET

3941

788

716

23

24

Phillips
Cem

3940

Branch

Sulphur

Quarry

35'

732

785

30

3939

26

25

Creek

30

593

550

3938

700

787

590

Quarry

Plunkett Cem

35

36

Cedar

X746

31

(GORE)
6955 1/2 SE

539

Cem

3937

700

Substations

Creek

550

T 13 N

MISSOURI

White
Chapel

T 12 N

495

519

506

3936

Sausbee
Mtn

2 A R K A N S A S
ROBERT S KEIL
NORMAL

Taylor

495

PACIFIC

GORE 1/4 MI
6 MI. TO INTERSTATE 40

6

10

32'30"