

RECEIVED  
DEC 4 1986  
SURVEY DIVISION

STATE OF OKLAHOMA  
DEPARTMENT OF HIGHWAYS  
SURVEY DIVISION

Survey Division  
Form No. 16  
Rev. Dec. 2, 1974

FLOOD INFORMATION FORM

To be used in obtaining and transmitting flood water elevations for Survey Division office record files. This information to be obtained by all Chiefs of Party or others in their vicinity in times of unusual high water, or at any time available from a reliable source. The elevations can be recorded by level reading, by measurement from bridge floor, in relation to a house, above roadbed or any other dependable, clear manner that fits the situation, the highest order possible to be used. Separate report to be made on each crossing or place obtained.

County Muskogee Date highwater occurred October 1, 1986

Highway number SH 10 Name of stream South Fork Cedar Creek

Direction and distance from nearest town, village or store 0.7 mile north and 1.5 miles east of the Webbers Falls Lock and Dam

Section, Township and Range NW NW Section 36, T13N, R20E.

Description of Location Located approx. 2.7 miles north of Gore on SH 10

Elevation See note below Source of levels \_\_\_\_\_

Method obtained Fennel Level Date obtained October 6, 1986

Did it appear to be  normal  medium  extreme  do not know

Was highwater mark obtained from actual water, drift, local resident, U. S. Engineers, etc.? Actual highwater marks and residue.

Explanatory Remarks Water was 1.5 foot higher than the top of the west headwall of the new 2-10X RCB.

Location to be shown on back of this sheet as a check.

Field Note: To be sent to  
Survey Engineer

*James Wayne Brown*  
Location Engineer

October 9, 1986  
Date

LOCATION No. 28

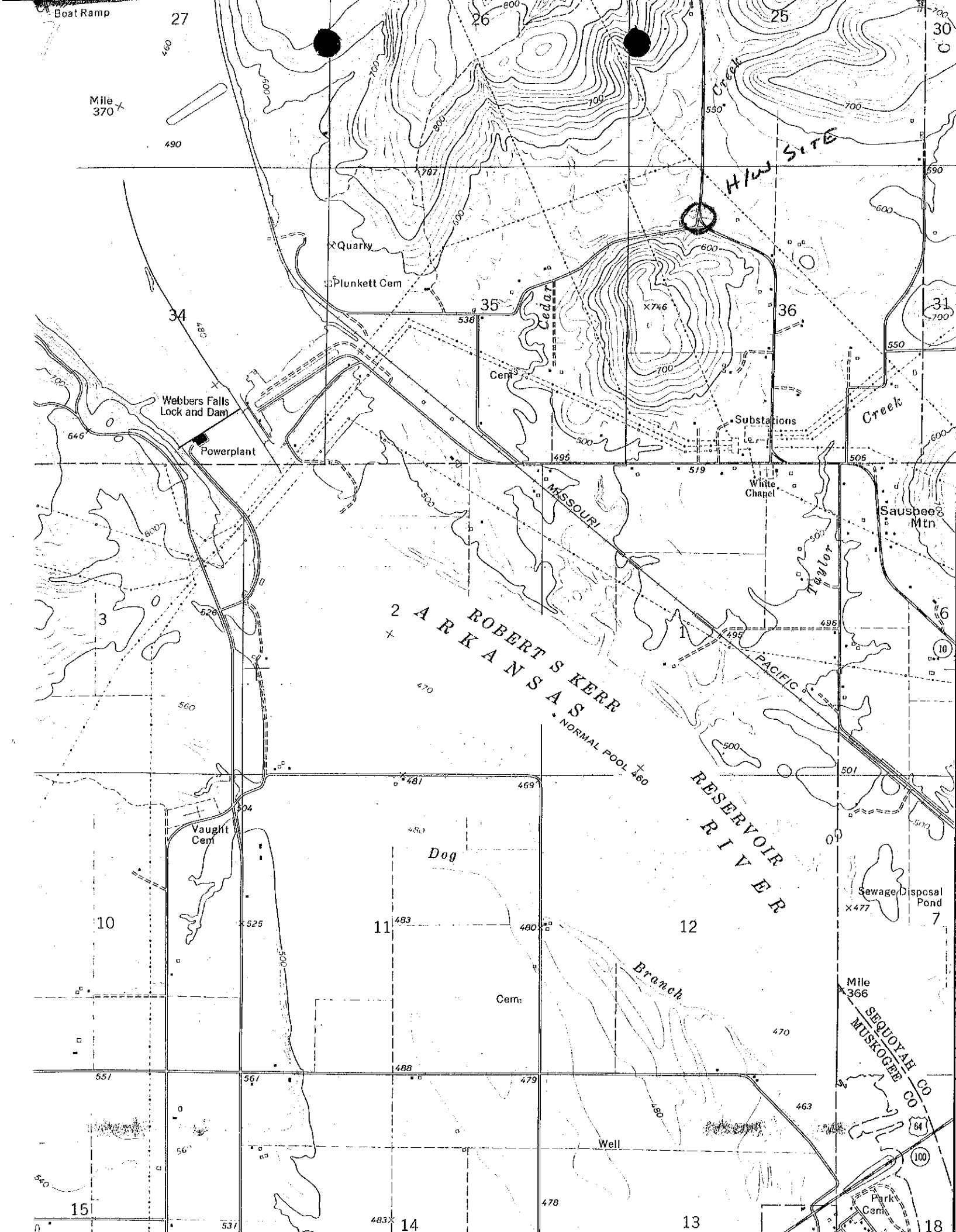

Boat Ramp

27

460

Mile 370

490

34

Webbers Falls Lock and Dam

Powerplant

Quarry

Plunkett Cem

35

Cedar Creek

Cem

H/W SITE

36

Substations

White Chapel

Creek

Sausbee Mtn

ROBERT S KERR  
ARKANSAS  
NORMAL POOL

RESERVOIR  
RIVER

10

Vaught Cem

Dog

11

Cem

12

Branch

Sewage Disposal Pond

SEQUOYAH CO  
MUSKOGEE CO

Mile 366

100

15

540

537

483

14

478

Well

13

18

Part Cem