

STATE OF OKLAHOMA
DEPARTMENT OF HIGHWAYS
SURVEY DIVISION

FLOOD INFORMATION FORM

To be used in obtaining and transmitting flood water elevations for Survey Division office record files. This information to be obtained by all Chiefs of Party or others in their vicinity in times of unusual high water, or at any time available from a reliable source. The elevations can be recorded by level reading, by measurement from bridge floor, in relation to a house, above roadbed or any other dependable, clear manner that fits the situation, the highest order possible to be used. Separate report to be made on each crossing or place obtained.

County Muskogee Date highwater occurred 5/2/1990

Highway number U.S. 64 Name of stream unknown

Direction and distance from nearest town, village or store north edge of Keifton

Section, Township and Range Sec 24 T13N R18E

Description of Location On U.S. 64 in curve at north edge of Keifton.

Elevation _____ Source of levels _____

Method obtained Fennel Level Date obtained 5/3/90

Did it appear to be normal medium extreme do not know

Was highwater mark obtained from actual water, drift, local resident, U. S. Engineers, etc.? drift

Explanatory Remarks Visible drift was up 1.1 from top hdwl. on 4'x4' R.C.B. but did not get over the road.

Location to be shown on back of this sheet as a check.

Field Note: To be sent to
Survey Engineer

Jon R. [Signature]
Professional Land Surveyor

Copy to Bridge Div. 6-19-90

6/13/90
Date

Copy with map to Bridge 8-9-90 LOCATION NO. 37

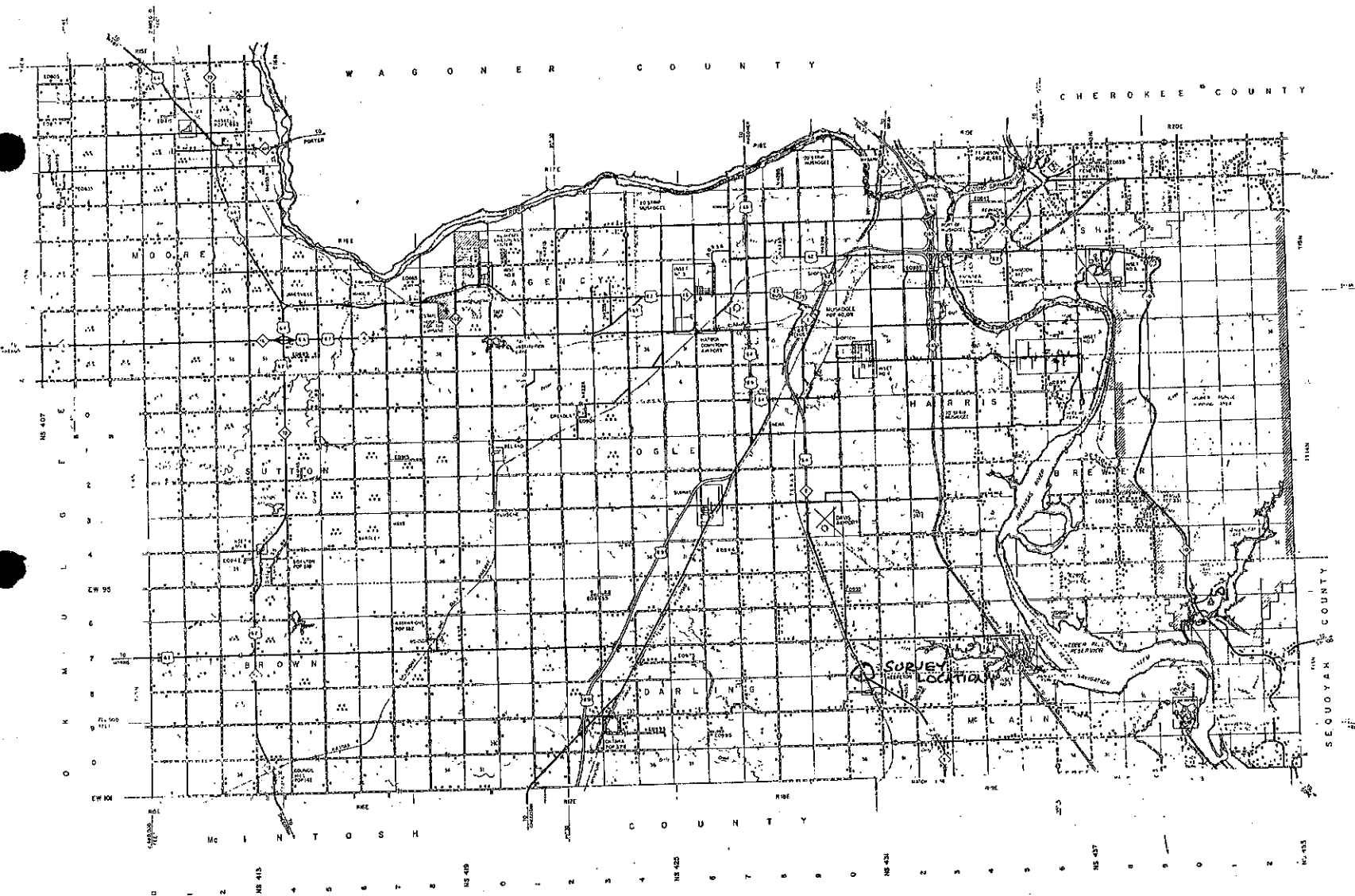

NOT FOR RESALE GENERAL HIGHWAY MAP MUSKOGEE COUNTY