



OKLAHOMA DEPARTMENT OF TRANSPORTATION
SURVEY DIVISION

FLOOD INFORMATION FORM

Division #:	1 <input type="checkbox"/> 2 <input type="checkbox"/> 3 <input type="checkbox"/> 4 <input type="checkbox"/> 5 <input type="checkbox"/> 6 <input type="checkbox"/> 7 X 8 <input type="checkbox"/>
County:	Murray
Date Highwater occurred:	Spring of 2015
Highway Number:	U.S. 77
Name of Stream:	Honey Creek
Direction and distance from nearest town, or highway junction	From The Intersection of U.S.77 and I-35 South of Davis. Take U.S. 77 Southwesterly for One Mile to Bridge.
Section, Township, Range:	Section 30, T-1-S, R-2-E
Description of Location:	Sta. 504+17 on FAP134-C,D,E,F
Highwater Elevation:	827.612'
Level Datum & Source:	NAVD 88 from SWO4189(1) J/P 20303(04) Survey. S.D.11 M-50-383 Established control Elev.=820.5038'
Method used:	Leica GPS 1200 RTK
Date Elevation Obtained:	10/26/2015
Apparent Magnitude:	Normal <input type="checkbox"/> Medium <input type="checkbox"/> Extreme X Don't Know <input type="checkbox"/>
Was Highwater Mark obtained from actual water, drift, local resident, or other source?	Highwater information was obtained by Ada Survey Field Crew. By Locating Brush and Debris in Fence Line. FAP134 plans state the Highwater was 821.21 feet, but it has exceeded that this year and now is 827.61 feet.
Explanatory Remarks:	Heavy rains in upper drainage area

Note: Show Vicinity Map on back of form

Name (signature) 
Name (Printed) DARREL RAY MASON
Date: 10/26/2015

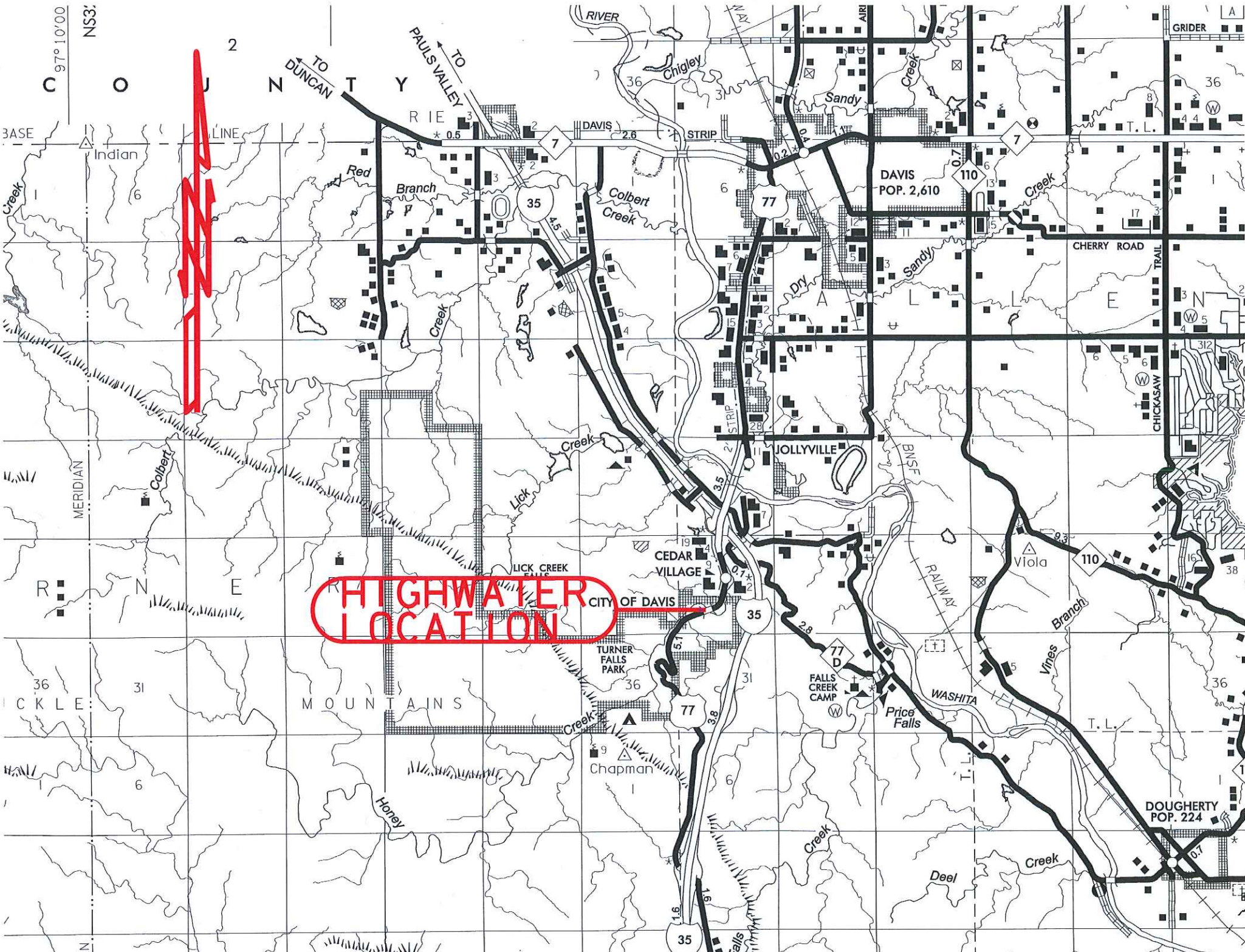

HIGHWATER
LOCATION

CITY OF DAVIS

FALLS CREEK CAMP

Price Falls

DOUGHERTY
POP. 224

DAVIS
POP. 2,610

77

35

110

35

77

39

Chapman

35

Falls

Creek

Creek

WASHITA

Vines Branch

RAILWAY

BNSF

JOLLYVILLE

77

DAVIS
POP. 2,610

CHERRY ROAD

CHICKASAW

TRAIL

312

4

17

8

36

GRIDER

A

T. L.

T. L.

38

Viola

9.3

6

5

6

3

4

13

15

7

0.7

2

2

2

6

3

2

2

2

1

1

1

2

1

1

1

2

1

1

1

2

1

1

1

2

1

1

1

2

1

1

1

2

1

1

1

2

1

1

1

2

1

1

1

2

1

1

1

2

1

1

1

2

1

1

1

2

1

1

1

BASE

LINE

Indian

6

6

6

6

6

6

6

6

6

6

6

6

6

6

6

6

6

6

6

6

6

97° 10' 00"

NS33'

TO DUNCAN

TO PAULS VALLEY

TO AIR

TO GRIDER

TO CHICKASAW

TO WASHITA

TO VINES

TO PRICE FALLS

TO DOUGHERTY

TO DEEL

TO CHAPMAN

TO TURNER FALLS

TO CEDAR VILLAGE

TO JOLLYVILLE

TO DAVIS

TO RED BRANCH

TO COLBERT

TO SANDY

TO CHIGLEY

TO RIVER

TO HONEY

TO LICK

TO VIOLA

TO WASHITA

TO VINES

TO PRICE FALLS

TO DOUGHERTY

TO DEEL

TO CHAPMAN

TO TURNER FALLS

TO CEDAR VILLAGE

TO JOLLYVILLE

TO DAVIS

TO RED BRANCH

TO COLBERT

TO SANDY

TO CHIGLEY

TO RIVER

TO HONEY

TO LICK

TO VIOLA

TO WASHITA

TO VINES

TO PRICE FALLS

TO DOUGHERTY

TO DEEL

TO CHAPMAN

TO TURNER FALLS

TO CEDAR VILLAGE

TO JOLLYVILLE

TO DAVIS

TO RED BRANCH

TO COLBERT

TO SANDY

TO CHIGLEY

TO RIVER

TO HONEY

TO LICK

TO VIOLA

TO WASHITA

TO VINES

TO PRICE FALLS

TO DOUGHERTY

TO DEEL

TO CHAPMAN

TO TURNER FALLS

TO CEDAR VILLAGE

TO JOLLYVILLE

TO DAVIS

TO RED BRANCH

TO COLBERT

TO SANDY

TO CHIGLEY

TO RIVER

TO HONEY

TO LICK

TO VIOLA

TO WASHITA

TO VINES

TO PRICE FALLS

TO DOUGHERTY

TO DEEL

TO CHAPMAN

TO TURNER FALLS

TO CEDAR VILLAGE

TO JOLLYVILLE

TO DAVIS

TO RED BRANCH

TO COLBERT

TO SANDY

TO CHIGLEY

TO RIVER

TO HONEY

TO LICK

TO VIOLA

TO WASHITA

TO VINES

TO PRICE FALLS

TO DOUGHERTY

TO DEEL

TO CHAPMAN

TO TURNER FALLS

TO CEDAR VILLAGE

TO JOLLYVILLE

TO DAVIS

TO RED BRANCH

TO COLBERT

TO SANDY

TO CHIGLEY

TO RIVER

TO HONEY

TO LICK

TO VIOLA

TO WASHITA

TO VINES

TO PRICE FALLS

TO DOUGHERTY

TO DEEL

TO CHAPMAN

TO TURNER FALLS

TO CEDAR VILLAGE

TO JOLLYVILLE

TO DAVIS

TO RED BRANCH

TO COLBERT

TO SANDY

TO CHIGLEY

TO RIVER

TO HONEY

TO LICK

TO VIOLA

TO WASHITA

TO VINES

TO PRICE FALLS

TO DOUGHERTY

TO DEEL

TO CHAPMAN

TO TURNER FALLS

TO CEDAR VILLAGE

TO JOLLYVILLE

TO DAVIS

TO RED BRANCH

TO COLBERT

TO SANDY

TO CHIGLEY

TO RIVER

TO HONEY

TO LICK

TO VIOLA

TO WASHITA

TO VINES

TO PRICE FALLS

TO DOUGHERTY

TO DEEL

TO CHAPMAN

TO TURNER FALLS

TO CEDAR VILLAGE

TO JOLLYVILLE

TO DAVIS

TO RED BRANCH

TO COLBERT

TO SANDY

TO CHIGLEY

TO RIVER

TO HONEY

TO LICK

TO VIOLA

TO WASHITA

TO VINES

TO PRICE FALLS

TO DOUGHERTY

TO DEEL

TO CHAPMAN

TO TURNER FALLS

TO CEDAR VILLAGE

TO JOLLYVILLE

TO DAVIS

TO RED BRANCH

TO COLBERT

TO SANDY

TO CHIGLEY

TO RIVER

TO HONEY

TO LICK

TO VIOLA

TO WASHITA

TO VINES

TO PRICE FALLS

TO DOUGHERTY

TO DEEL

TO CHAPMAN

TO TURNER FALLS

TO CEDAR VILLAGE

TO JOLLYVILLE

TO DAVIS

TO RED BRANCH

TO COLBERT

TO SANDY

TO CHIGLEY

TO RIVER

TO HONEY

TO LICK

TO VIOLA

TO WASHITA

TO VINES

TO PRICE FALLS

TO DOUGHERTY

TO DEEL

TO CHAPMAN