

STATE OF OKLAHOMA
DEPARTMENT OF HIGHWAYS
PLANS AND SURVEY DEPARTMENT

FLOOD INFORMATION FORM

To be used in obtaining and transmitting flood water elevations for Plans & Survey office record files. This information to be obtained by all Chiefs of Party in their vicinity in times of unusual high water, or at any time available from a reliable source. The elevations can be recorded by level reading, by measurement from bridge floor, in relation to a house, above roadbed or any other dependable, clear manner that fits the situation, the highest order possible to be used. Separate report to be made on each crossing or place obtained.

County MURRAY Date highwater occurred May 10, 1950

Highway number S.H. 7C Name of stream Waskita River

Direction and distance from nearest town, village or store 1/2 Mile West of Dougherty

Section, Township and Range Sec 11 T-2-S R-2-E

Description of Location At the Waskita River where S.H. 7C crossed West of Dougherty before washout of May 10, 1950

Method obtained Level Shots

Elevation 767.50 ✓ Source of levels U.S. C&G.S. - S. No. 1456 (1)

Was highwater mark obtained from actual water, drift, local resident, U. S. Engineers, etc? H.W. was obtained from Shots on Drift & from information of local residents.

Explanatory Remarks The entire Waskita River Bridge has washed out by Flood of May 10, 1950

Location to be shown on back of this sheet as a check.

Field Note: To be sent to Engr. of Plans & Survey (1 copy).
Office Note: To be filed in Flood Information by Counties.

C. S. WORTHAM, Chief of Party
Ass't. Engr. of Plans & Surveys

May 24, 1950
Date

T 2 S

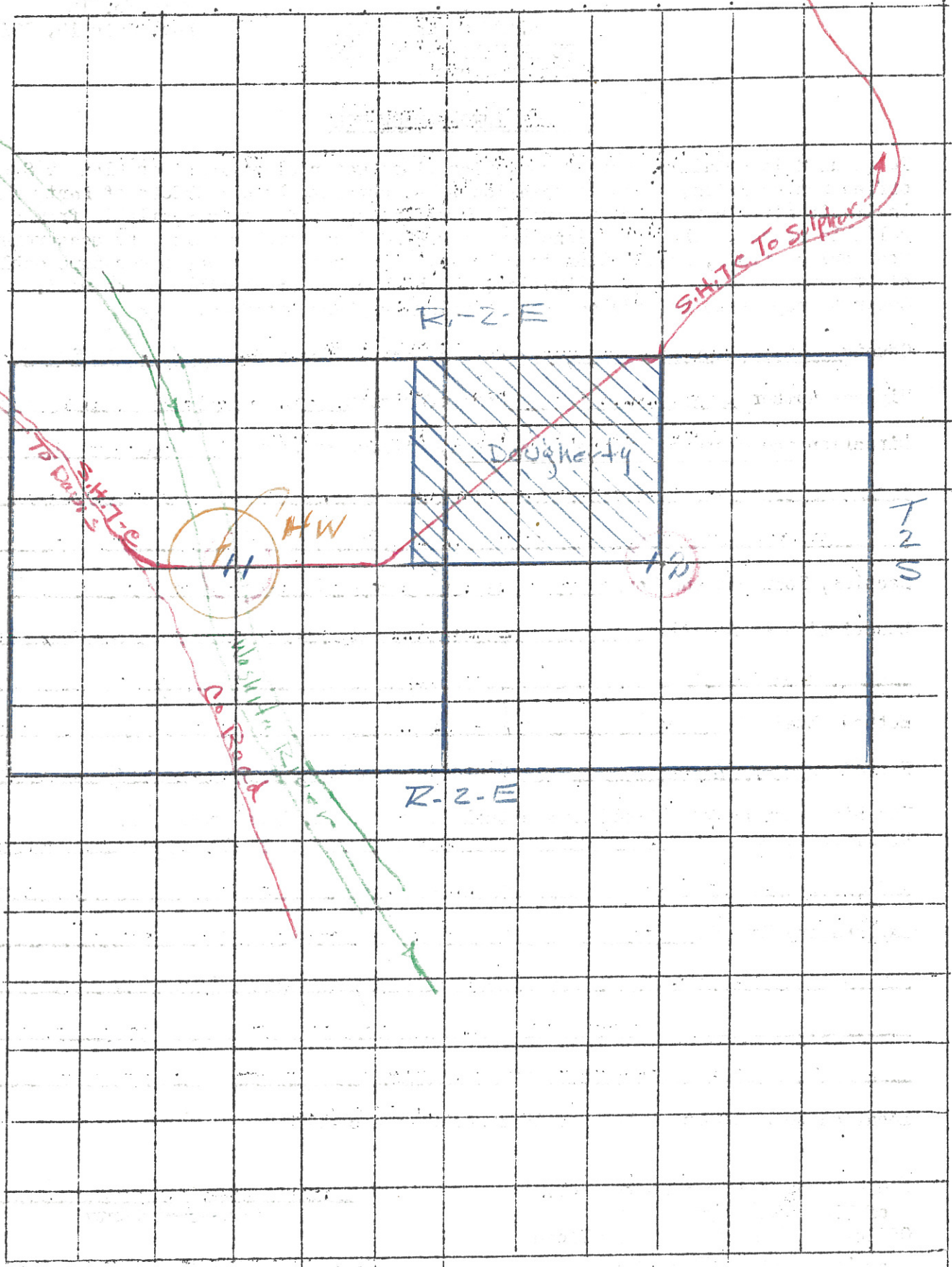

T 2 S