

~~File in Co File on 4~~
File in HW Informa.
Murray Co.

Plans & Survey Dept.
Form No. 16
Rev. July 10, 1947

STATE OF OKLAHOMA
DEPARTMENT OF HIGHWAYS
PLANS AND SURVEY DEPARTMENT

FLOOD INFORMATION FORM

To be used in obtaining and transmitting flood water elevations for Plans & Survey office record files. This information to be obtained by all Chiefs of Party in their vicinity in times of unusual high water, or at any time available from a reliable source. The elevations can be recorded by level reading, by measurement from bridge floor, in relation to a house, above roadbed or any other dependable, clear manner that fits the situation, the highest order possible to be used. Separate report to be made on each crossing or place obtained.

County MURRAY Date highwater occurred SEPT. 1965

Highway number US 77 Name of stream WASHITA RIVER

Direction and distance from nearest town, village or store AT THE WASHITA RIVER BRIDGE APPROX. 3 MILES SOUTH OF DAVIS ON US 77 HIGHWAY.

Section, Township and Range SEC. 19 T-1-S R-1-E

Description of Location Below North End of US 77 River Bridge

Method obtained Y-LEVEL AT THE NORTH END OF OF THE WASHITA RIVER BRIDGE.

Elevation 775.5 Source of levels Y-LEVEL

Was highwater mark obtained from actual water, drift, local resident, U. S. Engineers, etc? ---ACTUAL WATER.

Explanatory Remarks NOTE: THIS IS NOT EXTREME HIGHWATER. EXTREME HIGHWATER ELEVATION 795.5 OCCURED IN 1957.

Location to be shown on back of this sheet as a check.

Field Note: To be sent to Engr. of Plans & Survey (1 copy).
Office Note: To be filed in Flood Information by Counties.

Arnold R. Irwin
Chief of Party
Oct 26, 1965
Date

OCT 26 1965
SURVEY DIVISION

LOCATION NO 2

WATER SURVEYING

NOT TO SCALE AND SHOWS ONLY THE GENERAL POSITION OF THE POINTS AND NOT THE EXACT LOCATION

R.I.E.

R.I.E.

T
I
N

T
I
S

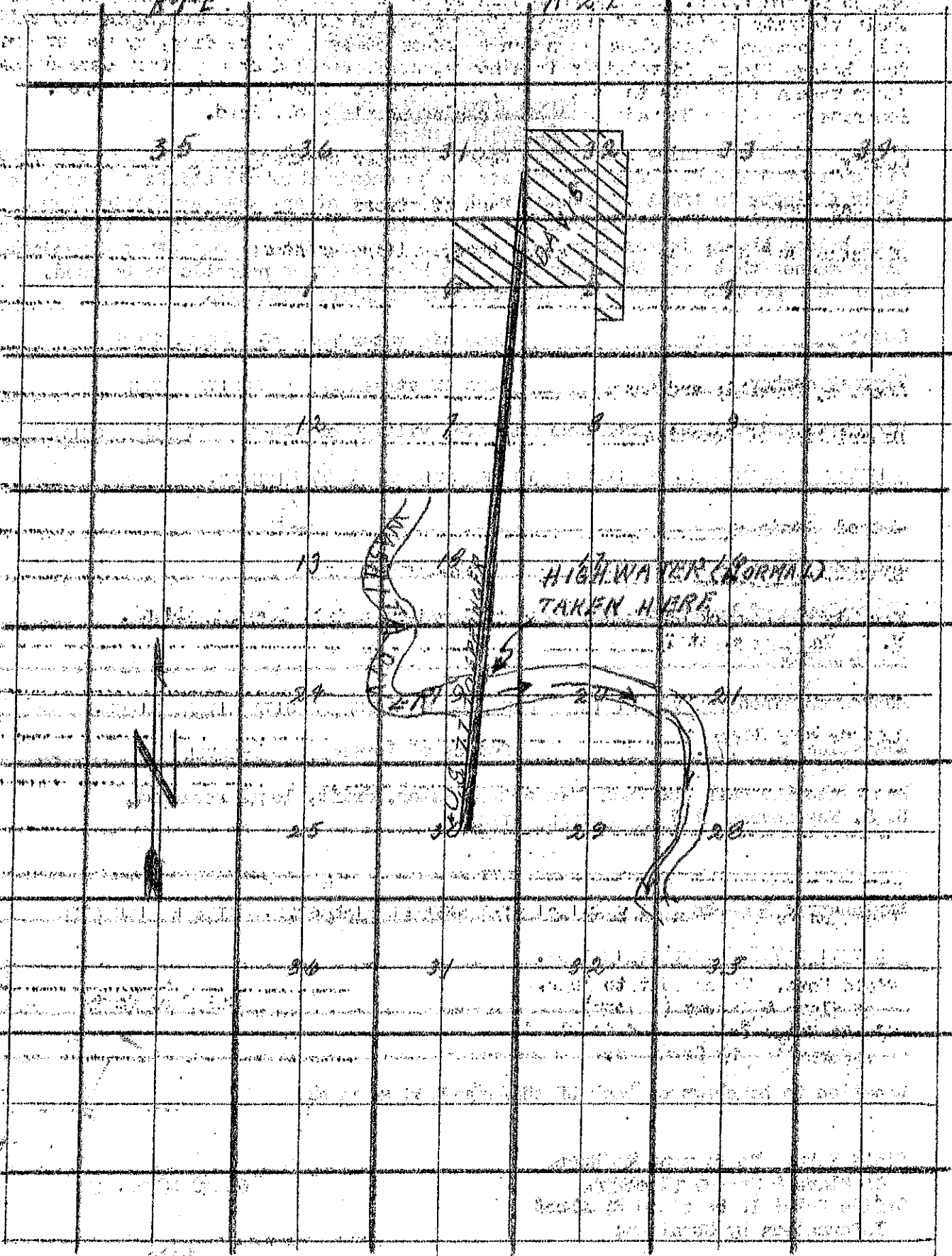

HIGH WATER (NORMAL)
TAKEN HERE

