

STATE OF OKLAHOMA
DEPARTMENT OF HIGHWAYS
PLANS AND SURVEY DEPARTMENT

FLOOD INFORMATION FORM

To be used in obtaining and transmitting flood water elevations for Plans & Survey office record files. This information to be obtained by all Chiefs of Party in their vicinity in times of unusual high water, or at any time available from a reliable source. The elevations can be recorded by level reading, by measurement from bridge floor, in relation to a house, above roadbed or any other dependable, clear manner that fits the situation, the highest order possible to be used. Separate report to be made on each crossing or place obtained.

County Mayes Date highwater occurred October 4, 1959

Highway number US 69 Name of stream Pryor Creek

Direction and distance from nearest town, village or store On US 69, approximately one mile south of Pryor.

Section, Township and Range Sec 24, T-21-N, R-18-E And Sec. 19, T-21-N, R-19-E.

Description of Location On present US 69, approximately one mile south of Pryor at Pryor Creek concrete and steel truss bridge.

Method obtained Field Observation
4.9 Ft. below centerline BM - Centerline Conc Floor & Pav.
Elevation concrete floor and Pav, Source of levels North end Conc. & Steel Bridge on North end Steel Truss Bridge.
Pryor Creek & US 69.

Was highwater mark obtained from actual water, drift, local resident, U. S. Engineers, etc? From water and silt marks left on bridge and etc. on Oct. 5, 1959 after water had recedeed some.

Explanatory Remarks Hi-water elevation obtained in the field on Oct. 5, 1959 by Rees Day Moran, Jr., Chief of Party and Gale Buck McMurphy, Rodman.
Water covered the present US 69 paving, north of the overflow bridge in place north of the main Pryor Creek Steel Truss bridge. No damage done to paving, however road sholders slightly washed. Blocked traffic for one day, Oct. 4, 1959.

Location to be shown on back of this sheet as a check.

Field Note: To be sent to Engr.
of Plans & Survey (1 copy).
Office Note: To be filed in Flood
Information by Counties.

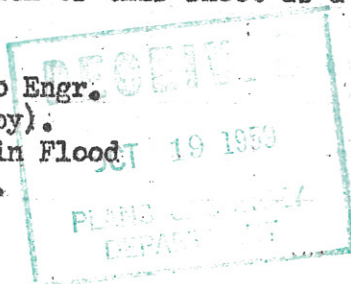

Rees Day Moran, Jr.
Chief of Party

October 12, 1959
Date

LOCATION NO. 1

R-18-E

R-19-E

T
21
N

T
20
N

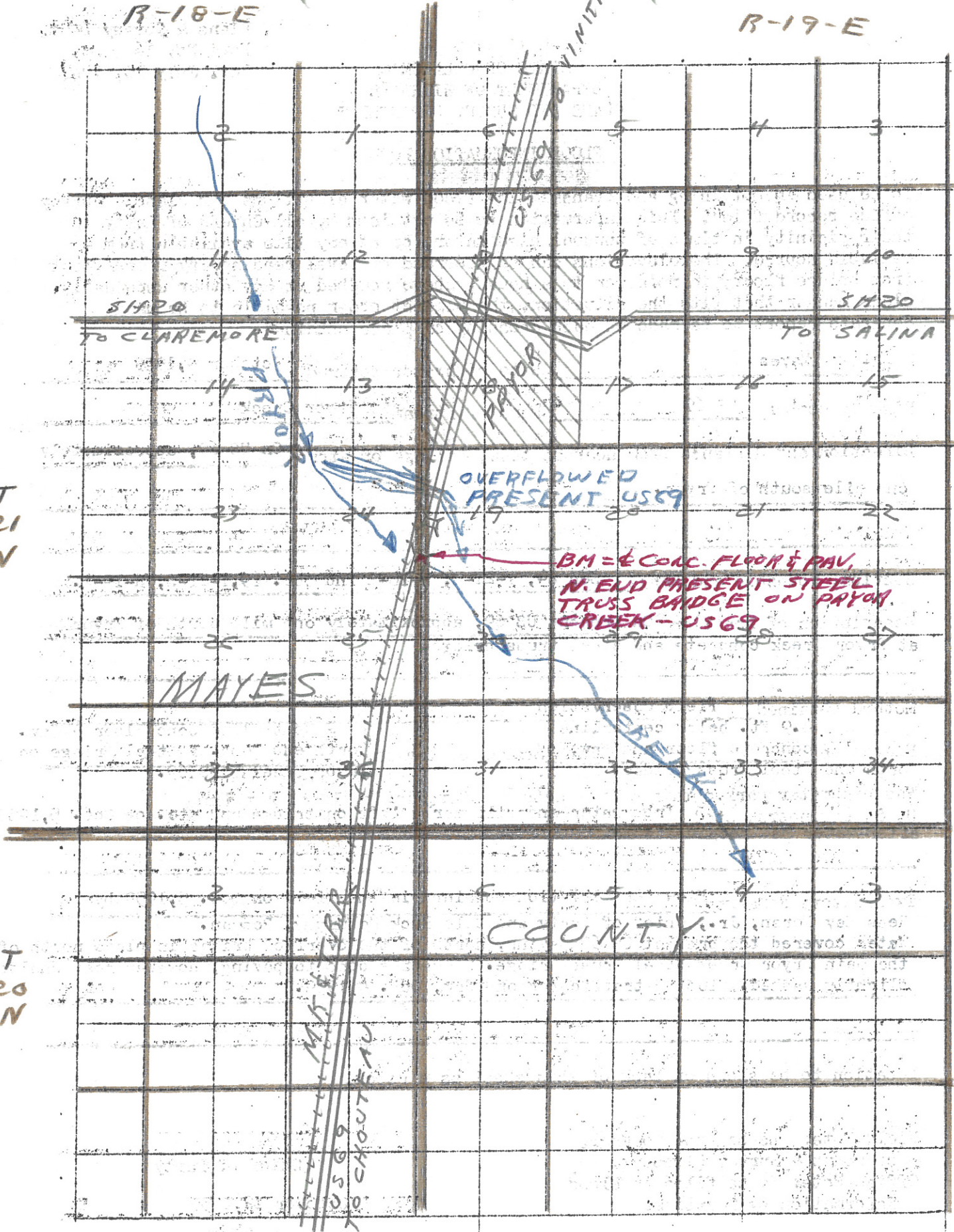

SH20
TO CLAREMORE

SH20
TO SALINA

OVERFLOWED
PRESENT US69

BM = 1/2 CONC. FLOOR & PAV.
N. END PRESENT STEEL
TRUSS BRIDGE ON PAYOR
CREEK - US69

MAYES

COUNTY

US69
TO CHOUTEAU

US69
TO VINITA