

STATE OF OKLAHOMA
DEPARTMENT OF HIGHWAYS
PLANS AND SURVEY DEPARTMENT

FLOOD INFORMATION FORM

To be used in obtaining and transmitting flood water elevations for Plans & Survey office record files. This information to be obtained by all Chiefs of Party in their vicinity in times of unusual high water, or at any time available from a reliable source. The elevations can be recorded by level reading, by measurement from bridge floor, in relation to a house, above roadbed or any other dependable, clear manner that fits the situation, the highest order possible to be used. Separate report to be made on each crossing or place obtained.

County Mayes Date highwater occurred October 4, 1959

Highway number SH 20 Name of stream Pryor Creek

Direction and distance from nearest town, village or store One mile west of Pryor on SH 20

Section, Township and Range Between Sec's 11 & 14, T-21-N, R-18-E

Description of Location At Main Pryor Creek Bridge on SH 20 West of Pryor

Method obtained Field Observation

Elevation 5.6 Ft. below West end concrete Floor & Pav Pryor Creek Main Bridge. Source of levels BM = Centerline Concrete Floor, West end, Pryor Creek Bridge in Place. on SH 20.

Was highwater mark obtained from actual water, drift, local resident, U. S. Engineers, etc? From water and silt marks left on bridge and etc. on Oct. 5, 1959 after water had receded some.

Explanatory Remarks Hi-Water elevation obtained in the field on Oct. 5, 1959 by Rees Day Moran, Jr., Chief of Party and Gale Buck McMurphy, Rodman. SH 20 was not closed to traffic.

Location to be shown on back of this sheet as a check.

Field Note: To be sent to Engr. of Plans & Survey (1 copy).

Office Note: To be filed in Flood Information by Counties.

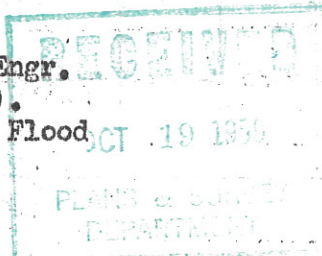

Rees Day Moran, Jr.
Chief of Party

October 17, 1959
Date

LOCATION NO. 2

R-18-E

R-19-E

T
21
N

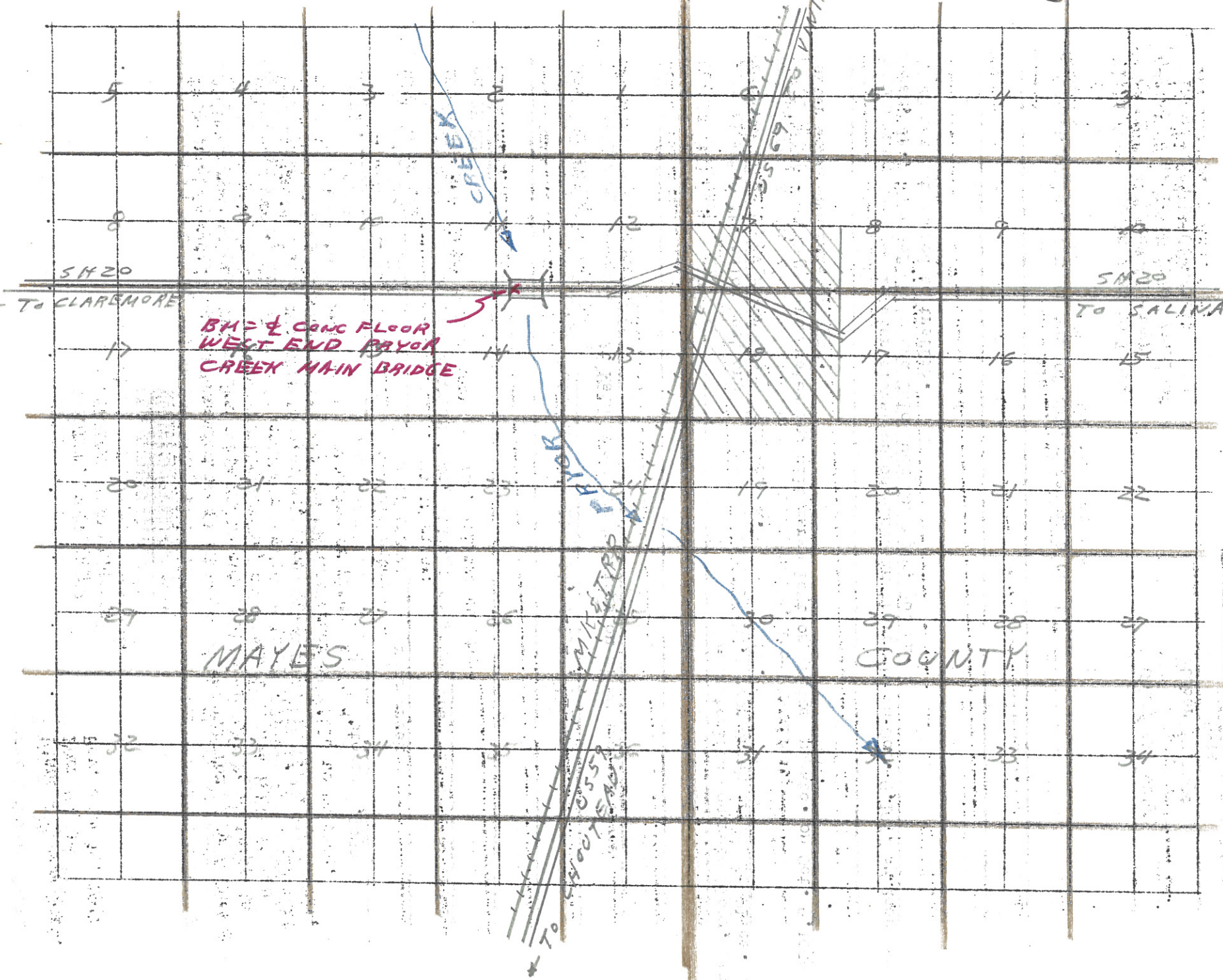

BRIDGE CONC FLOOR
WEST END BAYOR
CREEK MAIN BRIDGE

MAYLE'S

COUNTY

SH 20
TO CLAREMORE

SH 20
TO SALINA

TO CLAREMORE
TO SALINA
TO VINITA
TO GYROUSE
MAYLE'S COUNTY