

STATE OF OKLAHOMA
DEPARTMENT OF HIGHWAYS
SURVEY DIVISION

Survey Division
Form No. 16
Rev. Sept. 10, 1961

FLOOD INFORMATION FORM

To be used in obtaining and transmitting flood water elevations for Survey Division office record files. This information to be obtained by all Chiefs of Party or others in their vicinity in times of unusual high water, or at any time available from a reliable source. The elevations can be recorded by level reading, by measurement from bridge floor, in relation to a house, above roadbed or any other dependable, clear manner that fits the situation, the highest order possible to be used. Separate report to be made on each crossing or place obtained.

County Mayes Date highwater occurred September 18, 1975

Highway number SH 33 & SH 82 Name of stream Road Ditches

Direction and distance from nearest town, village or store At Jct. SH 33 & SH 82 at the east edge of Locust Grove, Oklahoma

Section, Township and Range Section 22, T-20-N, R-20-E

Description of Location At Jct. SH 33 & SH 82 at the east edge of Locust Grove, Oklahoma

Elevation 705.9 Source of levels USC&GS

Method obtained Wye Level Date obtained Sept. 22, 1975

Did it appear to be normal medium extreme do not know

Was highwater mark obtained from actual water, drift, local resident, U. S. Engineers, etc.? Actual drift

Explanatory Remarks Occured after 6 to 8 inch rain. Water covered present SH 33 at this location 0.5' deep.

Location to be shown on back of this sheet as a check.

Field Note: To be sent to
Survey Engineer

James H. Hayes
Chief of Party

Sept. 30, 1975
Date

Location No. 13

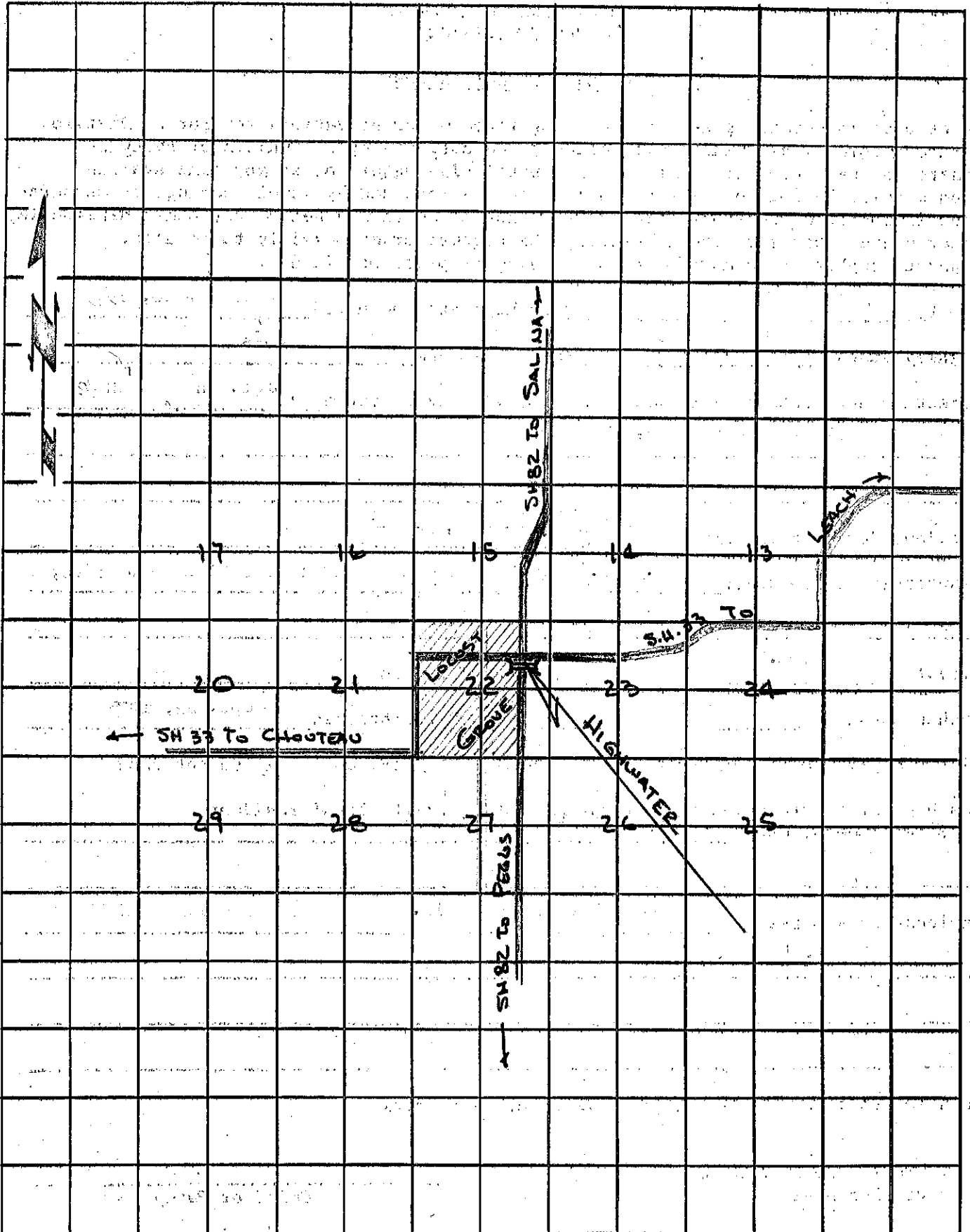

L-202