

STATE OF OKLAHOMA  
DEPARTMENT OF HIGHWAYS  
PLANS AND SURVEY DEPARTMENT

FLOOD INFORMATION FORM

To be used in obtaining and transmitting flood water elevations for Plans & Survey office record files. This information to be obtained by all Chiefs of Party in their vicinity in times of unusual high water, or at any time available from a reliable source. The elevations can be recorded by level reading, by measurement from bridge floor, in relation to a house, above roadbed or any other dependable, clear manner that fits the situation, the highest order possible to be used. Separate report to be made on each crossing or place obtained.

County Mayes Date highwater occurred July 3, 1976

Highway number SH 69-A Name of stream \_\_\_\_\_

Direction and distance from nearest town, village or store In Pryor, Oklahoma  
approx. 1000' south of the Jet. Elliott St. & SH. 20

Section, Township and Range \_\_\_\_\_

Description of Location \_\_\_\_\_

Method obtained Fennell Level

Elevation \_\_\_\_\_ Source of levels \_\_\_\_\_

Was highwater mark obtained from actual water, drift, local resident,  
U. S. Engineers, etc? From water marks on houses.

Explanatory Remarks Water got 0.55 foot higher than the N.W. Corner of  
the concrete step to house No. 9 South Elliot. This occurred after  
9 inch rain that came in 1.5 hours.

Location to be shown on back of this sheet as a check.

Field Note: To be sent to Engr.  
of Plans & Survey (1 copy).  
Office Note: To be filed in Flood  
Information by Counties.

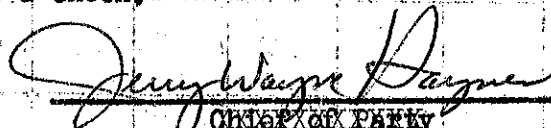
  
CHIEF OF PARTY  
Location Engineer

Date

Location No. 19

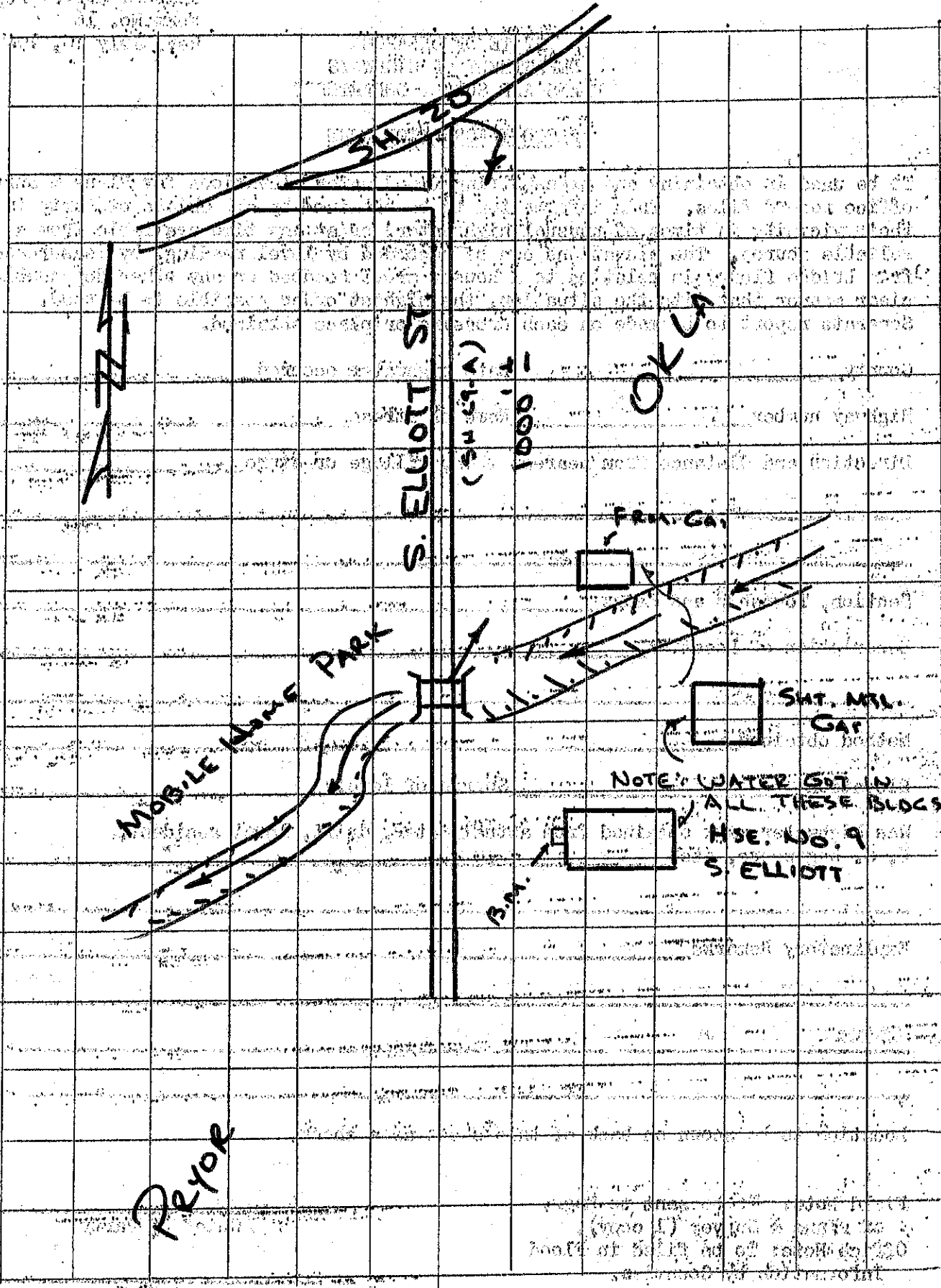

Payor

(Vico 1) covered a distance of 50 ft. at an elevation of 100