



OKLAHOMA DEPARTMENT OF TRANSPORTATION
SURVEY DIVISION

FLOOD INFORMATION FORM

Division #:	1 <input type="checkbox"/> 2 <input checked="" type="checkbox"/> 3 <input type="checkbox"/> 4 <input type="checkbox"/> 5 <input type="checkbox"/> 6 <input type="checkbox"/> 7 <input type="checkbox"/> 8 <input type="checkbox"/>
County:	Marshall
Date Highwater occurred:	05/12/2015
Highway Number:	SH 70F
Name of Stream:	
Direction and distance from nearest town, or highway junction	From the intersection of US 70 and SH 70F go South Approx. 0.6 Mi.
Section, Township, Range:	Sec10, T-6-S,R-5-E
Description of Location:	Cross Drain Sta. 12+627.6 (metric) from plans SAP48(184)
Highwater Elevation:	810.05'
Level Datum & Source:	NAVD91 SAP48(184)
Method used:	Differential Leveling
Date Elevation Obtained:	05/13/2015
Apparent Magnitude:	Normal <input type="checkbox"/> Medium <input checked="" type="checkbox"/> Extreme <input type="checkbox"/> Don't Know <input type="checkbox"/>
Was Highwater Mark obtained from actual water, drift, local resident, or other source?	Drift
Explanatory Remarks:	

Note: Show Vicinity Map on back of form

Name (signature) _____
Name (Printed) Robert Uhles
Date: 6/15/2015

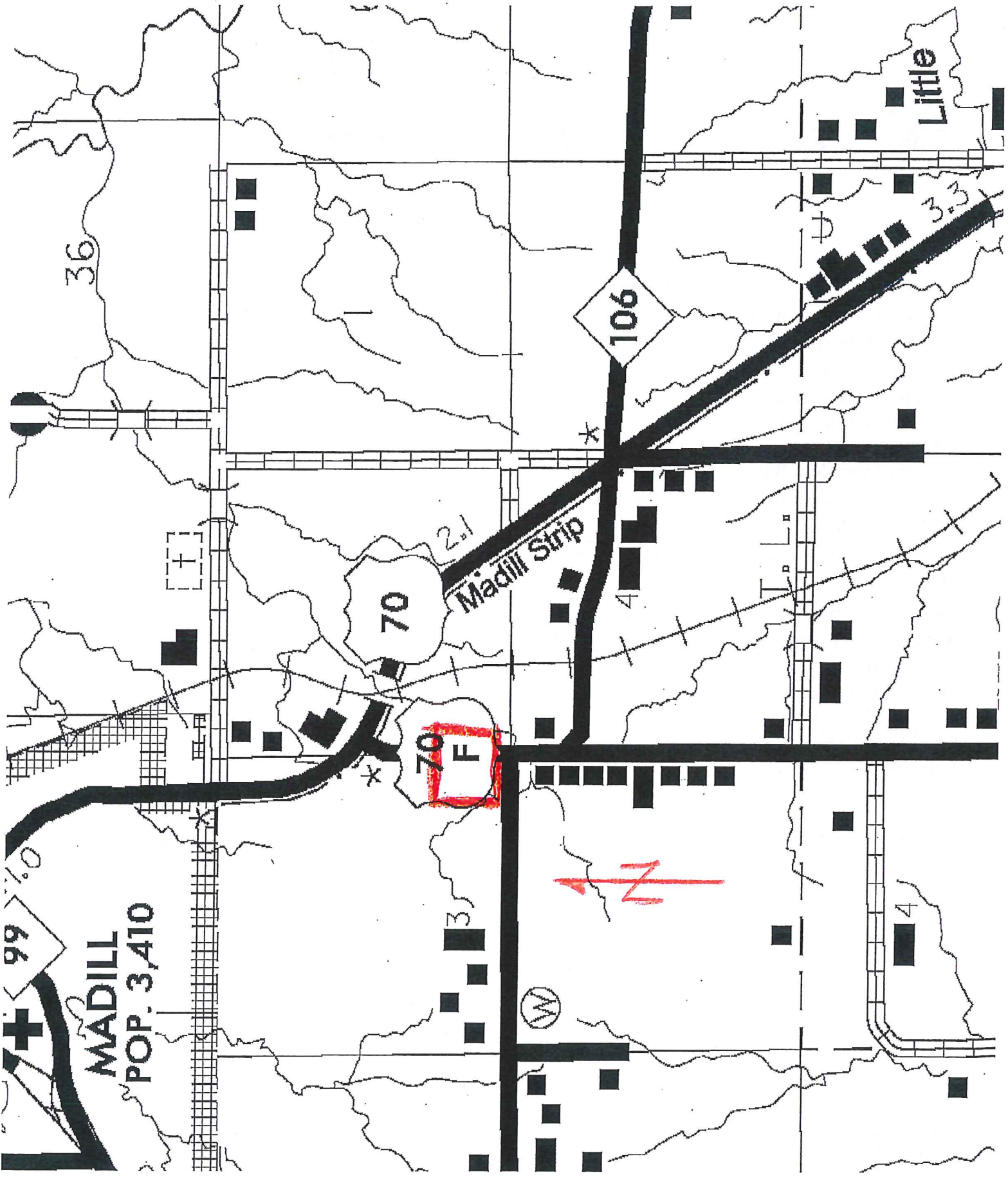

MADILL
POP. 3,410

Little

106

70

70 F

99

36

3.3

2.1

W

N

4

3

4

4