

STATE OF OKLAHOMA
DEPARTMENT OF HIGHWAYS
SURVEY DIVISION

Survey Division
Form No. 16
Rev. Sept. 10, 1961

FLOOD INFORMATION FORM

To be used in obtaining and transmitting flood water elevations for Survey Division office record files. This information to be obtained by all Chiefs of Party or others in their vicinity in times of unusual high water, or at any time available from a reliable source. The elevations can be recorded by level reading, by measurement from bridge floor, in relation to a house, above roadbed or any other dependable, clear manner that fits the situation, the highest order possible to be used. Separate report to be made on each crossing or place obtained.

County Major Date highwater occurred 11-3-74

Highway number Sh 15 & US 60 Name of stream Near Elm Creek

Direction and distance from nearest town, village or store At Orienta, Okla. at the Post Office, Service Station & Grocery store combination.

Section, Township and Range Sec 27 T22N R12W

Description of Location Shots were taken from SWO 3188(1) bench mark at sta. 2292/95 and water marks inside post office in Orienta.

Elevation 1244.8 Source of levels USC&GS

Method obtained Fennel Level & Rod Date obtained 11-4-74

Did it appear to be normal medium extreme do not know

Was highwater mark obtained from actual water, drift, local resident, U. S. Engineers, etc.? Highwater was taken from water marks in building inside & outside and verified by Herbert Nickel who owns the store.

Explanatory Remarks Obtained on 11-4-74 by M.D. Wolf & J.D. Berry Jr. . The water also got in the service station gas tanks. Mr Nickel said that the water was about 4" higher in 1957 Highwater.

Location to be shown on back of this sheet as a check.

Field Note: To be sent to
Survey Engineer

Mene Pravat
~~CHIEF OF PARTY~~
Location Engineer

11-4-74

Date

Location No. 5

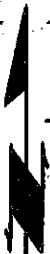
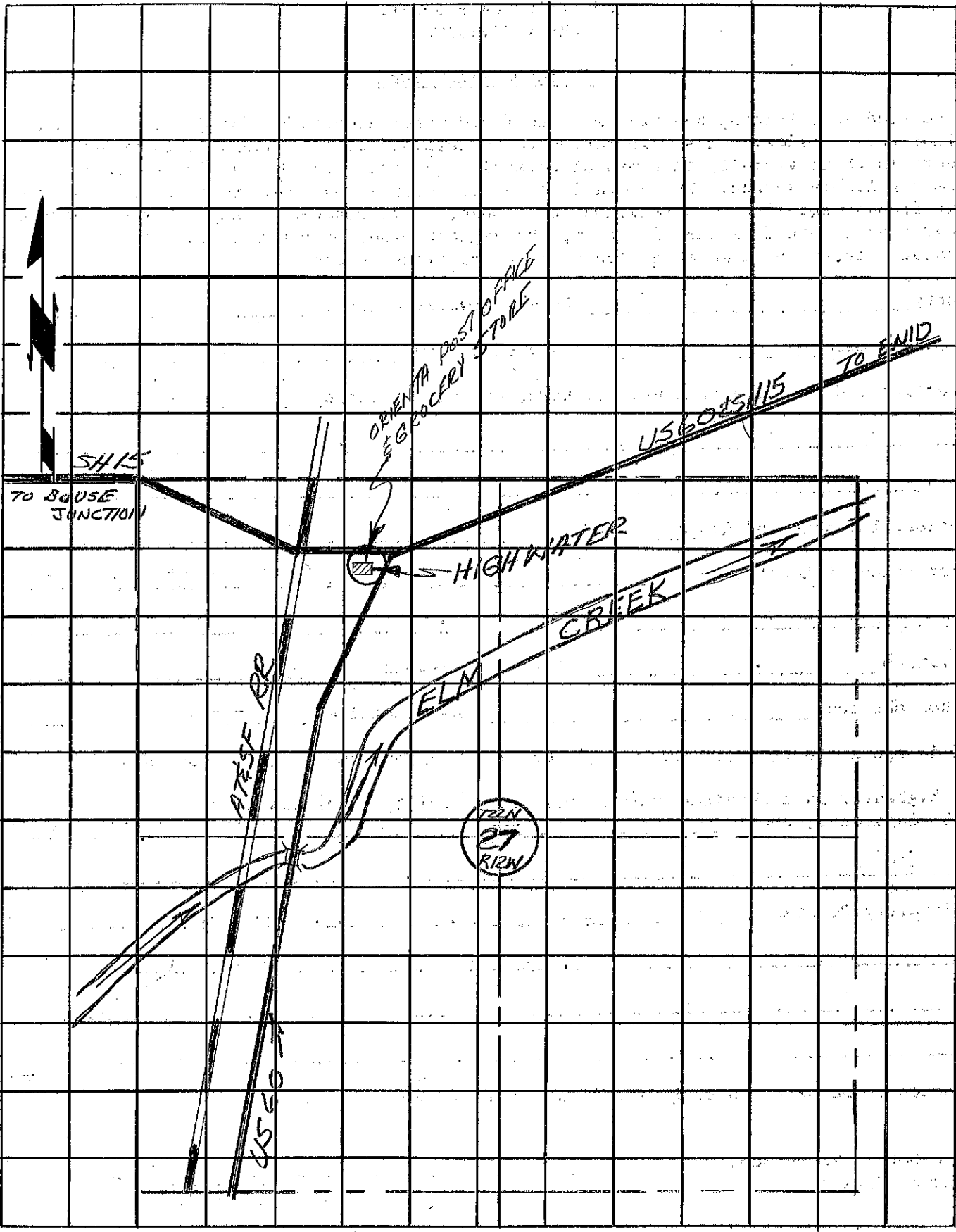

SH 15

TO BOUSE JUNCTION

ORIENTA POST OFFICE
GROCERY STORE

HIGH WATER

ELM CREEK

PT&SF RR

US 60

US 60 & SH 15

TO ENID

T22N
27
R27W